



# Electrolux

## SERVICE MANUAL

### Well-being

## Air Purify Pure A9.2



#### Model name

EP71-56WBA

EP71-56BLA

EP71-56GRA

EP71-56GYA

EP71-76WBA

EP71-76BLA

EP71-76GRA

EP71-76GYA

FOR INTERNAL AND PARTNERS USE ONLY

© ELECTROLUX BA APAC&MEA  
TECHNICAL DOCUMENTATION  
ELECTROLUX THAILAND  
1910 ELECTROLUX BUILDING  
NEW PETCHBURI RD BANGKAPI, HUAI KHWANG  
BANGKOK, 10310

EN  
Publication number  
**599856306**  
Edition: 12/2021 - Rev. 00

## Contents

1. PURPOSE OF THIS MANUAL	3
2. IMPORTANT SAFETY INSTRUCTIONS	3
2.1 Children and Vulnerable People Safety	3
2.2 Electrical Information	3
2.3 Safety Precautions	4
2.4 DISPOSAL	4
3. PRODUCT OVERVIEW	5
3.1 Description of Air Purifier Pure A9.2	5
3.2 Operation Instructions	7
4. TROUBLESHOOTING	19
4.1 Error Messages	20
5. ELECTRIC WIRING DIAGRAM	22
5.1 PURE A9-40 (Without LCD)	22
5.2 PURE A9-40, A9.2-56 (With LCD)	22
5.3 PURE A9-60 (Without LCD)	23
5.4 PURE A9-60, A9.2-76 (With LCD)	23
6. SPECIFICATION	24
6.1 Taiwan Market	24
6.2 Japan Market	26
7. MAINTRNANCE INSTRUCTION	27
7.1 Change the control PCB (without LCD)	27
7.2 Change the control PCB (with LCD)	27
7.3 Change the touch panel (without LCD)	28
7.4 Change LCD	29
7.5 Change the sensor intake	29
7.6 Change filter door or decorative strip	30
7.7 Change filter and RFID label	30
7.8 Change the wheels	31
7.9 Change the base	31
7.10 Change the sensor PCB	32
7.11 Change the Power PCB/ Motor/ ionizer	32
7.12 Change the PM 2.5 sensor	34
7.13 Change the air outlet/shell (Fabric wrapping)	35
7.14 Change the handle screws or PU handle	35
7.15 Change the rubber feet (EU)	36
7.16 Change the microswitch	36

# 1. PURPOSE OF THIS MANUAL

The purpose of this Service Manual is to provide Service Engineers who are already familiar with the repair procedures with information regarding : **Appliances**

fitted with **NIU** electronic control systems.

The manual deals with the following topics:

- o General characteristics
- o Control panel
- o Guide to diagnostics
- o Technical and functional characteristics
- o Access

Document Revisions

Rev.	Date	Description	Author
00	12/2021	Document creation	Kotchaporn Phaosri

# 2. IMPORTANT SAFETY INSTRUCTIONS

This USER MANUAL provides specific operating instructions for your model. Use the unit only as instructed in this USER MANUAL. These instructions are not meant to cover every possible condition and situation that may occur. Common sense and caution must be practiced when installing, operating, and maintaining any appliance.

**WARNING!** Avoid fire hazard or electric shock. Do not use an extension cord or an adaptor plug. Do not remove any prong from the power cord.

- This appliance can be used in 50Hz or 60Hz power supply without any change. Do not, under any circumstances, cut, remove or bypass the grounding prong.
- Do not store or use gasoline or other flammable vapors and liquids in the vicinity of this or any other appliance. Read product labels for flammability and other warnings.
- Do not let water or any other liquid or flammable detergent enter the appliance to avoid electric shock and/or a fire hazard.
- Do not touch the fan blade when removing the filter.

## 2.1 Children and Vulnerable People Safety

**WARNING!** Risk of suffocation, injury or permanent disability. This appliance is not intended for use by persons (including children) with reduced physical, sensory or mental capabilities, or lack of experience and knowledge, unless they are under supervision or have been given instruction concerning use of the appliance by a person responsible for their safety.

- Children should be supervised to ensure that they do not play with the appliance.
- Cleaning and product maintenance shall not be made by children without supervision.
- Children of less than 3 years should be kept away unless continuously supervised.
- Keep all packaging away from children. If the appliance has a child safety mode, we recommend you activate it.

## 2.2 Electrical Information

**WARNING!** Avoid fire hazard or electric shock. If you are not sure the outlet is adequately grounded or protected by a time delay fuse or circuit breaker, have a qualified electrician install the proper outlet according to the National Electrical Code and applicable local codes and ordinances.

- Do not use an extension cord or an adapter plug.
- Never unplug the unit by pulling on the power cord. Always grip the plug firmly and pull straight out from the receptacle.
- Do not pinch, bend, or knot the power cord.
- Do not cut or damage the power cord. If the power cord is damaged, it should only be replaced by an authorized Electrolux servicer. This unit contains no user-serviceable parts. Always call an authorized Electrolux servicer for repairs.
- Be sure to unplug the unit before cleaning to prevent shock or fire hazards.

## 2.3 Safety Precautions

**CAUTION!** Avoid Serious Injury or Death.

- Do not insert or place fingers or objects into the air discharge area or front grille of the unit.
- Do not start or stop the unit by unplugging the power cord or turning off the power at the electrical box.
- In the event of a malfunction (sparks, burning smell, etc.), immediately stop the operation, disconnect the power cord, and call an authorized Electrolux servicer. Do not operate the unit with wet hands.

**CAUTION!** Avoid Injury or damage to the unit or other property.

- Do not direct airflow at fireplaces or other heat related sources as this could cause flare ups.
- Do not climb on or place objects on the unit.
- Do not hang objects off the unit. Do not place containers with liquids on the unit.
- Turn off the unit at the power source when it will not be used for an extended period of time. Operate the unit with air filter in place.
- Do not block or cover the intake grille, discharge area and outlet ports. Ensure that any electrical/ electronic equipment is 30cm. away from the unit.

## 2.4 DISPOSAL



This symbol on the product indicates that this product contains a battery which shall not be disposed with normal household waste.



This symbol on the product or on its packaging indicates that the product may not be treated as household waste.

To recycle your product, please take it to an official collection point or to an Electrolux service center that can remove and recycle the battery and electric parts in a safe and professional way. Follow your country's rules for the separate collection of electrical products and rechargeable batteries.

### 3. PRODUCT OVERVIEW

#### 3.1 Description of Air Purifier Pure A9.2

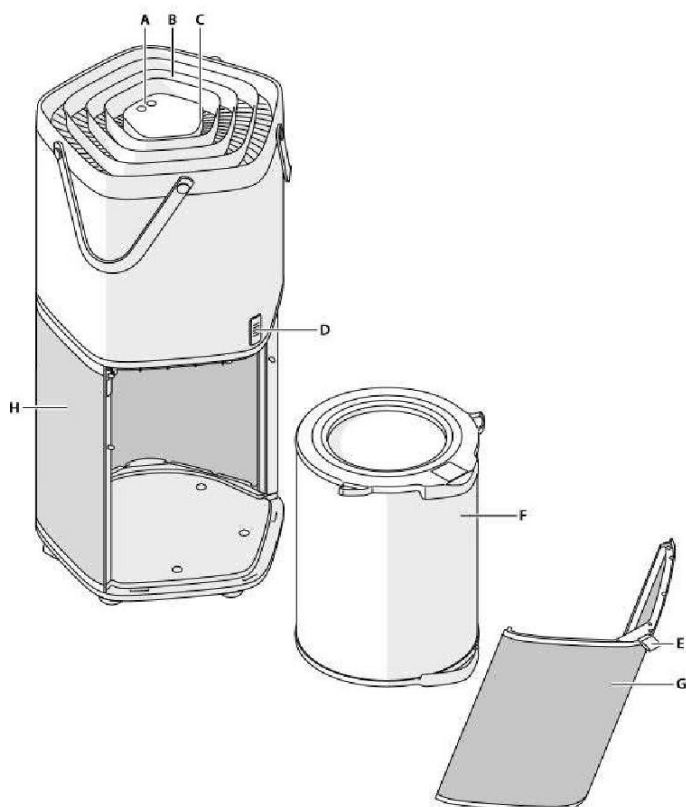

- A. Controlpanel
- B. Air outlet
- C. Air quality light
- D. Air quality sensor
- E. Fabrichandle
- F. Multi-layerfilter
- G. Air intake cover
- H. Airintake

#### Control Panel (EU Version)

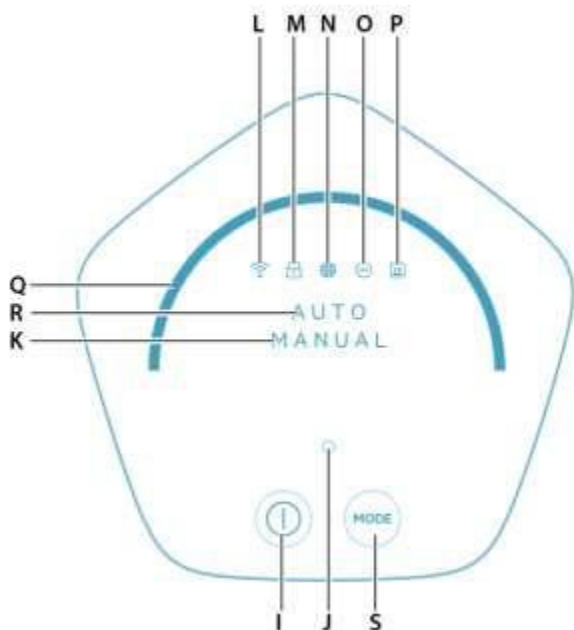

- I. On/Offbutton
- J. LoadingLED
- K. Manual modeindicator
- L. WiFiindicator
- M. Child lockindicator
- N. Filter changeindicator
- O. Ionizerindicator
- P. Schedulerindicator
- Q. Fan speedslider  
(only shown in manual mode)
- R. Auto mode indicator
- S. S. Mode button

Control Panel & Remote Control (K Version)

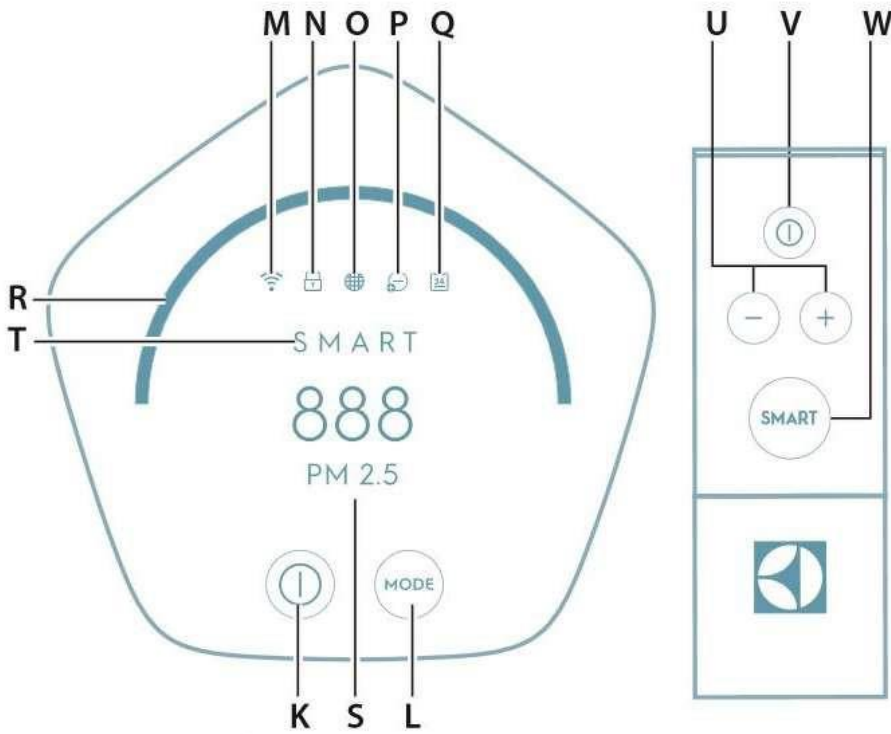

- K. On-offbutton
  - L. Modebutton
  - M. WiFiindicator
  - N. Child lockindicator
  - O. Filter changeindicator
  - P. Ionizerindicator
  - Q. Schedulerindicator
  - R. Fan speedslider
  - S. DisplayScreen
  - T. Modeindicator
- REMOTE CONTROL:
- U. Increase/Decrease Fan Speed
  - V. ON/OFF
  - W. SMARTMode

Control Panel & Remote Control (TW, JPA Version)

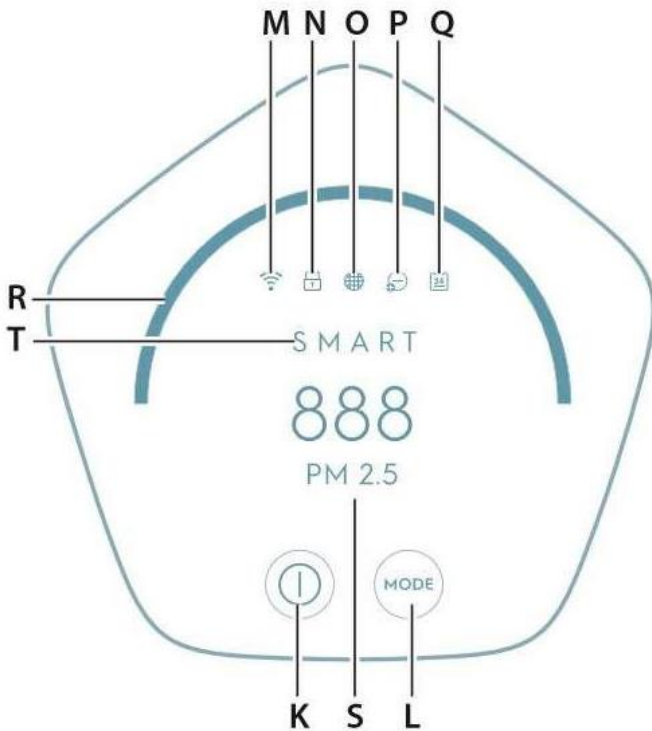

- K. On-offbutton
- L. Modebutton
- M. WiFiindicator
- N. Child lockindicator
- O. Filter changeindicator
- P. Ionizerindicator
- Q. Schedulerindicator
- R. Fan speedslider
- S. DisplayScreen
- T. Modeindicator

## 3.2 Operation Instructions

### 3.2.1 HOW TO SELECT A LOCATION

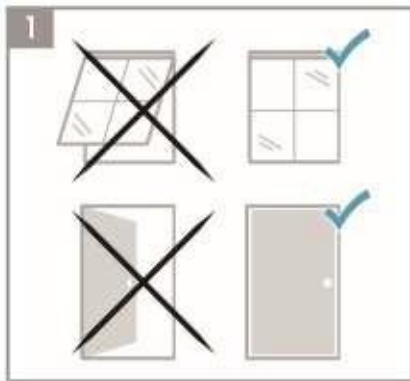

For best result, operate the air purifier in an enclosed area. Close all doors, windows, and other outside openings to the room.

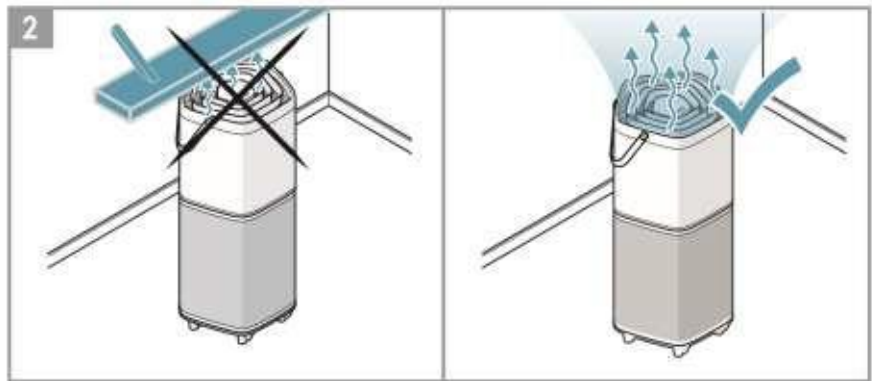

Place an air purifier in a location that does not restrict airflow through the top of the appliance.

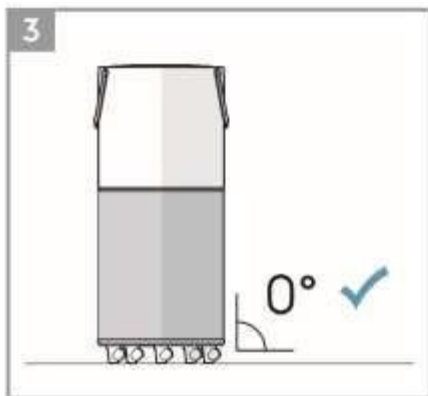

The appliance must be placed on a level floor that will support it.

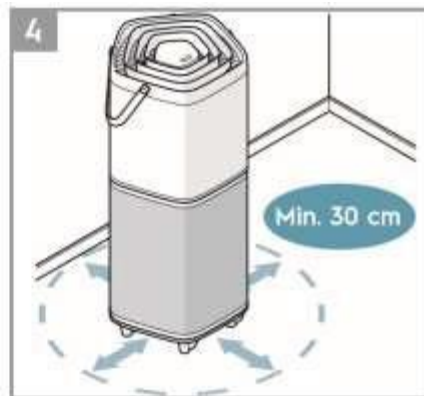

There should be a minimum of 30cm clearance around the appliance.

### 3.2.2 MODE OPERATION INSTRUCTIONS

KR, TW, JPA VERSION

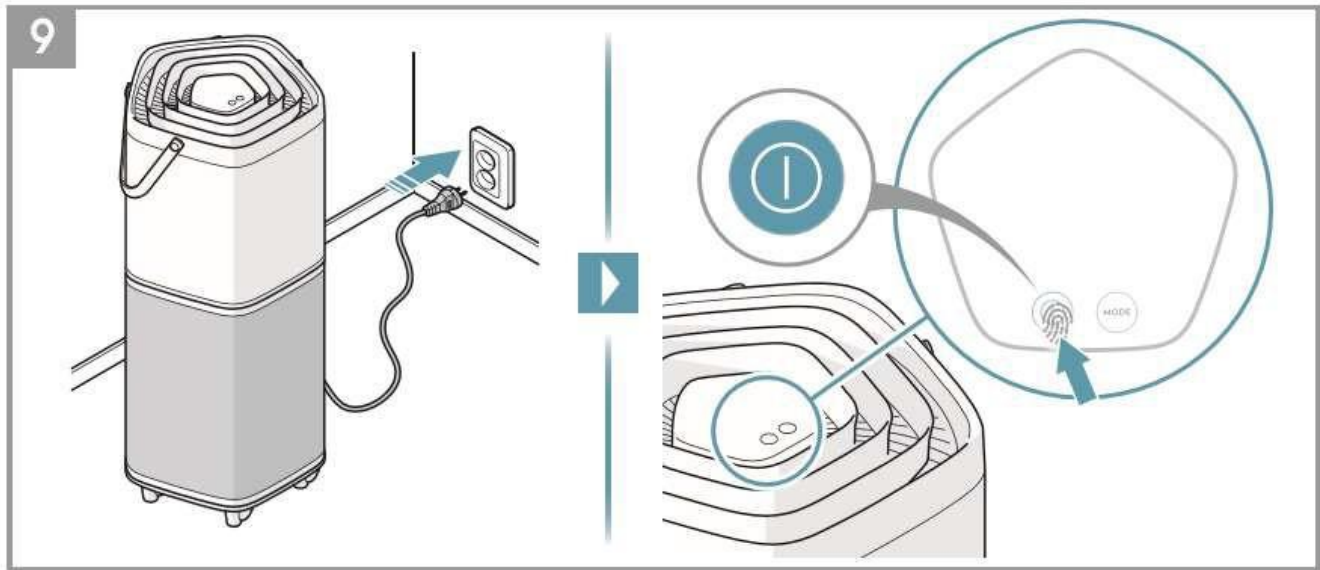

Plug in the appliance and touch the on/off button, to turn on the appliance. It will take about 10 seconds for the appliance to run in low fan speed and the 'display' will show "Waiting for sensor input". The appliance will turn to "SMART" mode, as it is the default setting.

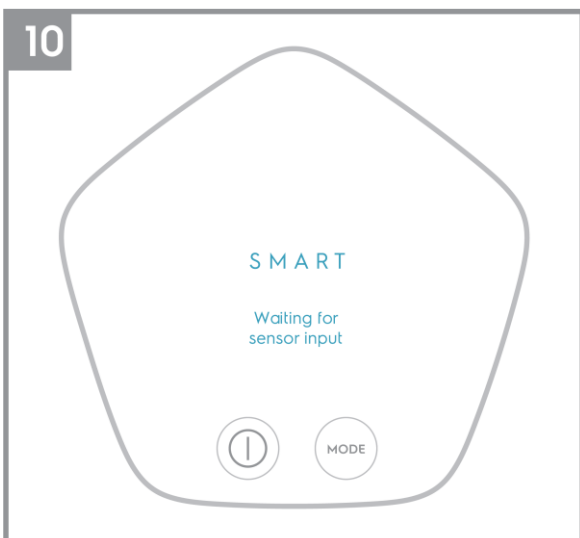

#### SMART MODE

Each time the appliance is turned on it will turn to "SMART" mode as it is the default setting. In this mode, the appliance will choose the fan speed automatically, based on the air quality.

**NOTE:** In "SMART" mode, fan speed can not be changed manually.





The appliance has an air quality sensor that analyzes the air quality. The air quality light will show the real-time air light, as shown below :

LIGHT'S COLOR	PM 2.5 VALUE	AIR QUALITY
Blue	0-15	Good
Green	16-35	Average
Orange	36-75	Poor
Red	Above 75	Very Poor

**NOTE :** It will take about 10 seconds for the sensor to analyze the air quality each time the appliance is turned on. During this time, the air quality light will pulsate slowly in white.

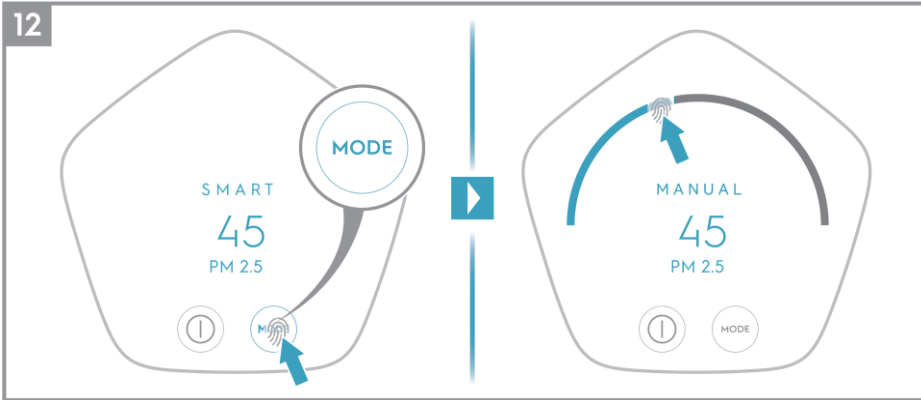

#### MANUAL MODE

Touch the “MODE” button, to switch the appliance to “MANUAL” mode. In this mode, the fan speed can be changed manually by touching the fan speed slider.

**NOTE:** Fan speed will change gradually.

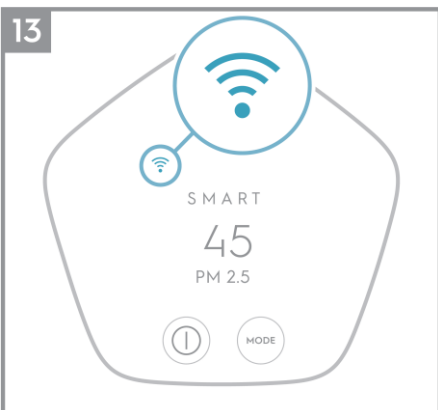

#### WIFI FUNCTION

This appliance is equipped with a WiFi module, which enables the appliance to connect to the internet through a wireless router. Refer to our quick start guide or download the “Wellbeing APP” (smart phone application) for instructions on how to connect the appliance to the home internet. When the appliance is connected to the internet, the WiFi indicator will light up.

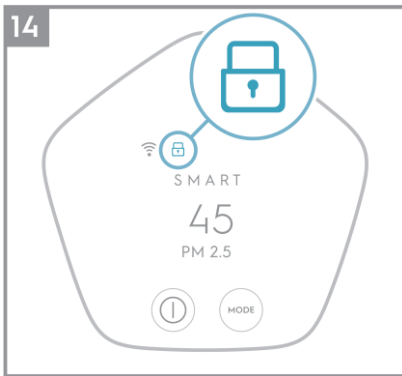

#### CHILD LOCK FUNCTION

The child lock function can only be activated or deactivated by using the Pure A9 APP (smart phone application), when the appliance is connected to the internet. When the child lock function is activated, the child lock indicator will light up and the appliance setting can not be changed by using the control panel on the appliance.

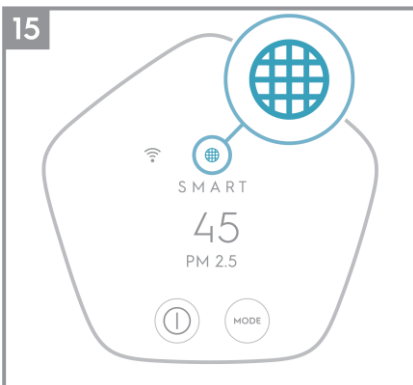

#### FILTER CHANGE INDICATOR

The filter change indicator will light up to remind you to change the filter. Before to the instructions in the **“Wellbeing APP”** or the Electrolux website on where to purchase replacement filters. Ensure the plastic protective bag is removed from the replacement filter before use. After filter is replaced, the filter indicator will extinguish automatically.

**Note:** The multi-layer filter can not be washed, it can only be replaced.

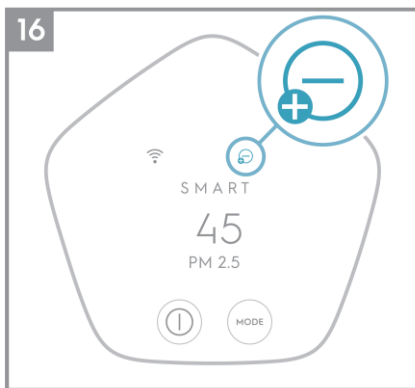

#### IONIZER INDICATOR FUNCTION

The ions function can only be activated and deactivated by using the **“Wellbeing APP”** (smart phone application). When this function is activated the ions indicator will light up. In this function, the appliance generates ions to improve the room air quality.

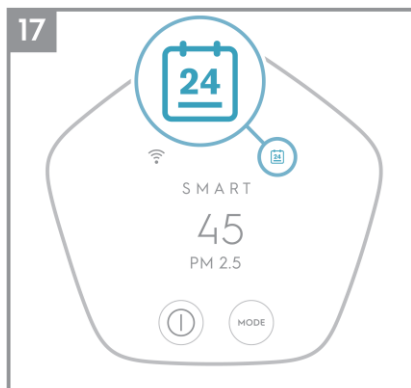

#### SCHEDULE FUNCTION

In the **“Wellbeing APP”** (smart phone application) you can set different schedules, for example that the fan speed goes down during night time and then goes back to normal speed during day time. When a schedule is set, the schedule indicator on the appliance will light up.

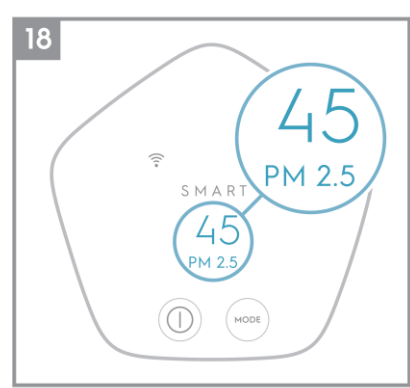

#### DISPLAY SCREEN

The air quality indicator can show actual room air quality measured by different type of pollution source. PM 2.5, PM 10, TVOC, PM 1.0 will show on the screen in a loop.

## EU VERSION

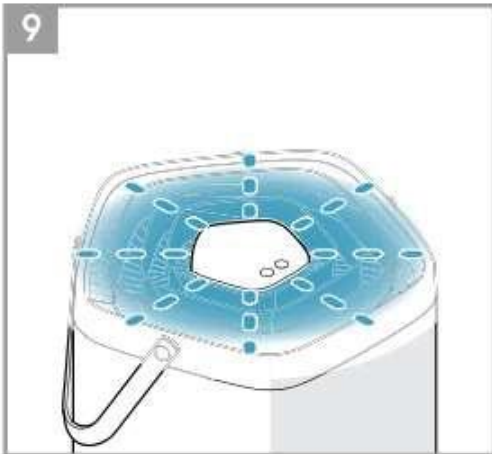

The appliance has an air quality sensor that analyzes the air quality. The air quality light will show the real-time air quality visually by emitting different colors of light.

LIGHT'S COLOR	AIR QUALITY
Green	Very Good
Yellow	Good
Orange	Poor
Red	Very Poor
Purple	Bad
Maroon	Very Bad

**NOTE:** It will take about 10 seconds for the sensor to analyze the air quality each time the appliance is turned on. During this time, the air quality light will pulsate slowly in white.

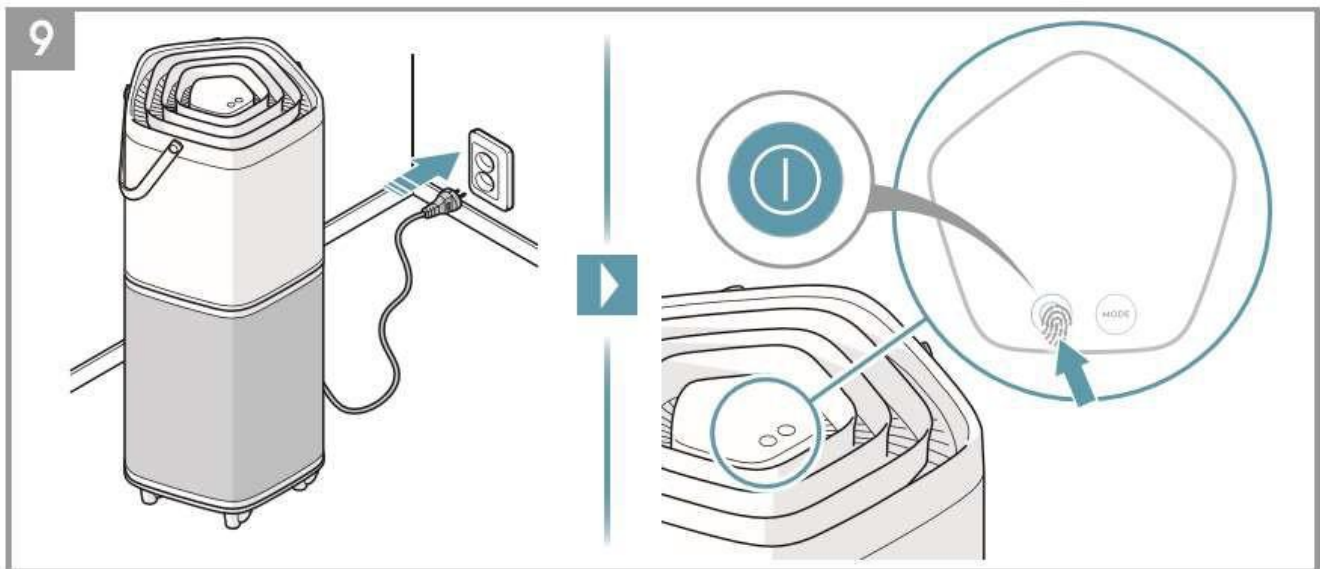

Plug in the appliance and touch the on/off button, to turn on the appliance. It will take about 10 seconds for the appliance to start, during this time it will run in low fan speed and the loading LED will pulsate. The appliance will turn to "AUTO" mode, as it is the default setting.

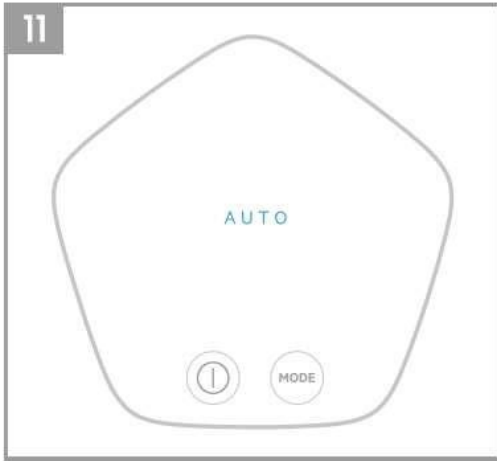

### AUTO MODE

Each time the appliance is turned on it will turn to "AUTO" mode as it is the default setting. In this mode, the appliance will choose the fan speed automatically, based on the air quality.

**NOTE:** In "AUTO" mode, fan speed can not be changed manually.

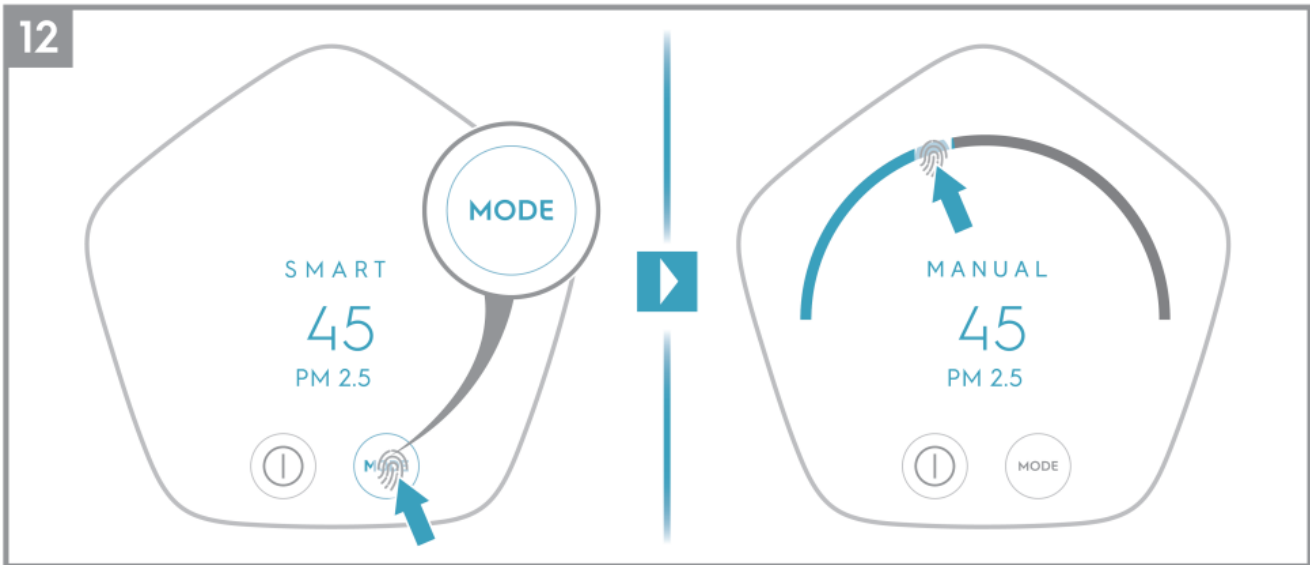

### MANUAL MODE

Touch the "MODE" button, to switch the appliance to "MANUAL" mode. In this mode, the fan speed can be changed manually by touching the fan speed slider.

**NOTE:** Fan speed will change gradually, after you selected a new fan speed.

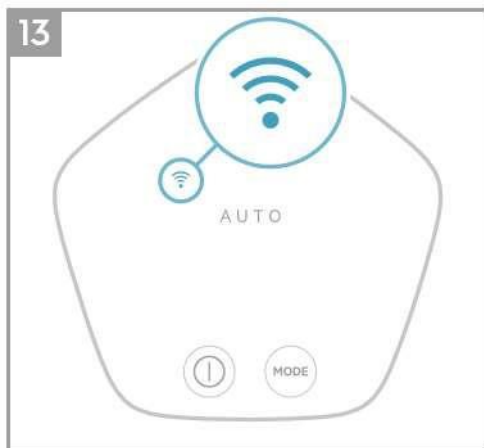

### WIFI FUNCTION

This appliance is equipped with a WiFi module, which enables the appliance to connect to the internet through a wireless router.

Refer to our quick start guide or download our "Wellbeing APP" (smart phone application) for how to connect the appliance to the internet and more details. When the appliance is connected to the internet, the WiFi indicator will light up.

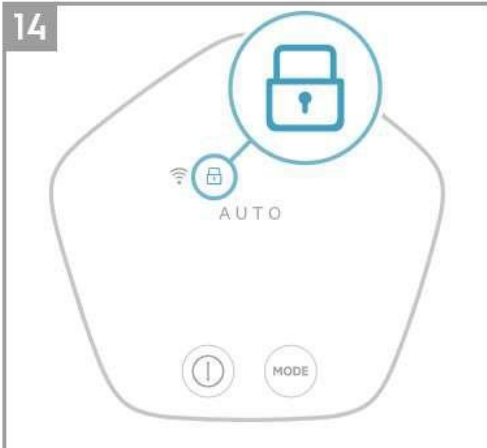

#### CHILD LOCK FUNCTION

The child lock function can only be activated or deactivated by using the **“Wellbeing APP”** (smart phone application), when the appliance is connected to the internet. When the child lock function is activated, the child lock indicator will light up and the appliance setting can not be changed by using the control panel on the appliance.

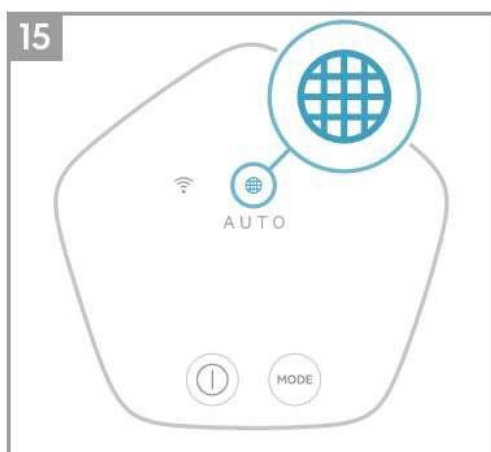

#### FILTER CHANGE INDICATOR

The filter change indicator will light up to remind you to change the filter. Refer to “Removing the plastic protective bag from the multi-layer filter” to change the filter. After the filter is replaced, the filter change indicator will extinguish automatically.

**NOTE:** The multi-layer filter can not be washed, it can only be replaced.

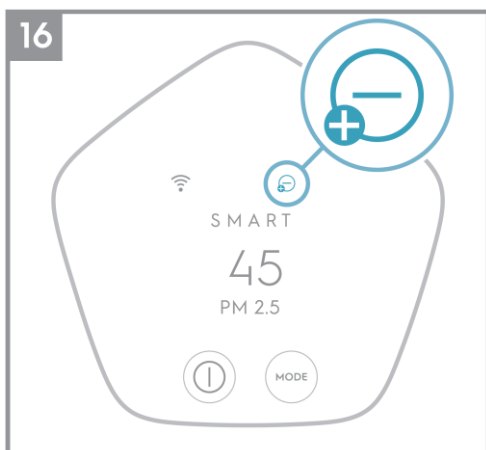

#### IONIZER INDICATOR FUNCTION

The ionizer function can only be activated and deactivated by using the **“Wellbeing APP”** (smart phone application). When this function is activated the ionizer indicator will light up. In this function, the appliance generate ions to improve the room air quality.

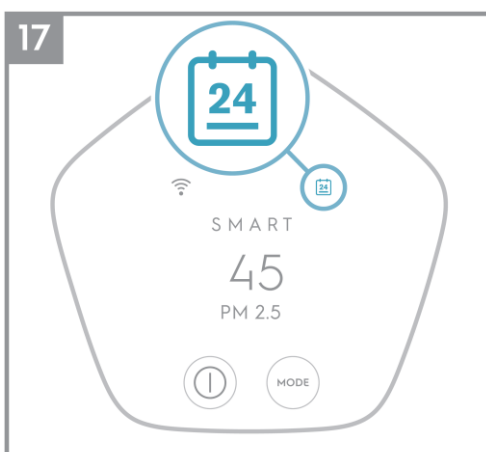

#### SCHEDULE FUNCTION

In the **“Wellbeing APP”** (smart phone application) you can set different schedules, for example that the fan speed goes down during night time and then goes back to normal speed during day time. When a schedule is set, the schedule indicator on the appliance will light up.

### 3.2.3 HOW TO REPLACE THE FILTER

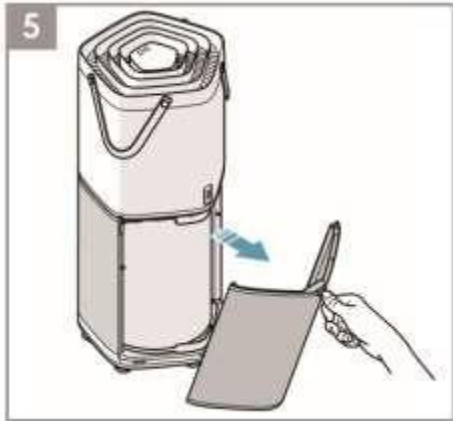

Pull the fabric handle outward to take out the back air intake cover.

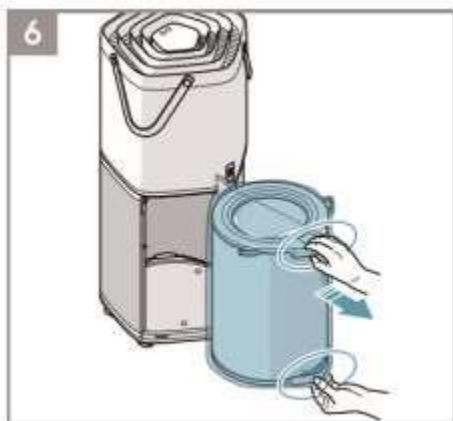

Grab the multi-layer filter from the top by the handles and carefully pull it out.



Remove the plastic protective bag from the multi-layer filter.



Reinsert the multi-layer filter.

### 3.2.4 HOW TO USE THE REMOTE CONTROL

#### ON/OFF BUTTON

Press the ON/OFF button to turn the unit ON or OFF

#### FAN SPEED BUTTON

Press the “-” button to slow down the fan speed. Press the “+” button to increase the fan speed. NOTE: The appliance will change to manual mode automatically when either of the fan speed buttons are pressed.

NOTE: The appliance will change to manual mode automatically when either of the fan speed buttons are pressed.

#### AUTO BUTTON

Press this button to switch the unit from manual mode to auto mode.

### 3.2.5 HOW TO REPLACE THE REMOTE CONTROL BATTERY

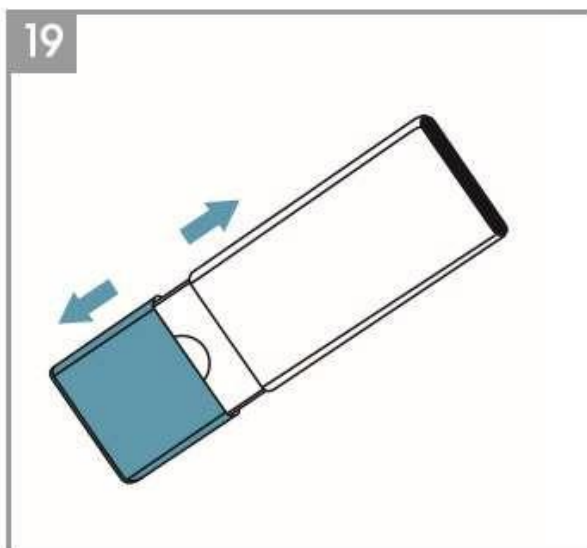

Push the back cover down to open the battery cabinet. Replace the old battery with a new CR2032 type battery. Reinstall the back cover.

#### CAUTION

- Be sure the batteries are inserted properly.
- Do not use batteries other than the type specified.
- Do not dispose of batteries in fire. Batteries may explode or leak.
- Do not swallow.
- Keep the batteries away from children.

### 3.2.6 CARE AND CLEANINGS

#### Cleaning the appliance

Unplug the appliance before cleaning to prevent shock or fire hazards.

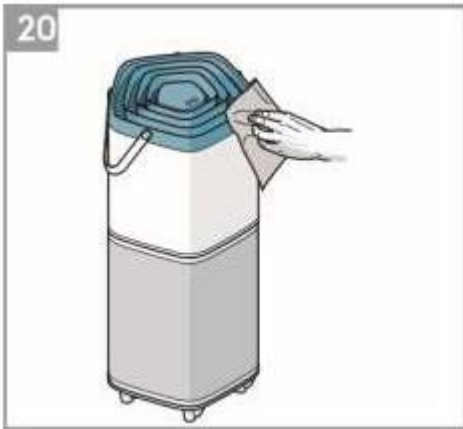

The plastic part of the cabinet and top may be cleaned with an oil-free cloth or washed with a cloth dampened in a solution of warm water and mild liquid dishwashing detergent. Be sure to wring excess water from the cloth before wiping around the controls. Excess water in or around the controls may cause damage to the appliance.

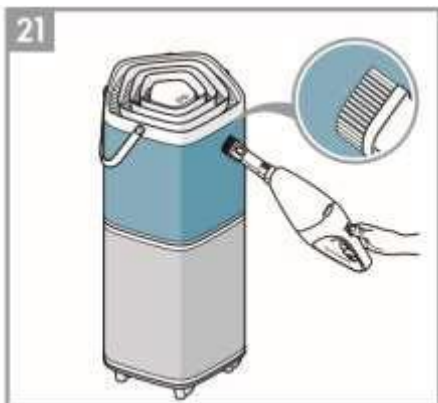

The fabric on the cabinet cannot be removed. Clean the fabric by using a vacuum cleaner with soft brush.

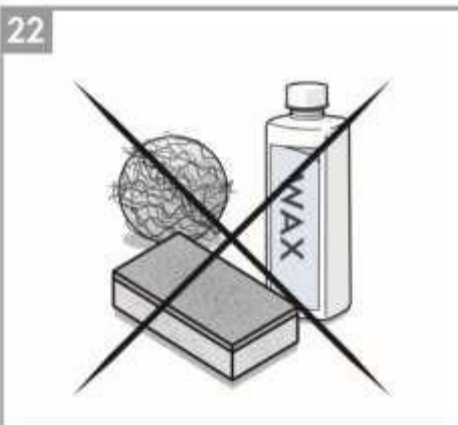

Never use harsh cleaners, wax or polish when cleaning the unit.





**NOTE:** The multi-layer filter cannot be washed, it can only be replaced.

**CAUTION!** Do not touch the fan blade when removing the multi-layer filter.

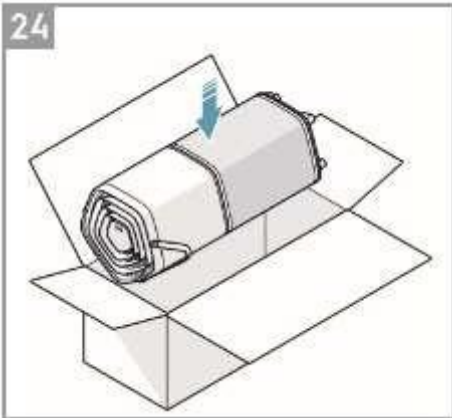

If you are not planning to use the appliance for a long time, cover it with plastic or return it to its carton.

## 4. TROUBLESHOOTING

PROBLEM	SOLUTION AND TIPS
Air purifier does not operate.	<ul style="list-style-type: none"> <li>• Ensure that the wall plug is connected - push the plug firmly into the wall socket and then retry operating the purifier.</li> <li>• Examine if the house fuse is blown or the circuit breaker has tripped and if so, please replace the fuse with time delay type or reset the circuit breaker before trying to operate the purifier again.</li> </ul>
Air quality does not improve.	<ul style="list-style-type: none"> <li>• Ensure any open doors, windows of the room are closed and then check the air quality measurements after some minutes for improvement.</li> <li>• Ensure that the filter indicator light is NOT on and if it is then for optimal results please replace the filter before reuse of the product.</li> </ul>

PROBLEM	SOLUTION AND TIPS
Fan does not operate.	<ul style="list-style-type: none"> <li>• Ensure that the back air intake cover is closed properly, and the filter is installed correctly then retry using the purifier.</li> </ul>
Fan speed does not change after selecting new fan speed	<ul style="list-style-type: none"> <li>• The fan speed will decrease or increase gradually, this is normal. If it does not change after prolonged period of input then please reach out to an Electrolux authorised servicer for support.</li> </ul>
The appliance is very loud.	<ul style="list-style-type: none"> <li>• Ensure that there are no obstacles near the purifier and adequate space around it for it to operate optimally.</li> <li>• Ensure that the air intake grill and the air outlet grill are not fully/partially covered, please unblock if so and retry using the purifier.</li> <li>• Ensure the filter plastic cover bag has been removed prior to first use of the purifier.</li> </ul>
Filter is dirty but the change filter indicator is not illuminated yet.	<ul style="list-style-type: none"> <li>• If you see the filter is dirtier than normal and the unit is not operating optimally (i.e. air quality does not improve), then please call an Electrolux authorized servicer for support on the topic or for buying a replacement filter.</li> </ul>
The appliance produces a strange smell.	<ul style="list-style-type: none"> <li>• The first time you use the purifier, it may produce a smell of plastic or color - this is normal but should disappear quickly. If the smell persists or you sense a burning smell please disconnect the purifier and reach out to a Electrolux authorized servicer for support on the topic.</li> </ul>
For any further problems, contact an authorized Electrolux service centre.	

## 4.1 Error Messages

1. PM 2.5 Sensor failure
2. TVOC failure
3. Temperature/Humidity failure
4. Fan Motor Stall or Fan motor lost speed
5. Communication error between Sensor board and display board.
6. Filter Door Open
7. RFID label invalid

### 4.1.1 ERROR MESSAGE 1

Since auto is for now based on PM2.5 value this error is quite important even for no LCD version because it affects the light ring - therefore this message should indicate error on the appliance. See example refer to below.

### 4.1.2 ERROR MESSAGE 2-3

Depending on which values are chosen to be shown on the appliance the error is shown or not. For example: if the user has not chosen to show temperature or humidity in the product, error message 3 is not needed to be shown on the appliance. Instead it can be shown in the app (unless it affects the performance of any kind). If user has chosen the value that fails then it is shown in as the example refer to below.

Since no values are shown on the No LCD version, these error messages are not even indicating on the appliance, just in the app. Maybe the user can get a notification so that they go into the app and see it.



### 4.1.3 ERROR MESSAGE 4-7

The fan will be turned off so the fan level arc should be switched off. Error 6 and 7 is “smaller” error messages that has easy solutions so then the action how to fix it can be displayed on the screen. When a “bigger” error such as error 4 or 5 occurs more info is needed so then we should ask users to go to the app to get more information about service and so on. See examples ----->see below

### 4.1.4 EXTRA ABOUT NO LCD VERSION

For the version without LCD we will only use the LED over the buttons. It will blink strongly and hard so that the user see the error message clearly. They then have to go to the app to get info about which error it is.

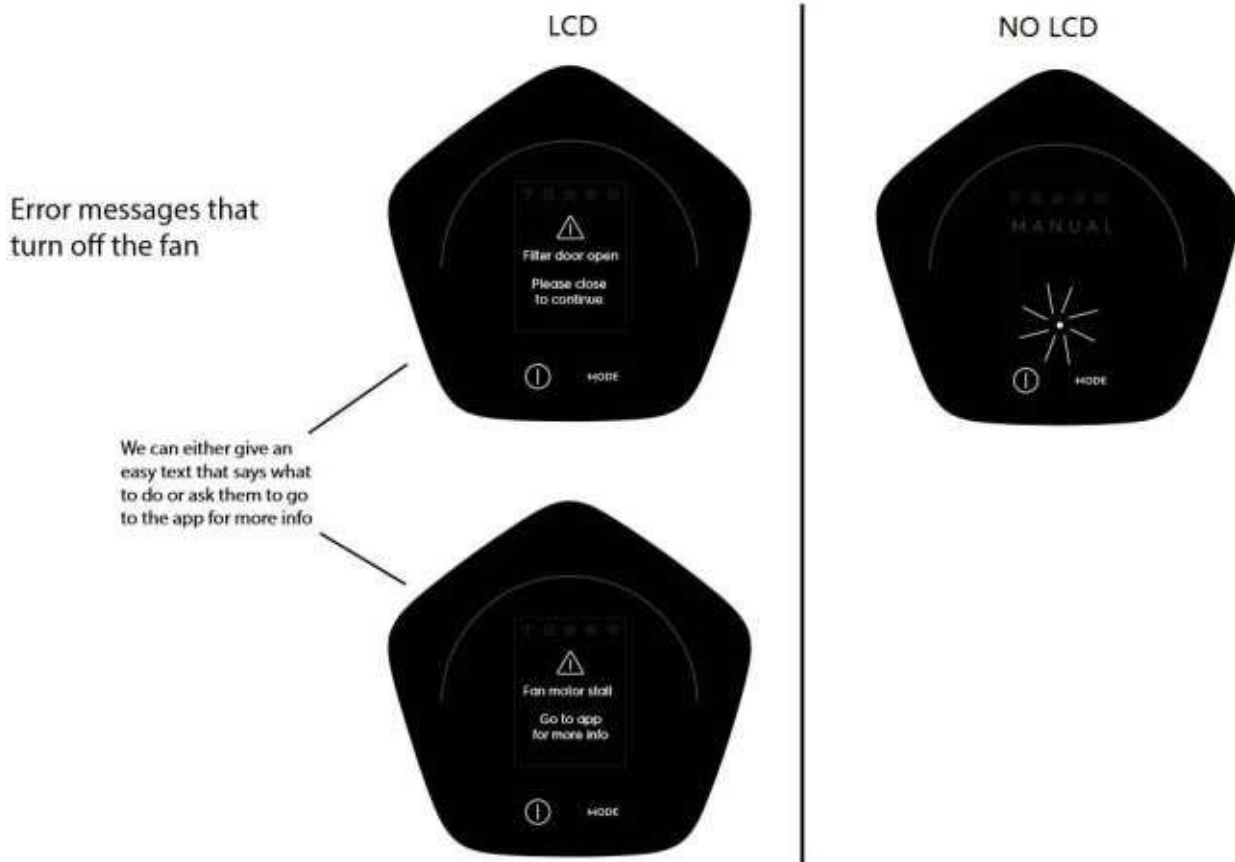

## 5. ELECTRIC WIRING DIAGRAM

### 5.1 PURE A9-40 (Without LCD)

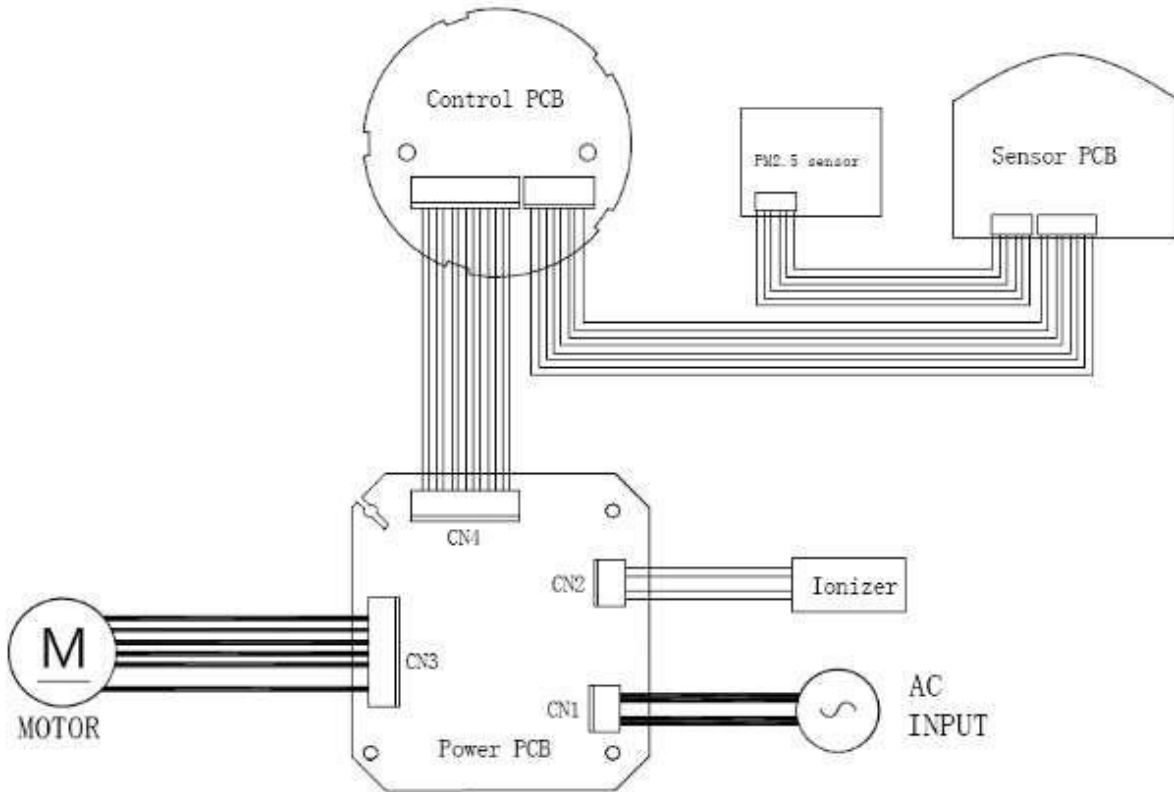

### 5.2 PURE A9-40, A9.2-56 (With LCD)

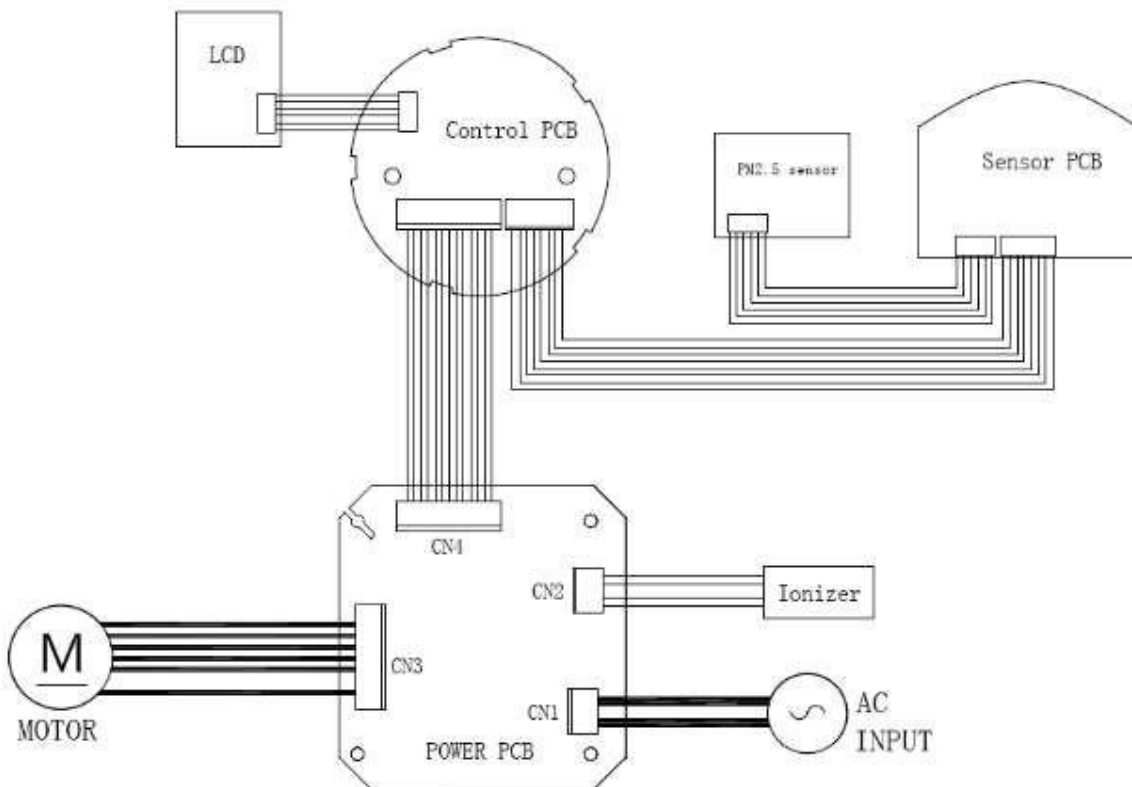

### 5.3 PURE A9-60 (Without LCD)

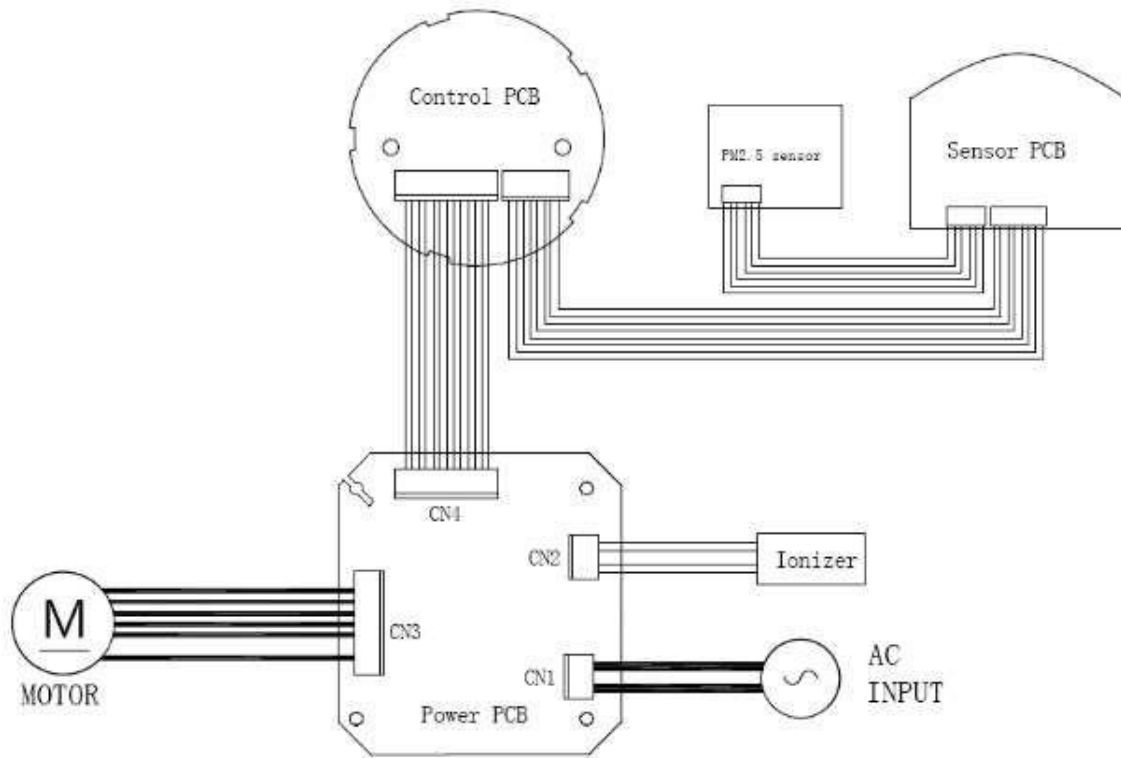

### 5.4 PURE A9-60, A9.2-76 (With LCD)

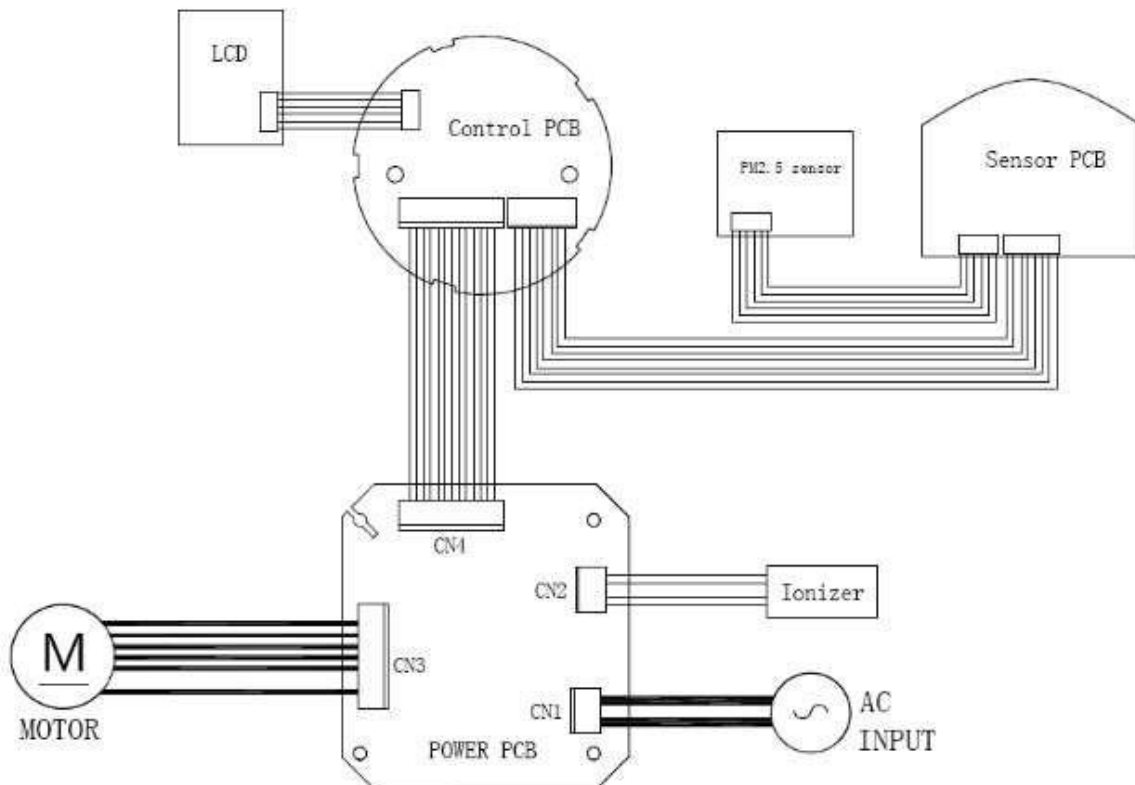

## 6. SPECIFICATION

### 6.1 Taiwan Market

Model name	EP71-56WBA	EP71-56BLA	EP71-56GRA
Platform	PURE A9.2	PURE A9.2	PURE A9.2
PNC	956006689	956006690	956006770
EAN code	7332543833771	7332543833788	7332543837069
Product color	Wanlut Beige	Nordic blue	Ocean Green
Voltage	110V	110V	110V
Frequency	60Hz	60Hz	60Hz
Rated Power Consumption at max level(W)	42	42	42
Power Consumption Range (W)	42±10	42±10	42±10
Power cord length, m	2	2	2
Plug type	US type plug	US type plug	US type plug
Electronic Display	Yes	Yes	Yes
TFT Screen	Yes	Yes	Yes
<b>FUNCTIONAL DESIGN &amp; AESTHETICS</b>			
Main color	Wanlut Beige	Nordic blue	Nordic blue
Textile color	Wanlut Beige	Nordic blue	Nordic blue
Handle	Yes	Yes	Yes
Handle, color	Dark brown	Dark brown	Light brown
Handle, material	Leather imitation	Leather imitation	Leather imitation
Handle, screw	Copper screws	Copper screws	Copper screws
Wheels	Yes	Yes	Yes
User interface	Touch buttons and slider	Touch buttons and slider	Touch buttons and slider
Unit Size, (WxDxH), mm	315*315*590	315*315*590	315*315*590
Net weight, kg	7.9KG	7.9KG	7.9KG
<b>PERFORMANCE</b>			
Max Area Served, m2 (JEM1467, JP)	71	71	71
CADR, Smoke Max (JEM1467), m3/h ( ±10%)	555	555	555
CADR, Smoke Max (GBT), m3/h	470±5%	470±5%	470±5%
CCM Particulate	P4	P4	P4
T/VOC removal Efficiency (3 types, JEM1467)	94%	94%	94%
Formaldehyde removal Efficiency (GBT)	91%	91%	91%
Anti-bacterial Efficiency - Filter Standalone	100%	100%	100%
Particle Removal Efficiency (0.3µm) - Filter Standalone	100%	100%	100%
Fan speeds	9	9	9
Max noise according JEM	51.4	51.4	51.4
Motor type	BLDC	BLDC	BLDC
<b>MODES &amp; FEATURES</b>			
SMART Mode	Yes	Yes	Yes
Manual Mode	Yes	Yes	Yes
IAQ LED/Light Indicator & Colors - App & On Product	Yes.	Yes.	Yes.
Filter Life Indicator - App & On Product	4 - Blue, Green, Orange, Red	4 - Blue, Green, Orange, Red	4 - Blue, Green, Orange, Red
Child Lock Indicator - App & On Product	Yes	Yes	Yes
Ionizer Indicator - App & On Product	Yes	Yes	Yes
WiFi Indicator - App & On Product	Yes	Yes	Yes
*Real-time* IAQ Figures (Values) - App & On Product	Yes	Yes	Yes
*Real-time* OAQ Measurement - App Only	Yes	Yes	Yes
IAQ Historical Measurement - App Only	Yes, Last 12 Hours Only	Yes, Last 12 Hours Only	Yes, Last 12 Hours Only
<b>SENSORS &amp; CONTROL</b>			
Remote Control	No	No	No
WiFi Connectivity	Yes	Yes	Yes
Light Sensor	Yes	Yes	Yes
PM Sensor (PM 1, 2.5 and 10)	Yes	Yes	Yes
TVOC Sensor	Yes	Yes	Yes
RFID (Filter Life) Sensor	Yes (9000hr SW setting)	Yes (9000hr SW setting)	Yes (9000hr SW setting)
Temperature Sensor	Yes	Yes	Yes
Humidity Sensor	Yes	Yes	Yes
<b>FILTRATION</b>			
Stages of filtration - Out of box	5 (Pre, Anti-bacterial, HEPA, Activated Carbon, Ionizer)	5 (Pre, Anti-bacterial, HEPA, Activated Carbon, Ionizer)	5 (Pre, Anti-bacterial, HEPA, Activated Carbon, Ionizer)
Included filter, description	Hepal3, Active Carbon	Hepal3, Active Carbon	Hepal3, Active Carbon
Included filter, model denomination	EFDCLN4	EFDCLN4	EFDCLN4
Ionizer	Yes	Yes	Yes
C&A			
Feet accessories, model denominations	ECLDBI, ECLLB6	ECLDBI, ECLLB6	ECLDBI, ECLLB6

Model name	EP71-76WBA	EP71-76BLA	EP71-76GRA
Platform	PURE A9.2	PURE A9.2	PURE A9.2
PNC	956006701	956006702	956006773
EAN code	7332543833894	7332543833900	7332543837090
Product color	Wanlut Beige	Nordic blue	Ocean Green
Voltage	110V	110V	110V
Frequency	60Hz	60Hz	60Hz
Rated Power Consumption at max level(W)	61	61	61
Power Consumption Range (W)	61±10	61±10	61±10
Power cord length, m	2	2	2
Plug type	US type plug	US type plug	US type plug
Electronic Display	Yes	Yes	Yes
TFT Screen	Yes	Yes	Yes
<b>FUNCTIONAL DESIGN &amp; AESTHETICS</b>			
Main color	Wanlut Beige	Nordic blue	Nordic blue
Textile color	Wanlut Beige	Nordic blue	Nordic blue
Handle	Yes	Yes	Yes
Handle, color	Dark brown	Dark brown	Light brown
Handle, material	Leather imitation	Leather imitation	Leather imitation
Handle, screw	Copper screws	Copper screws	Copper screws
Wheels	Yes	Yes	Yes
User interface	Touch buttons and slider	Touch buttons and slider	Touch buttons and slider
Unit Size, (WxDxH), mm	315*315*750	315*315*750	315*315*750
Net weight, kg	8.9KG	8.9KG	8.9KG
<b>PERFORMANCE</b>			
Max Area Served, m2 (JEM1467, JP)	96	96	96
CADR, Smoke Max (JEM1467), m3/h ( ±10%)	751	751	751
CADR, Smoke Max (GBT), m3/h	700±5%	700±5%	700±5%
CCM Particulate	P4	P4	P4
T/VOC removal Efficiency (3 types, JEM1467)	95%	95%	95%
Formaldehyde removal Efficiency (GBT)	99%	99%	99%
Anti-bacterial Efficiency - Filter Standalone	100%	100%	100%
Particle Removal Efficiency (0.3µm) - Filter Standalone	100%	100%	100%
Fan speeds	9	9	9
Max noise according JEM	54.4	54.4	54.4
Motor type	BLDC	BLDC	BLDC
<b>MODES &amp; FEATURES</b>			
SMART Mode	Yes	Yes	Yes
Manual Mode	Yes	Yes	Yes
IAQ LED/Light Indicator & Colors - App & On Product	Yes. 4 - Blue, Green, Orange, Red	Yes. 4 - Blue, Green, Orange, Red	Yes. 4 - Blue, Green, Orange, Red
Filter Life Indicator - App & On Product	Yes	Yes	Yes
Child Lock Indicator - App & On Product	Yes	Yes	Yes
Ionizer Indicator - App & On Product	Yes	Yes	Yes
WiFi Indicator - App & On Product	Yes	Yes	Yes
*Real-time* IAQ Figures (Values) - App & On Product	Yes	Yes	Yes
*Real-time* OAQ Measurement - App Only	Yes	Yes	Yes
IAQ Historical Measurement - App Only	Yes, Last 12 Hours Only	Yes, Last 12 Hours Only	Yes, Last 12 Hours Only
<b>SENSORS &amp; CONTROL</b>			
Remote Control	No	No	No
WiFi Connectivity	Yes	Yes	Yes
Light Sensor	Yes	Yes	Yes
PM Sensor (PM 1, 2.5 and 10)	Yes	Yes	Yes
TVOC Sensor	Yes	Yes	Yes
RFID (Filter Life) Sensor	Yes (9000hr SW setting)	Yes (9000hr SW setting)	Yes (9000hr SW setting)
Temperature Sensor	Yes	Yes	Yes
Humidity Sensor	Yes	Yes	Yes
<b>FILTRATION</b>			
Stages of filtration - Out of box	5 (Pre, Anti-bacterial, HEPA, Activated Carbon, Ionizer)	5 (Pre, Anti-bacterial, HEPA, Activated Carbon, Ionizer)	5 (Pre, Anti-bacterial, HEPA, Activated Carbon, Ionizer)
Included filter, description	Hepal3, Active Carbon	Hepal3, Active Carbon	Hepal3, Active Carbon
Included filter, model denomination	EFDCLN6	EFDCLN6	EFDCLN6
Ionizer	Yes	Yes	Yes
<b>C&amp;A</b>			
Feet accessories, model denominations	ECLDB1, ECLLB4	ECLDB1, ECLLB4	ECLDB1, ECLLB4



## 6.2 Japan Market

Model name	EP71-56GYA	EP71-56WBA	EP71-76GYA
Platform	PURE A9.2	PURE A9.2	PURE A9.2
PNC	956006683	956006685	956006695
EAN code	7332543833719	7332543833733	7332543833832
Product color	Grey	Wanlut Beige	Grey
Voltage	100V	100V	100V
Frequency	50/60Hz	50/60Hz	50/60Hz
Rated Power Consumption at max level(W)	43	43	62
Power Consumption Range (W)	43±10	43±10	62±10
Power cord length, m	2	2	2
Plug type	NEMA 1-15 2-Pin Flat Un-polarized	NEMA 1-15 2-Pin Flat Un-polarized	NEMA 1-15 2-Pin Flat Un-polarized
Electronic Display	Yes	Yes	Yes
TFT Screen	Yes	Yes	Yes
<b>FUNCTIONAL DESIGN &amp; AESTHETICS</b>			
Main color	Light Grey	Wanlut Beige	Light Grey
Textile color	Light Grey	Wanlut Beige	Light Grey
Handle	Yes	Yes	Yes
Handle, color	Light brown	Dark brown	Light brown
Handle, material	Leather imitation	Leather imitation	Leather imitation
Handle, screw	Copper screws	Copper screws	Copper screws
Wheels	Yes	Yes	Yes
User interface	Touch buttons and slider	Touch buttons and slider	Touch buttons and slider
Unit Size, (WxDxH), mm	315*315*590	315*315*590	315*315*750
Net weight, kg	7.9KG	7.9KG	8.9KG
<b>PERFORMANCE</b>			
Max Area Served, m2 (JEM1467, JP)	71	71	96
CADR, Smoke Max (JEM1467), m3/h (+/-10%)	555	555	751
CADR, Smoke Max (GBT), m3/h	470±5%	470±5%	700±5%
CCM Particulate	P4	P4	P4
T/VOC removal Efficiency (3 types, JEM1467)	94%	94%	95%
Formaldehyde removal Efficiency (GBT)	91%	91%	99%
Anti-bacterial Efficiency - Filter Standalone	100%	100%	100%
Particle Removal Efficiency (0.3µm) - Filter Standalone	100%	100%	100%
Fan speeds	9	9	9
Max noise according JEM	51.4	51.4	54.4
Motor type	BLDC	BLDC	BLDC
<b>MODES &amp; FEATURES</b>			
SMART Mode	Yes	Yes	Yes
Manual Mode	Yes	Yes	Yes
IAQ LED/Light Indicator & Colors - App & On Product	Yes. 4 - Blue, Green, Orange, Red	Yes. 4 - Blue, Green, Orange, Red	Yes. 4 - Blue, Green, Orange, Red
Filter Life Indicator - App & On Product	Yes	Yes	Yes
Child Lock Indicator - App & On Product	Yes	Yes	Yes
Ionizer Indicator - App & On Product	Yes	Yes	Yes
WiFi Indicator - App & On Product	Yes	Yes	Yes
*Real-time* IAQ Figures (Values) - App & On Product	Yes	Yes	Yes
*Real-time* OAQ Measurement - App Only	-	-	-
IAQ Historical Measurement - App Only	Yes, Last 12 Hours Only	Yes, Last 12 Hours Only	Yes, Last 12 Hours Only
<b>SENSORS &amp; CONTROL</b>			
Remote Control	No	No	No
WiFi Connectivity	Yes	Yes	Yes
Light Sensor	Yes	Yes	Yes
PM Sensor (PM 1, 2.5 and 10)	Yes	Yes	Yes
TVOC Sensor	Yes	Yes	Yes
RFID (Filter Life) Sensor	Yes (18000hr SW setting)	Yes (18000hr SW setting)	Yes (18000hr SW setting)
Temperature Sensor	Yes	Yes	Yes
Humidity Sensor	Yes	Yes	Yes
<b>FILTRATION</b>			
Stages of filtration - Out of box	5 (Pre, Anti-bacterial, HEPA, Activated Carbon, Ionizer)	5 (Pre, Anti-bacterial, HEPA, Activated Carbon, Ionizer)	5 (Pre, Anti-bacterial, HEPA, Activated Carbon, Ionizer)
Included filter, description	HEPA13, CLEAN360	HEPA13, CLEAN360	HEPA13, CLEAN360
Included filter, model denomination	EFDCLN4	EFDCLN4	EFDCLN6
Ionizer	Yes	Yes	Yes
<b>C&amp;A</b>			
Feet accessories, model denominations	ECLDB1, ECLLB1	ECLDB1, ECLLB0	ECLDB1, ECLLB1

## 7. MAINTNANCE INSTRUCTION

### 7.1 Change the control PCB (without LCD)



Using the repair wrench, nested in touch panel, make it spin anticlockwise.  
Note: Use scratch-resistant protective film.

Removed the connected pins.

Unlock the ITO strip line and remove it.



Remove 2 screws.

Then take out the control PCB and change a new one.

- Re-assemble in opposite orders.  
- Change the barcode label at the base of the product and connectivity the applicant through the "Wellbeing APP" (smartphone application).

### 7.2 Change the control PCB (with LCD)

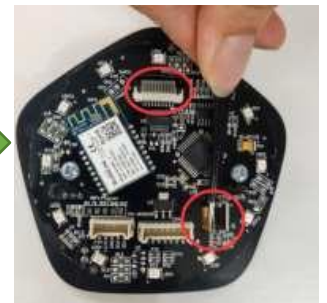

Using the repair wrench, nested in touch panel, make it spin anticlockwise.  
Note: Use scratch-resistant protective film.

Removed the connected pins.

Unlock the ITO and LCD strip lines and then remove the lines.



Remove 2 screws.



Then take out the control PCB and change a new one.



- Re-assemble in opposite orders.
- Change the barcode label at the base of the product and connectivity the applicant through the "Wellbeing APP" (smartphone application).

### 7.3 Change the touch panel (without LCD)



Using the repair wrench, nested in touch panel, make it spin anticlockwise.  
Note: Use scratch-resistant protective film.



Removed the connected pins.



Unlock the ITO strip line and remove it.



Using some flat tools to open the touch panel.



Take off the old touch panel.



Put a new touch panel in assembling mould.



Peel off the adhesive paper.

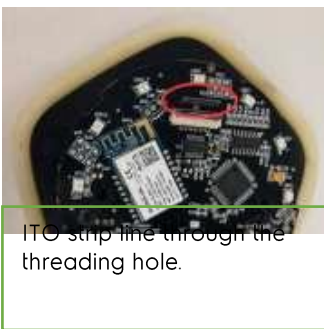

ITO strip line through the threading hole.



Push hard the shading cover part to make sure it fit completely with touch panel.



Insert the ITO strip lines and lock it.

Connecting the pins and assembling back.

## 7.4 Change LCD



Using the repair wrench, nested in touch panel, make it spin anticlockwise.  
Note: Use scratch-resistant protective film.



Removed the connected pins.

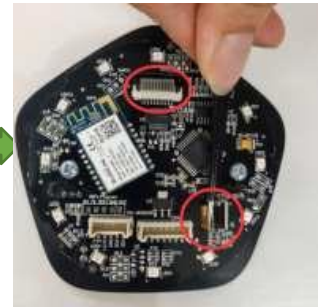

Unlock the ITO and LCD strip lines and then remove the lines.



Using some flat tools to open the touch panel.



Take off the old LCD, put a new LCD and also need change a new touch panel.



Put a new touch panel in assembling mould.



Peel off the adhesive paper.



ITO strip line and LED strip line through the threading hole.



Push hard the shading cover part to make sure it fit completely with touch panel.



Insert the ITO and LCD strip lines and lock them.

Connecting the pins and assembling back.

## 7.5 Change the sensor intake

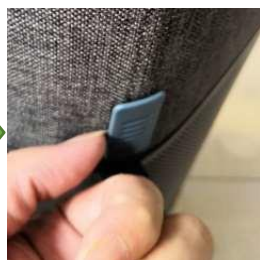

Using tools or hands to remove the sensor intake window.



Change a new one to put back.

## 7.6 Change filter door or decorative strip



Pull the filter door's fabric handle and take out it.



Using screw to take out two screws.



Remove the fabric handle.



Push-out two clips on both ends.



Take out the magnet.



Re-assemble in opposite orders.

## 7.7 Change filter and RFID label



Pull the filter door's fabric handle and take out it.



Pull out the filter.



Peel off the old RFID label.



Put a new RFID label.  
Remark: different mould and different country will be used different labels.



Put back the filter.



Put back the filter door.

## 7.8 Change the wheels



Put the product upside down.



One hand hold the unit, another hand pull out the wheels.



Press down the wheels to the mounting hole.

## 7.9 Change the base



Put the product upside down.



One hand hold the unit, another hand pull out the wheels.



Unscrew 5 screws.



Take out the electrical wire from fixed slot.

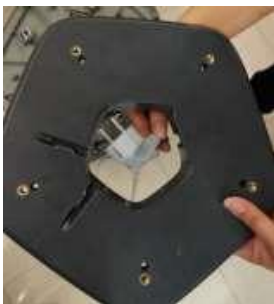

Remove the power cord from the base center hole.

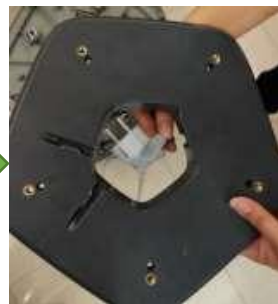

Through the power cord to a new base center hole.



Put the new base back according to the correct way.



Tighten five screws.



Press down all the wheels.

## 7.10 Change the sensor PCB



Put the product upside down and take out the filter door and filter.

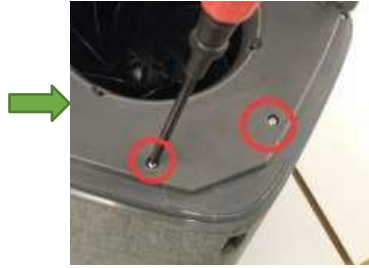

Unscrew two screws.



Take out the sensor part.



Release the sensor strip line and connected line.



Tighten two screws.



Take out the sensor PCB and change a new one.

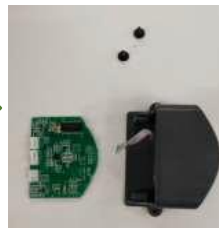

Put the new sensor PCB back and alignment it's correct position.

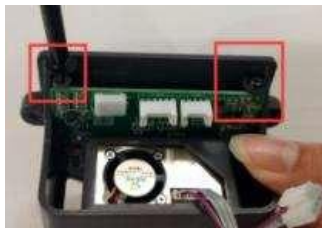

Tighten two screws.

Connecting the lines and assembling back.

## 7.11 Change the Power PCB/ Motor/ ionizer



Put the product upside down and take out the filter door and filter.



Unscrew six screws.



Take out the sensor part.



Release the sensor strip line and connected line.



Unscrew two screws and take out the plastic part.



Remove three screws.



Take out the top part.



Remove the five screws from air duct.

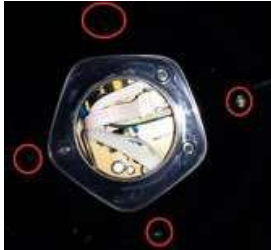

Remove four screws around the motor fixed piece and then open it.

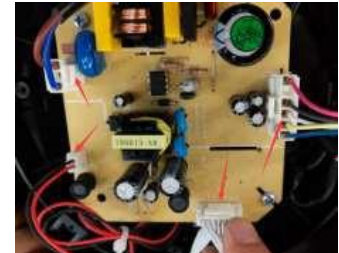

Remove the strip line from power PCB.



Unscrew four screws.

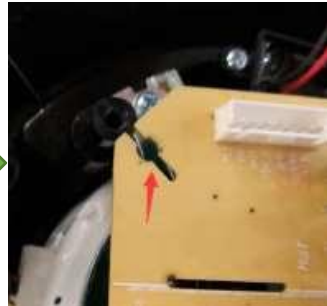

Assemble the new PCB to the motor



Remove the PCB, and unscrew two screws.



Then you can change the ionizer.



Remove the fan wheel part from the unit.







Upside down the unit.



Remove the turbine lock part.

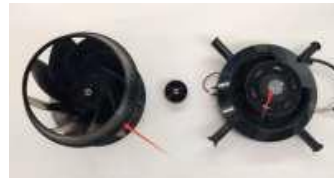

Remove the fan wheel and gasket from the motor shaft.

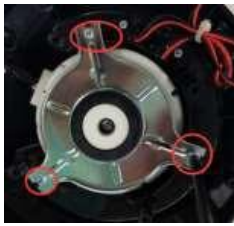

Remove four screws.



Remove the motor.

Re-assemble in opposite orders.

## 7.12 Change the PM 2.5 sensor



Put the product upside down and take out the filter door and filter.



Unscrew six screws.



Take out the sensor part.



Release the sensor strip line and connected line.



Take out the sensor from the sensor box.



Replace with new sensor and new sensor EVA.



Stick the new sensor EVA to new sensor.



Put back the new sensor to sensor box align at slot.

Connect the sensor strip line and connected line and assembling back with opposite orders.

### 7.13 Change the air outlet/shell (Fabric wrapping)



Put the product upside down and take out the filter door and filter.



Unscrew six screws.



Take out the sensor part.



Release the sensor strip line and connected line.



Remove two screws and take out the plastic part.



Remove three screws.



Take out the top part.



Remove five screws.



Take out the main plastic body.



Change the air outlet parts, shell.

Re-assemble in opposite orders.

### 7.14 Change the handle screws or PU handle



Unscrew the handle screw, then you can change the handle screw or PU handle.

### 7.15 Change the rubber feet (EU)



Put the product upside down.



Use needle nose pliers or hands to peel off the rubber feet.

Re-assemble in opposite orders.

### 7.16 Change the microswitch



Put the product upside down and take out the filter door and filter.



Unscrew six screws.



Take out the sensor part.

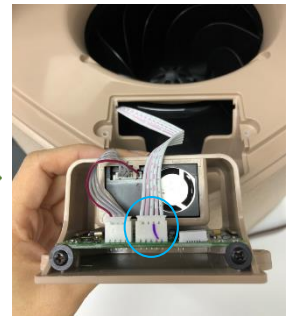

Release the sensor strip line and connected line.

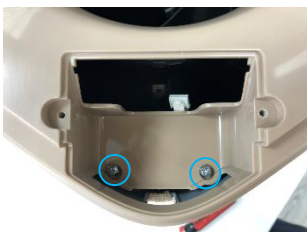

Remove two screws and take out the plastic part.



Remove three screws.

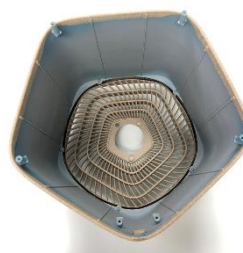

Put the product upside down and take out the top part.



Remove the five screws from air duct.

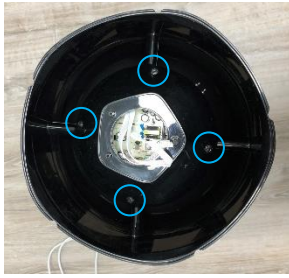

Remove four screws around the motor fixed piece and then open it.

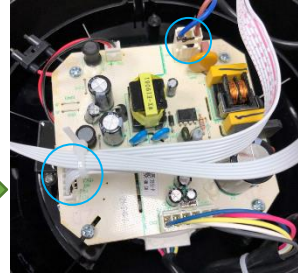
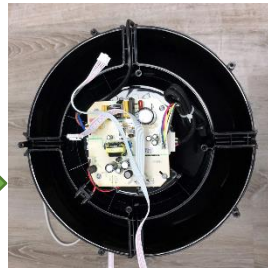

Remove the strip line from power PCB.



Take out the fan wheel part from the unit.



Remove five screws around the air duct.



Take out the air duct from the unit.

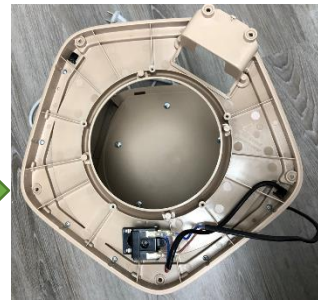

Remove a screw from microswitch.



Remove the strip line from the microswitch and change the new one.

Re-assemble in opposite orders.