



Electrolux

SERVICE MANUAL

Fabric Care

Document Revisions

Rev.	Date	Description	Author
00	01/2020	Document Released in TDS	Marcin Kobialka

FOR INTERNAL AND PARTNERS USE ONLY

Consumer Service APAC&MEA
Technical Support

TUMBLE DRYERS

Kraken series

EN

Publication number
599 83 48 - 23
Edition: 01/2020 - Rev. 00

INDEX

- IMPORTANT SAFETY NOTICE.....3
- INTRODUCTION.....5
- NOMENCLATURE.....6
- MODELS AND ATTRIBUTES.....7
- INSTALLATION INSTRUCTIONS.....9
- REVERSING THE DOOR.....15
- TECHNICAL SPECIFICATIONS.....18
- DEASSEMBLY AND FUNCTIONALITY.....19
- Fallas comunes y soluciones25
- ELECTRIC DRYER DIAGRAM.....28

IMPORTANT SAFETY NOTICE



IMPORTANT SAFETY NOTICE

The information in this presentation is intended for use by individuals possessing adequate backgrounds of electrical, electronic, & mechanical experience. Any attempt to repair a major appliance may result in personal injury & property damage. The manufacturer or seller cannot be responsible for the interpretation of this information, nor can it assume any liability in connection with its use.

WARNING

To avoid personal injury, disconnect power before servicing this product. If electrical power is required for diagnosis or test purposes, disconnect the power immediately after performing the necessary checks.

RECONNECT ALL GROUNDING DEVICES

If grounding wires, screws, straps, clips, nuts or washers used to complete a path to ground are removed for service, they must be returned to their original position & properly fastened.

PERSONAL PROTECTION EQUIPMENT (PPE) TO INSPECT AND REPAIR THE DRYER

- Plano Type Safety Glasses.
- Antistatic Steel Toe Work Boot.
- Cut Resistant Glove(s).
- Cut Resistant Sleeve(s).



CAUTION

**Prior to disassembly of the Dryer to access components,
Authorized Service Technicians are REQUIRED to
follow the Lockout / Tagout (LOTO) 6 Step Process**

Step 1

Plan and Prepare

Step 4

Apply LOTO device & Lock

Step 2

Shut down the appliance

Step 5

**Control (discharge) stored
energy**

Step 3

Isolate the appliance

Step 6

**“Try It” Verify that the
appliance is locked out**

INTRODUCTION

The Dryer Kraken platform replaces the previous versions of mabe dryers with a new style that combines with washers Kraken and includes special voltages for specific countries.

- ✓ Dryer Kraken offers energy saving due use less energy to generate heat and save gas.
- ✓ A new design of the lint trap filter to retain the lint that the garment gives off.
- ✓ In some electric models calculates the dry time necessary to save energy.



NOMENCLATURE

Nomenclature:

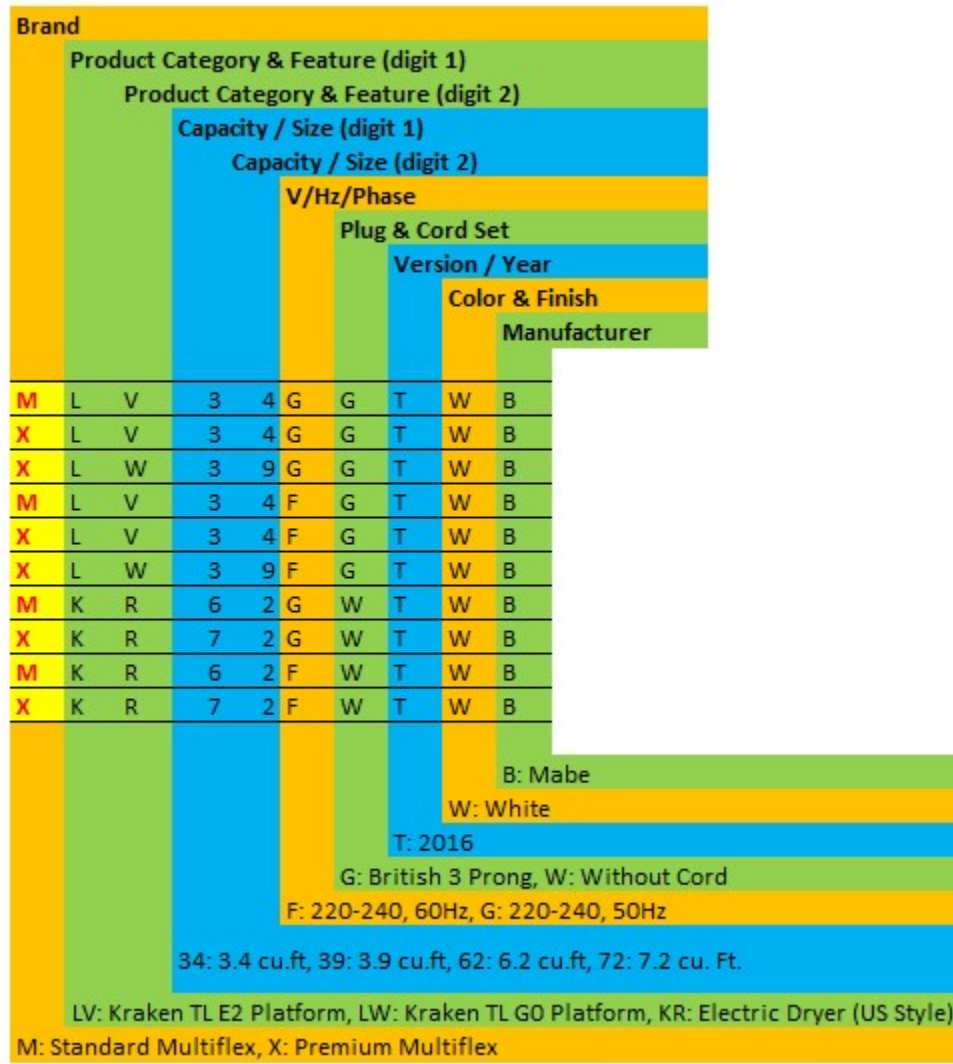

At the back of the dryer on the rear panel is the model and serial number of the dryer. With the next nomenclature:

0516SS50001

Serial Number Description

Month (MM)	Year (YY)	Dryer Constant.	Consecutive number assigned by the manufacturer site.
05	16	SS	50001

MODELS AND ATTRIBUTES

Main improvements:

- New backslash that match with Kraken washers.

MKR62GWTWB	
MKR62FWTWB	
XKR72GWTWB	
XKR72FWTWB	

- New knobs that goes with the design of Kraken washers.



- New metallic cover that combines with the Kraken washer.



- New handle integrated at the door.



-
- New lint filter design.



- Some models include a LED light to illuminate the interior of the dryer.



- The drum has an organic cover, resistant to corrosion, that reflects the heat faster and allows save energy per each dry cycle.



INSTALLATION INSTRUCTIONS

Unpacking your dryer

- Tilt the dryer sideways and remove the foam shipping pads by pulling at the sides and breaking them away from the dryer legs. Be sure to remove all of the foam pieces around the legs. Remove literature and bag containing accessories.
- Place the Dryer at designated area.

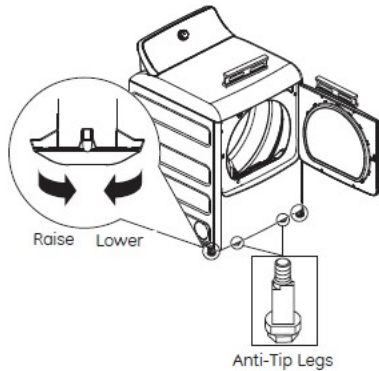
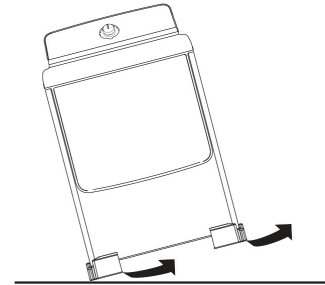

Stand the dryer upright near the final location and adjust the leveling legs at the corners to ensure the dryer is level side-to-side and front-to-back. Then, adjust the two anti-tip legs at the front inner corners, taking care that they are touching the floor to avoid unit tip over. The installation is not complete until this process is finished.

Warning: to avoid the risk of ignition and personal injury:

- ✓ This dryer must be exhausted to the outdoors.
- ✓ Before the old dryer is removed from service or discarded, remove the dryer door.
- ✓ Service information and the wiring diagram are located in the control console.
- ✓ The vent duct material **MUST BE METAL**.
- ✓ This dryer must be grounded. In the event of a malfunction or breakdown, grounding will reduce the risk of electric shock by providing a path of least resistance for electric current.
- ✓ Install the dryer where the temperature is above 10°C for satisfactory operation of the dryer control system.
- ✓ Remain the area beneath and around the dryer without flammable substances as lint, paper, solvents, chemicals, gasoline or other flammable liquids.
- ✓ The exhaust vent **MUST** be securely fastened to a non-combustible portion of the mobile home.

Before making the electrical connection, turn off the circuit breaker(s) or remove the dryer's circuit fuse(s) at the electrical box. Be sure the dryer cord is unplugged from the wall. **NEVER LEAVE THE ACCESS COVER OFF THE TERMINAL BLOCK.**

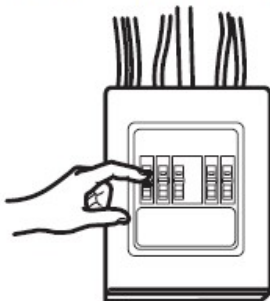

TOOLS YOU WILL NEED

- Slip-joint pliers



- Flat-blade screwdriver



- Phillips screwdriver



- Level



MATERIALS YOU WILL NEED

4" dia. metal elbow



3/4" Strain relief
(UL recognized)



4" Duct clamps (2) or
4" spring clamps (2)



Safety glasses



4" dia. metal duct
(recommended)

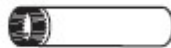

4" dia., UL-listed
flexible metal duct (if
needed)



Gloves



Exhaust hood



Duct tape



Dryer power cord kit
(not provided with
dryer)

UL rated 120/240V,
30A with 3 or 4 prongs.
Identify the plug type
as per the house
receptacle before
purchasing line cord.



4" Cover plate (Kit
WE49X22606)



BEFORE YOU BEGIN

- Remove and discard existing plastic or metal foil duct and replace with UL-listed duct.
- Remove any lint from the wall exhaust opening.

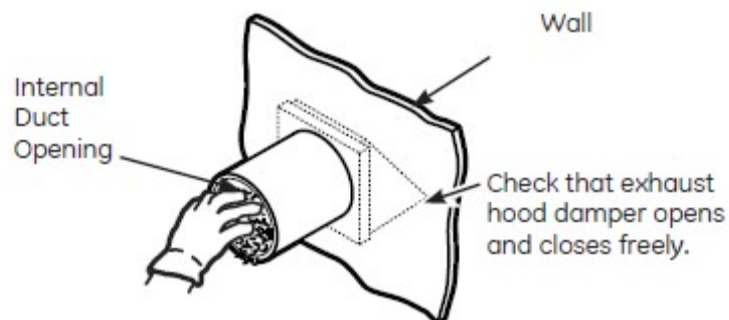

For electrical connections using a power cord:

Disconnect power before making electrical connections.
Connect neutral wire (white or center wire) to center terminal.
Ground wire (green or bare wire) must be connected to green ground connector.
Connect remaining two supply wires to remaining two terminals.
Securely tighten all electrical connections.
Replace the terminal block cover.

GROUNDING INSTRUCTIONS

For a grounded, cord-connected dryer: This dryer must be grounded. In the event of a malfunction or breakdown, grounding will reduce the risk of electric shock by providing a path of least resistance for electric current. This dryer uses a cord having an equipment-grounding conductor and a grounding plug. The plug must be plugged into an appropriate outlet that is properly installed and grounded in accordance with all local codes and ordinances.

WARNING

Improper connection of the equipment-grounding conductor can result in a risk of electric shock. Check with a qualified electrician, or service representative or personnel, if you are in doubt as to whether the appliance is properly grounded. **DO NOT modify** the plug on the power supply cord. If it will not fit the outlet, have a proper outlet installed by a qualified electrician.

For direct wire connections:

Use 10-gauge copper wire.
Use a strain relief.
Disconnect power before making electrical connections.
Connect neutral wire (white or center wire) to center terminal.
Ground wire (green or bare wire) must be connected to green ground connector.
Connect remaining two supply wires to remaining two terminals.
Securely tighten all electrical connections.
Replace the terminal block cover.
Failure to do so can result in death, fire or electrical shock.

GROUNDING INSTRUCTIONS

For a permanently connected dryer: This dryer must be connected to a grounded metal, permanent wiring system, or an equipment-grounding conductor must be run with the circuit conductors and connected to the equipment-grounding terminal on the appliance.

WARNING Improper connection of the equipment-grounding conductor can result in a risk of electric shock. Check with a qualified electrician, or service representative or personnel, if you are in doubt as to whether the appliance is properly grounded.

CONNECTING DRYER.

If required, by local code, install external ground (not provided) to grounded metal, cold water pipe, or other established ground determined by a qualified electrician.

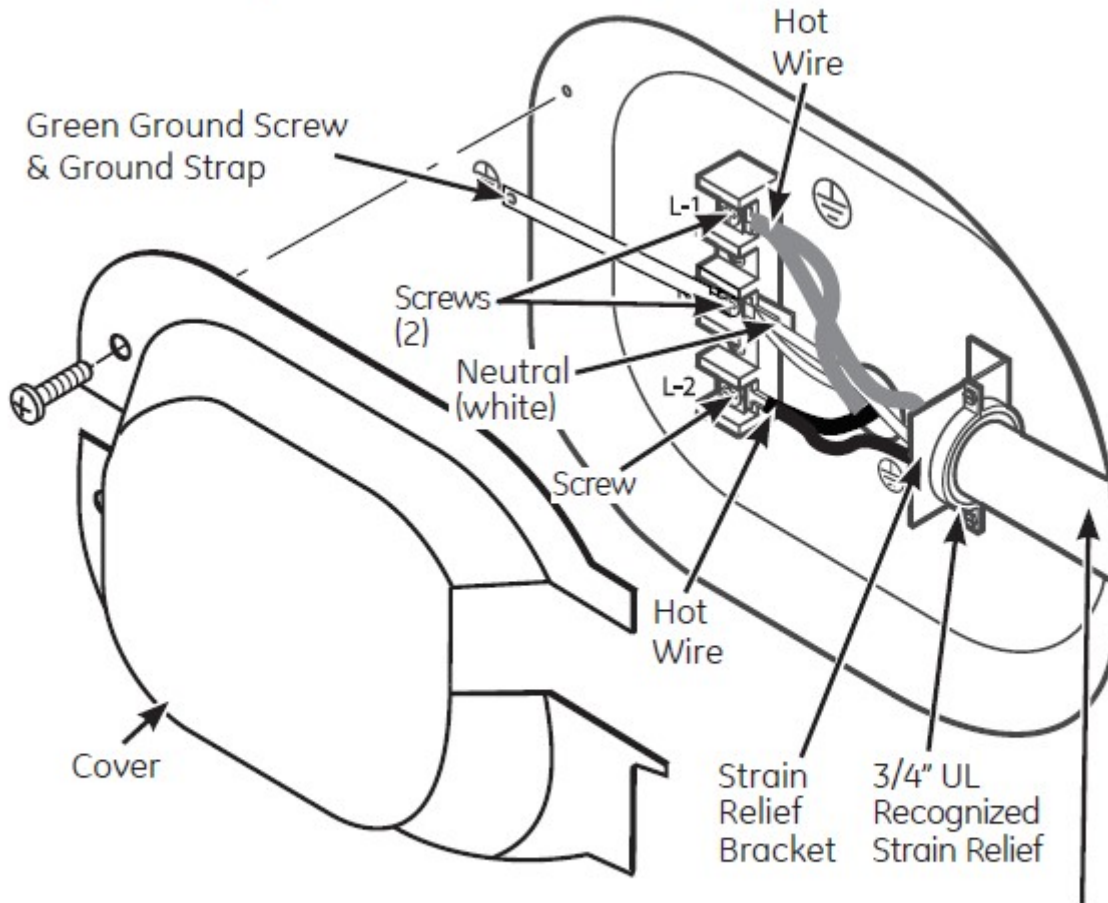

3 #10 AWG minimum copper conductors or 120/240V 30A power supply cord kit marked for use with dryers and provided with closed loop or spade terminals with upturned ends (not supplied).

1. Turn off the circuit breaker(s) (30 amp) or remove the dryer's circuit fuse at the electrical box.
2. Be sure the dryer cord is unplugged from the wall receptacle.
3. Remove the power cord cover located at the lower back.
4. Install 3/4-in. UL-recognized strain relief to power cord entry hole. Bring power cord through strain relief.
5. Connect power cord as follows:
 - A. Connect the 2 hot lines to the outer screws of the terminal block (marked L1 and L2).
 - B. Connect the neutral (white) line to the center of the terminal block (marked N).
6. Be sure ground strap is connected to neutral (center) terminal of block and to green ground screw on cabinet rear. Tighten all terminal block screws (3) securely.
7. Properly secure power cord to strain relief.
8. Reinstall the cover.

NEVER LEAVE THE COVER OFF OF THE TERMINAL BLOCK.

EXHAUSTING THE DRYER

Using exhaust longer than specified length will:

- Increase the drying times and the energy cost.
- Reduce the dryer life.
- Accumulate lint, creating a potential fire hazard.

The correct exhaust installation is YOUR RESPONSIBILITY.

Problems due to incorrect installation are not covered by the warranty.

The MAXIMUM ALLOWABLE length of the exhaust system depends upon the type of duct, number of turns, the type of exhaust hood (wall cap) and all conditions noted on the chart.

Internal elbows added for side or bottom vent conversions must be included in the total elbow count.

Any elbow greater than 45° should be treated as a 90° elbow.

Two 45° elbows will be treated like one 90° elbow.

For every additional 90° elbow, reduce the allowable vent system length by 3 m.

When calculating the total vent system length, you must add all the straight portions and elbows of the system (including the transition duct).

EXHAUST LENGTH

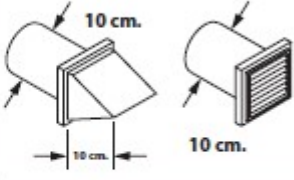
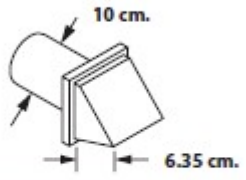
RECOMMENDED MAXIMUM LENGTH		
Exhaust Hood Types		
	Recommended	Use only for short run installations
		
No. of 90° Elbows	Rigid Metal	Rigid Metal
0	36.58 m	27.43 m
1	30.48 m	22.86 m
2	25.91 m	19.81 m
3	21.34 m	16.76 m
4	18.29 m	13.72 m
5	16.76 m	10.67 m

EXHAUST SYSTEM CHECKLIST

Hood or wall cap

- Terminate in a manner to prevent back drafts or entry of birds or other wildlife.
- Termination should present minimal resistance to the exhaust airflow and should require little or no maintenance to prevent clogging.
- Wall caps must be installed at least 30.5 cm above ground level or any other obstruction with the opening pointed down.

Separation of turns

- For best performance, separate all turns by at least 1.2 m. of straight duct, including distance between last turn and dampened wall cap.

Sealing of joints

- All joints should be tight to avoid leaks. The male end of each section of duct must point away from the dryer.
- Duct joints should be made air- and moisture-tight by wrapping the overlapped joints with duct tape or aluminum tape.
- Do not assemble ductwork with any fasteners that extend into the duct. These fasteners can accumulate lint, creating a potential fire hazard.
- Horizontal runs should slope down towards the outdoors 1/4" per foot.
- Provide an access for inspection and cleaning of the exhaust system, especially at turns and joints. Exhaust system shall be inspected and cleaned at least once a year.

Insulation

- Ductwork that runs through an unheated area or is near air conditioning should be insulated to reduce condensation and lint buildup.

STANDARD REAR EXHAUST

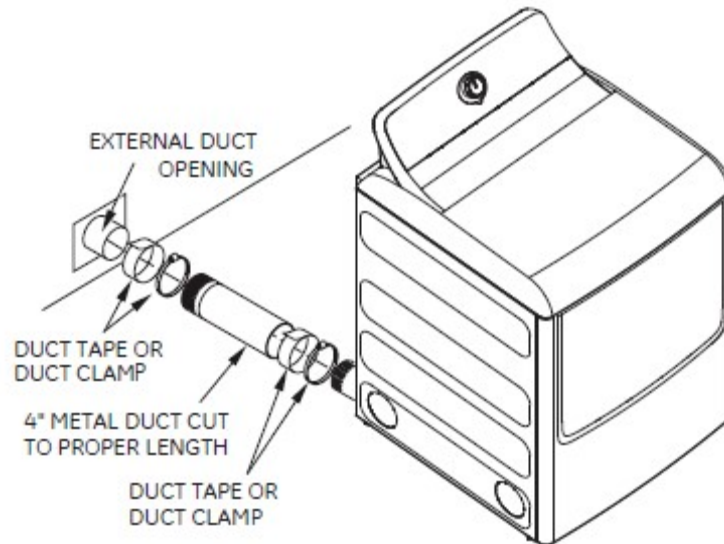
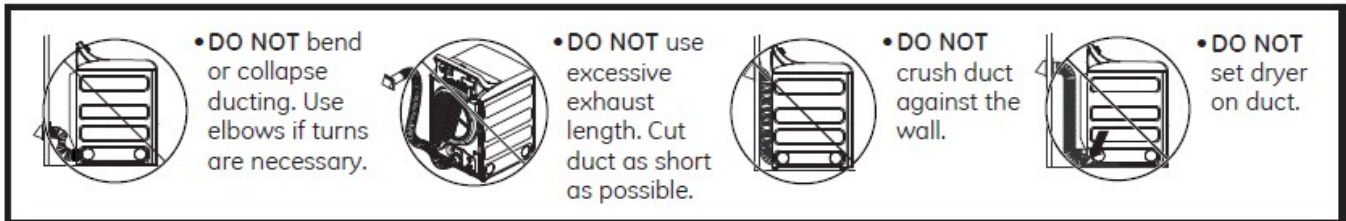
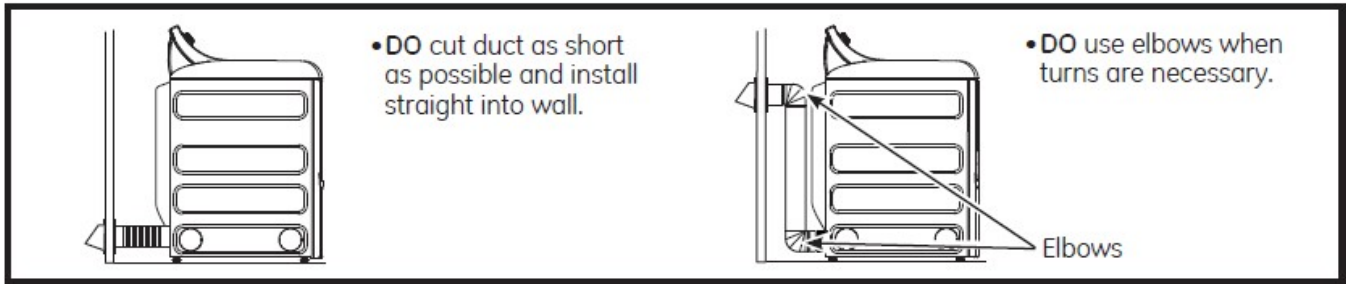

We recommend that you install your dryer before installing your washer. This will permit direct access for easier exhaust connection.

Slide the end of the exhaust duct on the back of the dryer and secure with duct tape or a duct clamp.

NOTE: We strongly recommend using rigid metal exhaust duct. However, if flexible ducting is used it must be UL-Listed metal, not plastic.

• For straight-line installation, connect the dryer exhaust to the wall, using duct tape or a duct clamp.

REVERSING THE DOOR

REVERSING THE DOOR SOLID DOOR MODELS

1. Open the door approximately 130 degrees. With a putty knife, remove the 4 plastic caps located along the left side of the front panel and set them aside.

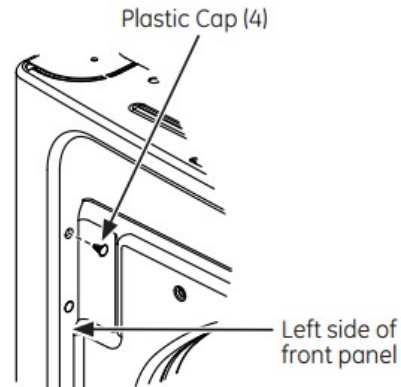
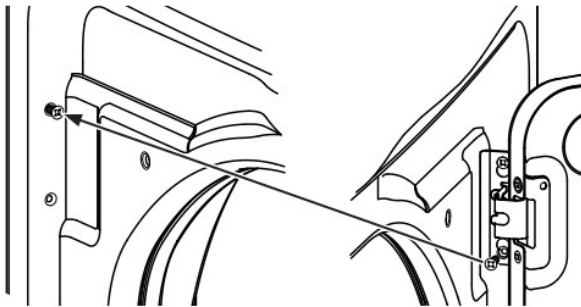

2. Remove the bottom screw from each hinge (right side) and partially insert them into each top hinge hole on the left side. **NOTE:** All 4 front panel hinge screws will now be in the top hinge holes - 2 on the left and 2 on the right.

3. Loosen each top hinge screw on right side. Remove the door and place it on a protective flat surface to avoid any damage.
4. Remove both the blind plate and the strike plate and install them in opposite positions.

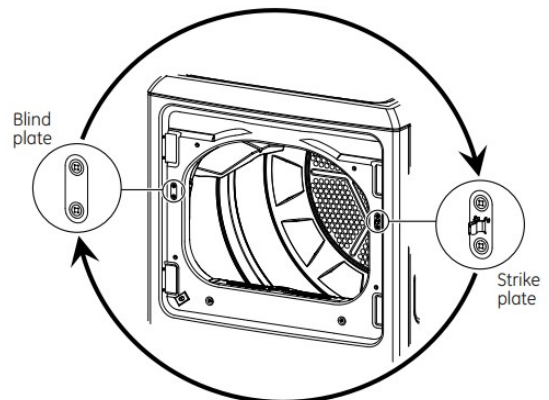
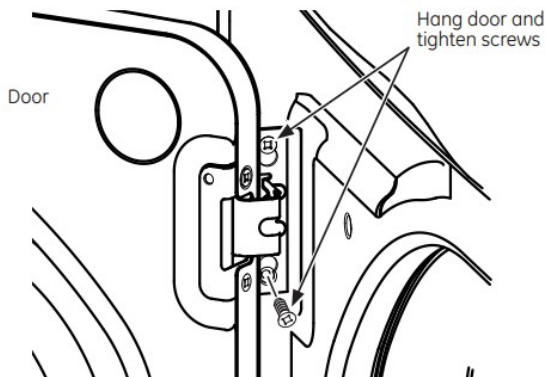

5. Mount the door on the 2 upper left side hinge screws installed in step 2. Move the hinge screws loosened in step 3 into the lower left side screw holes and firmly tighten all 4 screws.
6. Install the 4 plastic caps removed in step 1 into the 4 right side front panel holes.

NOTE: To return the door to the original setup, follow these instructions, swapping "left" and "right".

REVERSING THE DOOR - GLASS PANEL DOOR MODELS

1. Open the door approximately 130 degrees. With a putty knife, remove the 4 plastic caps located along the left side of the front panel and set them aside.
2. Remove the bottom screw from each hinge (right side) and partially insert them into each top hinge hole on the left side

NOTE: All 4 front panel hinge screws will now be in the top hinge holes - 2 on the left and 2 on the right.

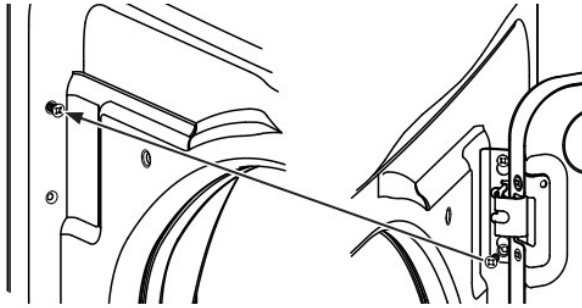
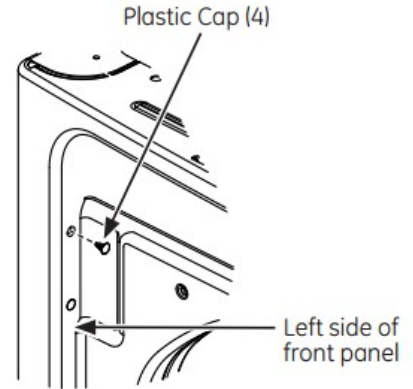

3. Loosen each top hinge screw on right side. Remove the door and place it on a protective flat surface to avoid any damage.

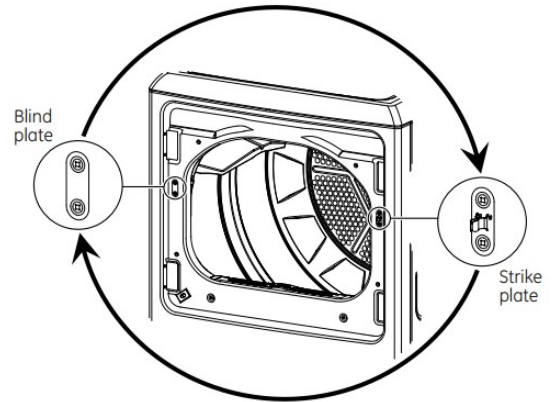

4. Remove both the blind plate and the strike plate and install them in the opposite positions.

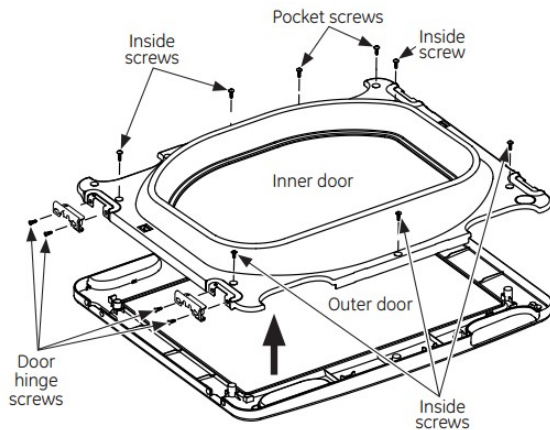

5. Remove the 4 door hinge screws, 6 inside screws and 2 pocket screws. Lift the inner door upwards using a flat blade screwdriver.

6. Remove and swap the 2 plastic caps and the 2 hinges.

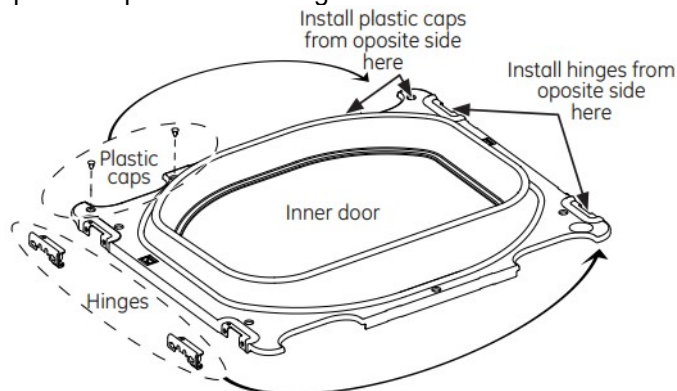

-
7. Rotate the outer door 180 degrees, mount the inner door back into the outer door frame and secure with the screws removed in step 5. Make sure you mount the hinges on the side opposite the pocket.

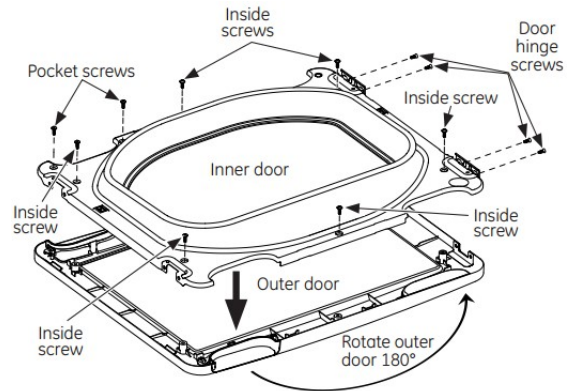
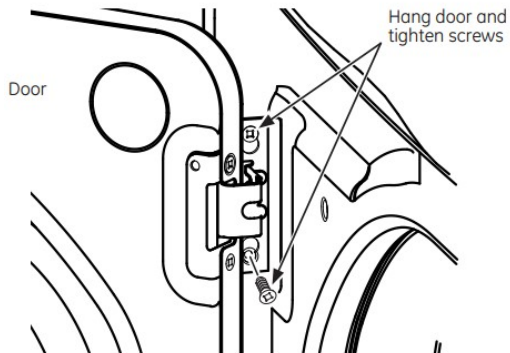

8. Mount the assembled door on the 2 upper left side hinge screws installed in step 2. Move the hinge screws loosened in step 2 into the lower left side screw holes and firmly tighten all 4 screws.

9. Install the 4 plastic caps removed in step 1 into the 4 right side front panel holes.

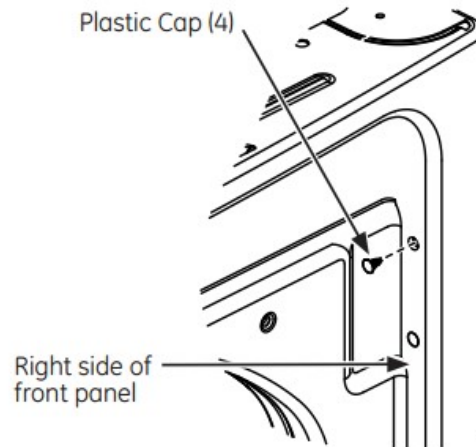

NOTE: To return the door to the original setup, follow these instructions, swapping "left" and "right".

TECHNICAL SPECIFICATIONS

Model	Electrical Requeriments	Dry Sistem	Maximum load
MKR62GWTWB	220-240V/50 Hz	Electric	10kg
MKR62FWTWB	220-240V/60 Hz	Electric	10kg
XKR72GWTWB	220-240V/50 Hz	Electric	11kg
XKR72FWTWB	220-240V/60 Hz	Electric	11kg

Technical Specification		
Operational Frequency	60Hz	50Hz
Supply Voltage	220V~	220V~
Nominal current	24A	24A

THE DRYER OPERATION

On front view the drum rotates clockwise at 48 to 54 rpm. The air is impulse through the electrical heating resistance and send it to the clothes absorbing the humidity and lint.

The lint is filtered to outside when the air goes through the drum to the filter grill and blower duct to exhaust in the vent duct.

The thermostat controls the air temperature according with the load size program selector. The time cycle length is controlled by the minutes selected on the timer or an automatic control by the timer and the thermostat for the type of clothes selected (Automatic Drying Cycles).

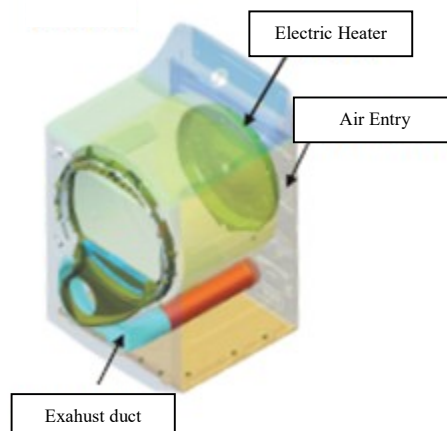

DEASSEMBLY AND FUNCTIONALITY

THE DRYER COMPONENTS

To access at the inner of the dryer you will need to remove two screws at the front panel of the washer.



Also remove the two screws of the backslash dryer.



Tilt the backslash with precaution to the top cover, the harness still connected to the main board.

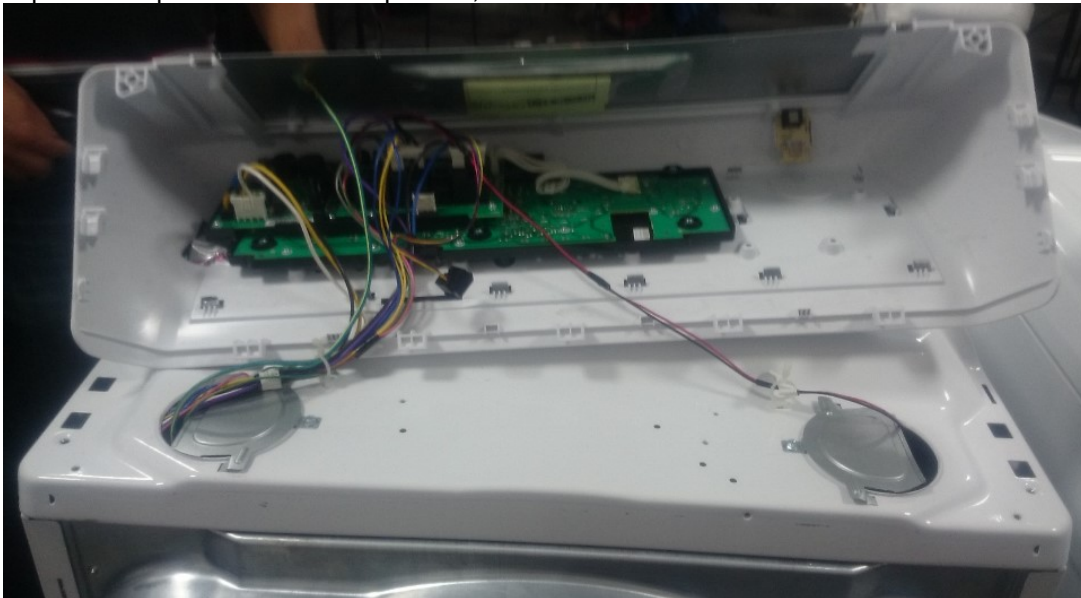

Unplug the harness from the timer and selectors, retrieve the harness carefully.

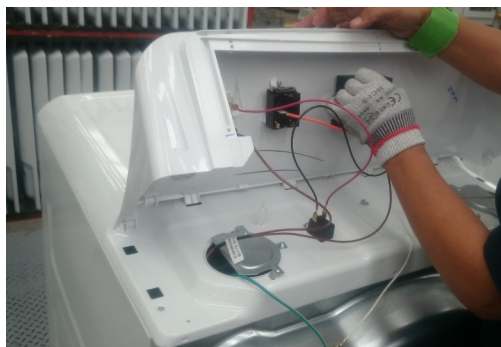

Remove the screws from the covers to free the harness.

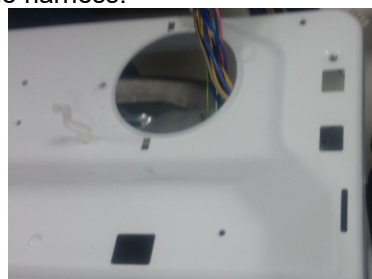

Remove the screws from the drum cover to remove easily the drum.



Remove the front panel.

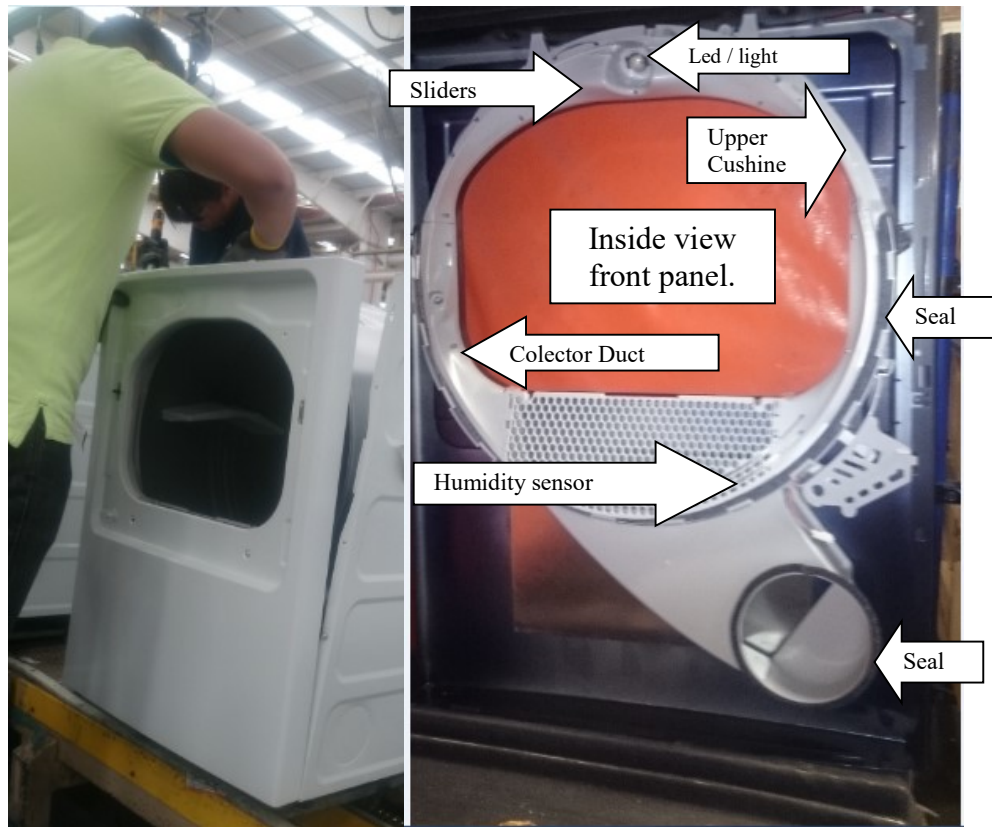

To reach the motor it is necessary remove the screws as shown.





Inner view of Dryer

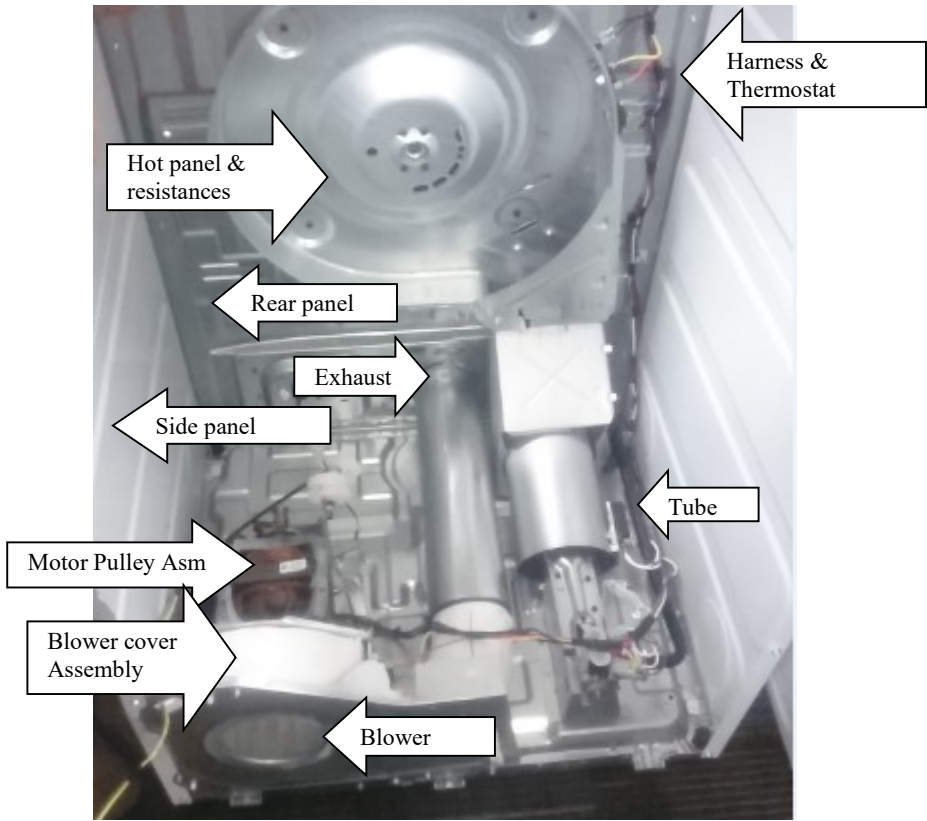

Air flow and seals.

For the correct development of temperature control and safety systems is necessary a good air flow through the dryer. The air is pulled from the inner front part of the box and it is heated through the resistances at the hot cover situated behind the drum. The hot air is pulled through the load in the drum, then pass through the lint filter and trap duct in the blower. After pass the blower the air is pushed out to the exhaust system. Any air leak at the entrance, the blower, the drum, the front sealing or trap duct will mean an unappropriated temperature. The pulled air from the trap duct to the outside thermostat will be cooler than the usual and detecting a false measure that will delay the process or a no triggered signal from the thermostat. The front blower leaks will reduce the volume of air through the heater resistances that will have hot spots that reduce the life of the dryer.

The air access to the dryer cabinet, going through the heating components and inside the drum. The warm air takes from the wet load the humidity on a steam form. Then the air and the steam is vent through the exhaust dryer system. The general temperature of the heater is regulated for temperature sensor, on at the entrance located near the heater elements, and the other at the exhaust duct vent. An additional safety thermostat is located near to the heating resistances that will shut down the system if exist an overheating.

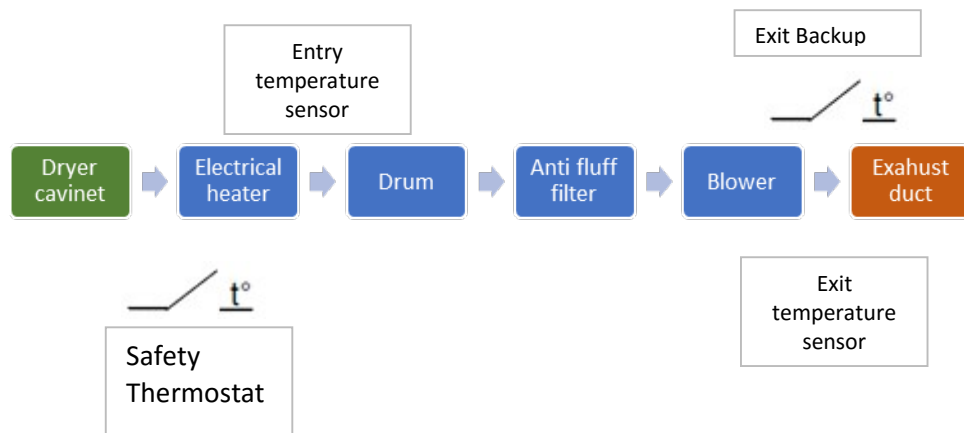

Duct Sealing.

To verify the trap duct has an appropriated sealing remove the lint filter and look down in the duct. With a light evaluated the trap duct in all sides that joint with the front of the dryer.

Transmission belt.

The drum rotates by effect of the transmission belt at a speed of 47 to 51 RPM. The tensile of the belt is due a spring loaded pulley that is activated by the rear motor shaft.

Common dryer cycle.

1. Select a cycle and push start button.
2. The motor is activated
3. The heating resistances are energized
4. When the temperature reach the set point selected, the heating resistances starts switching "ON" or "OFF" to remain on the selected temperature.
5. The heating resistances will remain switching ON or OFF until the temperature of the load reach the selected temperature or during the time selected on the timer.
6. The motor continues working until the temperature of the load is under the selected set point. (Cool down)
7. End of Cycle

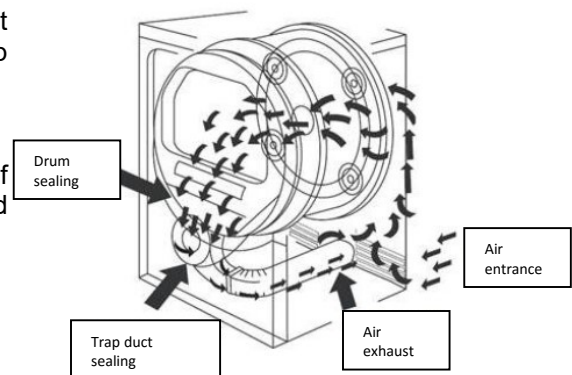

Control Board (Only for XKR72GWTWB & XKR72FWTWB models)

WW02F00710



J3

J2

J1

Conector	Description	Pin measure	Pin Voltage	Additional comments
J1	Line Neutro	/ 1 y 3	240 VAC	Control board power supply
	VDD Neutro	/ 1 y 8	24 VDC	Direct Current Voltage
	Timer Motor	1 y 4	240 VAC	When the load is almost Dry

TROUBLESHOOTING

Problem	Possible Causes	What To Do
Dryer doesn't start	Dryer is unplugged	<ul style="list-style-type: none"> • Make sure the dryer plug is pushed completely into the outlet.
	Fuse is blown/circuit breaker is tripped	<ul style="list-style-type: none"> • Check the house fuse/circuit breaker box and replace fuse or reset breaker. NOTE: Most electric dryers use two fuses/breakers.
Dryer doesn't heat	Fuse is blown/circuit breaker is tripped; the dryer may tumble but not heat	<ul style="list-style-type: none"> • Check the house fuse/circuit breaker box and replace both fuses or reset both breakers. Your dryer may tumble if only one fuse is blown or one breaker is tripped.
	Gas service is off	<ul style="list-style-type: none"> • Make sure gas shutoff at dryer and main shutoff are fully open.
	No heat temperature selected	<ul style="list-style-type: none"> • Select another heat setting.
Dryer shakes or makes noise	Some shaking/noise is normal. Dryer may be sitting unevenly	<ul style="list-style-type: none"> • Move dryer to an even floor space, or adjust leveling legs as necessary until even
Greasy spots on clothes	Improper use of fabric softener	<ul style="list-style-type: none"> • Follow directions on fabric softener package.
	Drying dirty items with clean ones	<ul style="list-style-type: none"> • Use your dryer to dry only clean items. Dirty items can stain clean items and the dryer.
	Clothes were not completely clean	<ul style="list-style-type: none"> • Sometimes stains which cannot be seen when the clothes are wet appear after drying. Use proper washing procedures before drying.
Lint on clothes	Lint filter is full	<ul style="list-style-type: none"> • Clean lint screen before each load.
	Improper sorting	<ul style="list-style-type: none"> • Sort lint producers (like chenille) from lint collectors(like corduroy).
	Static electricity can attract lint	<ul style="list-style-type: none"> • See suggestions in this section under Static.
	Overloading	<ul style="list-style-type: none"> • Separate large loads into smaller ones.
	Paper, tissue, etc., left in pockets	<ul style="list-style-type: none"> • Empty all pockets before laundering clothes.
Static occurs	No fabric softener was used	<ul style="list-style-type: none"> • Try a fabric softener.
	Over-drying	<ul style="list-style-type: none"> • Try a fabric softener. • Adjust setting to Less Dry or Damp Dry.
	Synthetics, permanent press and blends can cause static	<ul style="list-style-type: none"> • Try a fabric softener.
Inconsistent drying times	Type of heat	<ul style="list-style-type: none"> • Automatic drying times will vary according to the type of heat used (electric, natural or LP gas), size of load, types of fabrics, wetness of clothes and condition of exhaust ducts.
The Dry dryness level was chosen but load is still damp	Load consists of a mixture of heavy and light fabrics	<ul style="list-style-type: none"> • When combining heavy and light fabrics in a load, choose More Dry if you are using a sensor cycle.
	Exhaust system is blocked	<ul style="list-style-type: none"> • Inspect and clean exhaust system.
Clothes take too long to dry	Improper sorting	<ul style="list-style-type: none"> • Separate heavy items from lightweight items (generally, a well-sorted washer load is a well-sorted dryer load).
	Large loads of heavy fabrics (like beach towels)	<ul style="list-style-type: none"> • Large, heavy fabrics contain more moisture and take longer to dry. Separate large, heavy fabrics into smaller loads to speed drying time.
	Controls improperly set	<ul style="list-style-type: none"> • Match control settings to the load you are drying.

	Lint filter is full	• Clean lint filter before every load.
	Improper or obstructed ducting	<ul style="list-style-type: none"> • Check installation instructions for proper ducting/venting. • Make sure ducting is clean, free of kinks and unobstructed. • Check to see if outside wall damper operates easily. • Check the Installation Instructions to make sure the dryer venting is correct.
	Blown fuses or tripped circuit breaker	• Replace fuses or reset circuit breakers. Since most dryers use 2 fuses/breakers, make sure both are operating.
	Overloading/combining loads	• Do not put more than one washer load in the dryer at a time.
	Under-loading	• If you are drying only one or two items, add a few items to ensure proper tumbling.
Clothes are wrinkled	Over-drying	<ul style="list-style-type: none"> • Select a shorter drying time. • Remove items while they still hold a slight amount of moisture. Select a Less Dry or Damp Dry setting.
	Letting items sit in dryer after cycle ends	• Remove items when cycle ends and fold or hang immediately.
	Overloading	• Separate large loads into smaller ones.
Clothes shrink	Some fabrics will naturally shrink when washed. Others can be safely washed, but will shrink in the dryer	<ul style="list-style-type: none"> • To avoid shrinkage, follow garment care labels exactly. • Some items may be pressed back into shape after drying. • If you are concerned about shrinkage in a particular item, do not machine wash or tumble dry it
Water seen on inside of door and top of lint filter when opening door after steam cycle	Steam condenses on these surfaces	• This is normal
Small areas on clothes are damp after steam cycle	Steam condenses on inner drum	• If using the Steam Dewrinkle cycle, manually reduce the cycle time. If using the Steam Refresh cycle, add more garments to the load.
Collars and waistbands still wet at end of cycle	The dryness monitor senses that the body of the clothes	• Choose Speed Dry or Timed Dry to dry damp collars and waistbands. In the future, when drying a load with is dry collars and waistbands, choose More Dry .
Slight variation in metallic color	This is normal	• Due to the metallic properties of paint used for this unique product, slight variations of color may occur due to viewing angles and lighting conditions.
Small amount of water on floor in front of dryer	Inadequate load size for steam cycle selected, excess steam condenses inside cabinet and leaks out	• If using the Steam Dewrinkle cycle, manually reduce time. If using the Steam Refresh cycle, add more garments to the load.

Water on floor in back of dryer

Loose water hose connection to valve

• Tighten connection.

Hose missing rubber washer at connection with valve

• Install rubber washer provided with hose.

Clothes are still wet and dryer shuts off after a short time

The door was opened mid-cycle
The load was then removed from the dryer and a new load put in without selecting a new cycle

• A dry cycle must be re-selected each time a new load is put in.

Small load

• When drying 3 items or less, choose ***Speed Dry*** or ***Timed Dry***.

Load was already dry except for collars and waistbands

• Choose ***Speed Dry*** or ***Timed Dry*** to dry damp collars and waistbands. In the future, when drying a load with collars and waistbands, choose ***More Dry***.

Dryer is not level

• Move dryer to an even floor space or adjust leveling legs as necessary until even.

ELECTRIC DRYER DIAGRAM

At the inner of the backslash is located the next information

MKR62FWTWB & MKR62GWTWB

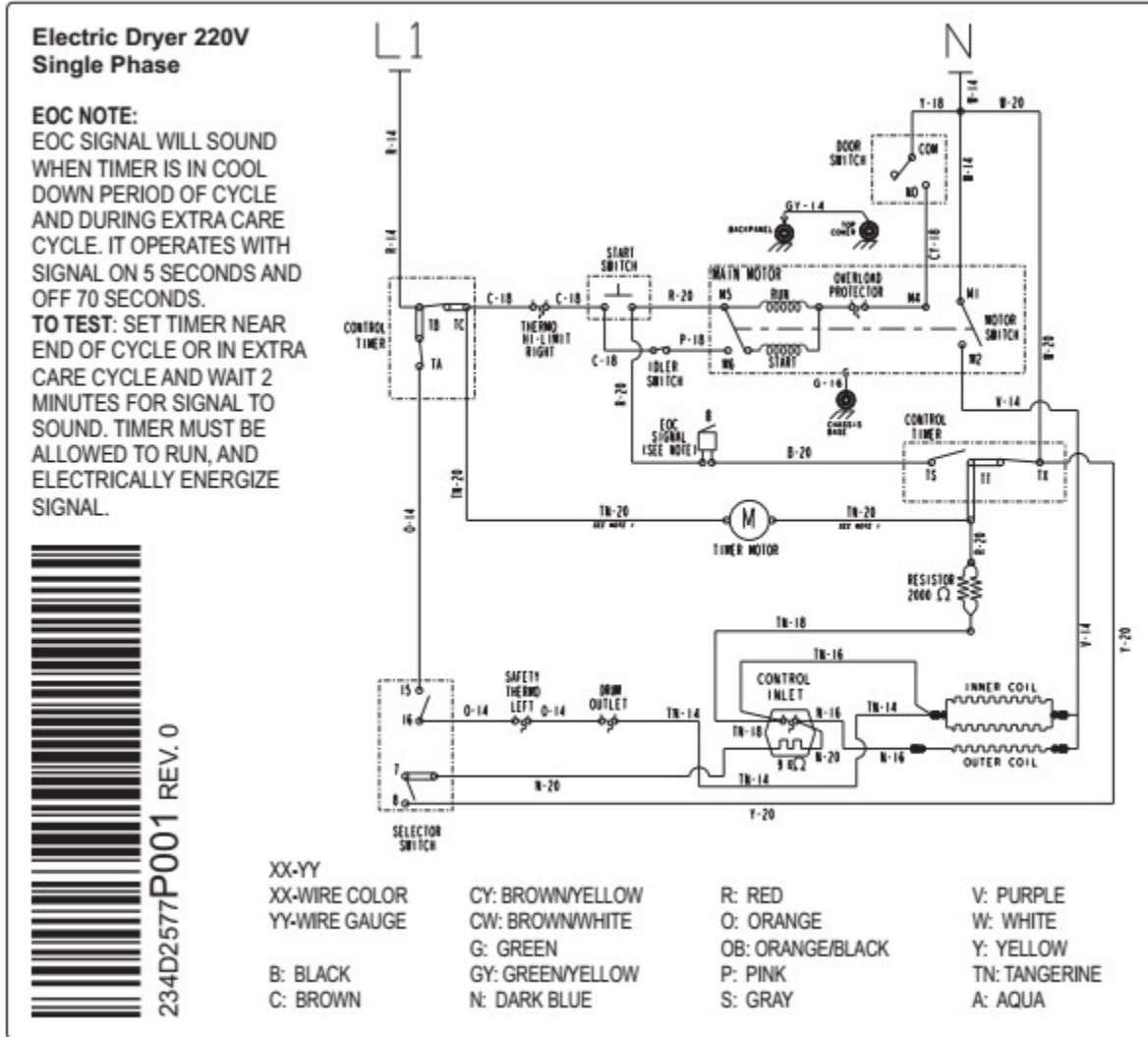

XKR72GWTWB & XKR72FWTWB

Electric Dryer 220V Single Phase

EOC NOTE:

EOC SIGNAL WILL SOUND WHEN TIMER IS IN COOL DOWN PERIOD OF CYCLE AND DURING EXTRA CARE CYCLE. IT OPERATES WITH SIGNAL ON 5 SECONDS AND OFF 70 SECONDS.

TO TEST:

SET TIMER NEAR END OF CYCLE OR IN EXTRA CARE CYCLE AND WAIT 2 MINUTES FOR SIGNAL TO SOUND. TIMER MUST BE ALLOWED TO RUN, AND ELECTRICALLY ENERGIZE SIGNAL.



234D2577P006 REV. 0

XX-YY
XX-WIRE COLOR
YY-WIRE GAUGE

B: BLACK
BY: BLACK/YELLOW

C: BROWN
CY: BROWN/YELLOW
CW: BROWN/WHITE
G: GREEN
GY: GREEN/YELLOW

N: DARK BLUE
R: RED
O: ORANGE
OB: ORANGE/BLACK
P: PINK

S: GRAY
V: PURPLE
W: WHITE
Y: YELLOW
TN: TANGERINE
A: AQUA

