

Appliance not starting / Automatic Door Opening function not working**DESCRIPTION:**

At the current dishwashers that have the “diamond” door lock with auto door opening it is possible to bend Upper Front Crossbar by inproper handing, transportation or installation to the position where Door Lock’s hooks and Diamond will be out of horizontal alignment:



Diamond door lock

Pic.1



Zoomed picture where we can observe Upper Front Crossbar being bended:

Pic. 2



OUTCOME:

Appliance will not start or will not open the Door automatically at the end of the cycle on Air Dry phase.

SOLUTION:

Bending Upper Front Crossbar downwards to provide correct alignment between Door Lock's hooks and Diamond:

Method description:

Carefully pushing by hand (bending) Upper Front Crossbar downwards at its center (marked by **green arrows**) to align horizontally Door Lock's hooks with Diamond (see pic. 4);

Pic.3

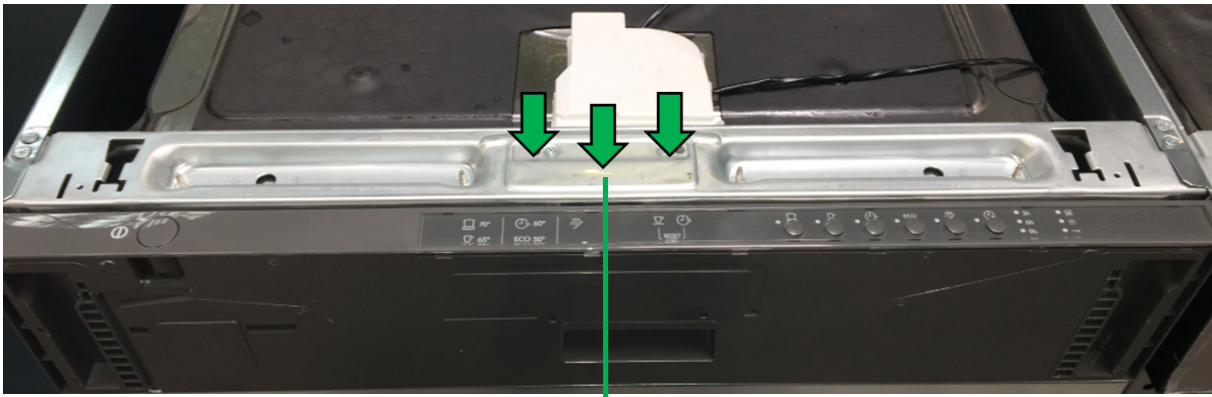

ATTENTION!:

Be careful while pushing on crossbar; push with limited, low force few times. Do not overextend with bending – it may cause collision of Inner Door & Upper Front Crossbar!

Outcome:

Proper alignment where Diamond is slightly above the Door Lock's hooks:

Pic.4



Zoomed picture with proper alignment (Pic. 4):



MODELS CONCERNED:

All models with 2nd generation Global door lock (the diamond shape) from Solaro and Zarow.

REVISION:

Revision	Date	Description	Author	Approved by - on
0	28.06.2019	Appliance not starting / Automatic Door Opening function not working	Sebastian Dziura Rui Almeida	Sebastian Dziura Rui Almeida