



SERVICE MANUAL

COOKING

FOR INTERNAL AND PARTNERS USE ONLY

© ELECTROLUX HOME PRODUCTS
Consumer Service - EMEA
Quality & Continuous Improvement - Technical Support

VISSO

RANGE HOOD



EN

Publication number
599 826 682
Edition: 08/2019 - Rev. 00

CONTENTS

CONTENTS	1
1 PURPOSE OF THIS MANUAL	2
2 SAFETY	3
3 VISSO RANGE HOOD	4
4 ACCESSIBILITY	5
5 ELECTRICAL WIRING	11
6 TROUBLESHOOTING	12

1 PURPOSE OF THIS MANUAL

The purpose of this Service Manual (SM) is to provide Service Engineers who are already familiar with the repair procedures of Hoods
This SM will provide information on:

- Hood Range
- Accessibility
- Technical and functional characteristics
- Troubleshooter

Document Revisions

Rev.	Date	Description	Author
00	08/2019	Document creation	Said Hatem

Acronyms & Abbreviations

Terms	Initials
Grease Filter	GF
Blower Assembly	BA
Control Assembly	CA
Feeder Cable	FC
Frame Assembly	FA
Lower Panel Assembly	LPA
Electrical Installation Assembly	EIA
Heat Sensor	HS

2 SAFETY



- All the work to be performed inside the appliance requires specific skills and knowledge and may only be carried out by qualified and authorised Service Engineers.
- Before you access internal components, take the plug out of the socket to disconnect the power supply.
- Use a pair of safety gloves to avoid sharp cuts.
- Some of the components in the mechanical part could cause injuries, so wear suitable protection and proceed with caution.
- Prior to touching the light bulbs ensure they are cooled down.

3 VISSO RANGE HOOD

3.1 Hood Features

It's a mechanical device which situated over the cooktop, mainly contains a Blower Assembly, Grease Filters and a Control Assembly.

1	Control Assembly
2	Grease Filter
3	Lamp
4	Electrical Installation Assembly
5	Lower Panel Assembly
6	Heat Sensor
7	Blower Assembly
8	Frame Assembly

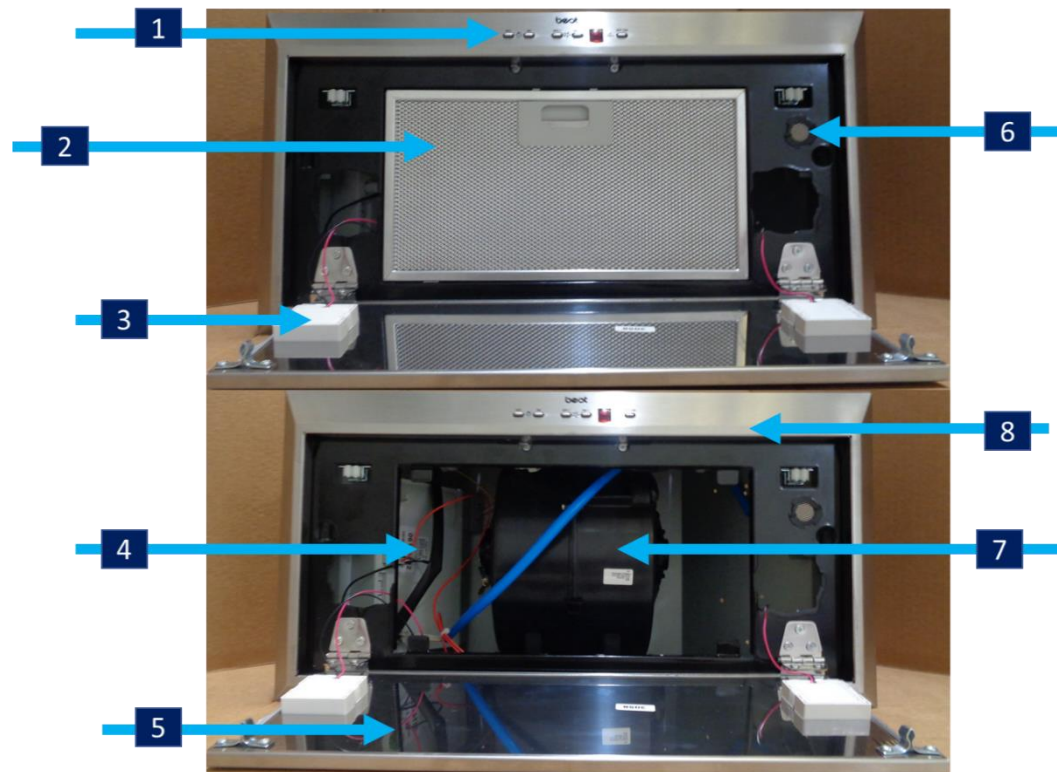

4 ACCESSIBILITY

4.1 Grease Filter

1. Pull downward the [LPA](#).
2. Press the catch in the handle structure to unsnap the [GF](#).
3. Pull downward the [GF](#).
4. The [GF](#) removed.



4.2 Lower Panel Assembly

Perform chapter [4.1](#)

1. Unsnap the lamps connectors.
2. Unfasten 4* screws which secure the [LPA](#) to the [FA](#).
3. The [LPA](#) removed.

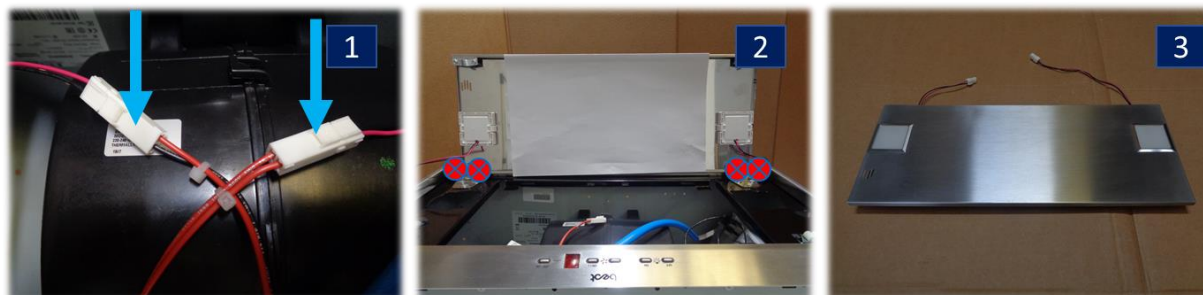

4.3 Lamp

Perform chapter [4.1](#) and the 1st step of chapter [4.2](#)

1. Press the springs to unsnap the lamp.
2. The lamp removed.

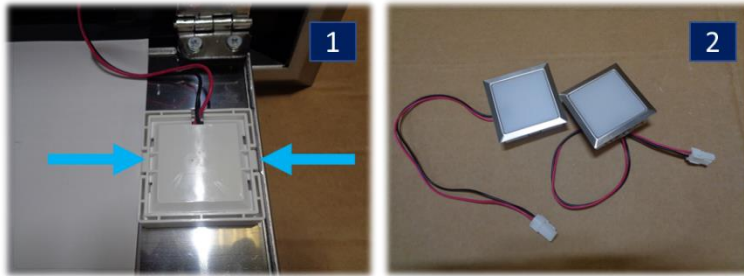

4.4 Heat Sensor

Perform chapter [4.1](#)

1. Unsnap the [HS](#) bus cable from the [EIA](#).
2. Unsnap the [HS](#) bus cable holder.
3. Turn counter clockwise to unsnap the [HS](#).
4. The [HS](#) removed.

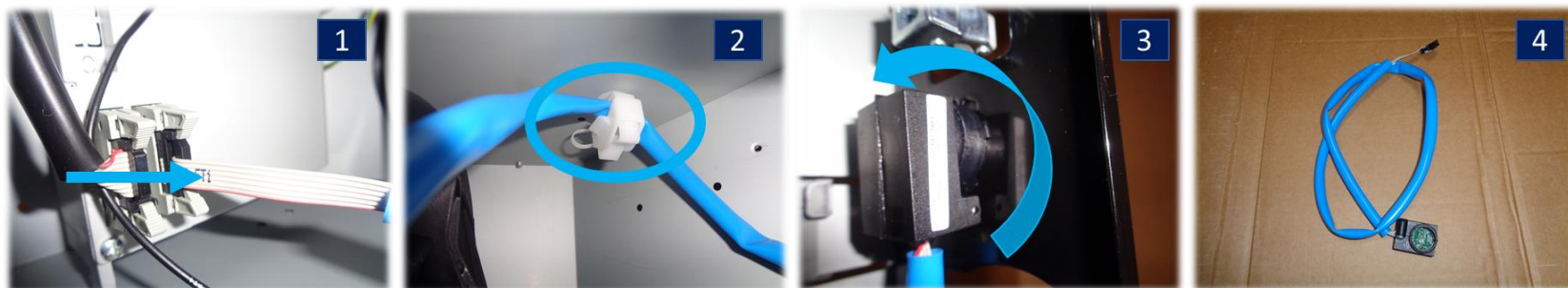

4.5 Electrical Installation Assembly

Perform chapter [4.1](#) and the 1st step of chapter [4.4](#)

! Dismount the cooking hood performing this chapter

1. Unsnap the [EIA-BA](#) connection.
2. Unsnap the [CA](#) bus cable from the [EIA](#).
3. Unsnap the Lamp cable from the [EIA](#).
4. Unfasten 2* screws which secure the [EIA](#) to the hood chassis.
5. Unsnap the [FC](#) fairlead clamp.
6. Turn the nut counter clockwise to release the grounding cable.
7. Extract the [EIA](#).
8. Unfasten 2* screws which secure the [EIA](#) cover.
9. Loosen 3* screws which secure the [FC](#) to the junction clamp.
10. The [EIA](#) removed.



4.6 Feeder Cable

Perform (5th, 8th and 9th) steps of chapter [4.5](#)

1. Extract the [FC](#).
2. The [FC](#) removed.



4.7 Frame Assembly

Perform chapter [4.1](#), the 1st step of chapter [4.2](#), the 3rd step of chapter [4.4](#) and the 2nd step of chapter [4.5](#)

! Dismount the cooking hood before performing this chapter

1. Unsnap the [CA](#) bus cable holder.
2. Unfasten 4* screws which secure the [FA](#) to the hood chassis from the front side.
3. Unfasten 4* screws which secure the [FA](#) to the hood chassis from the back side.
4. Lift the [FA](#).
5. The [FA](#) removed.

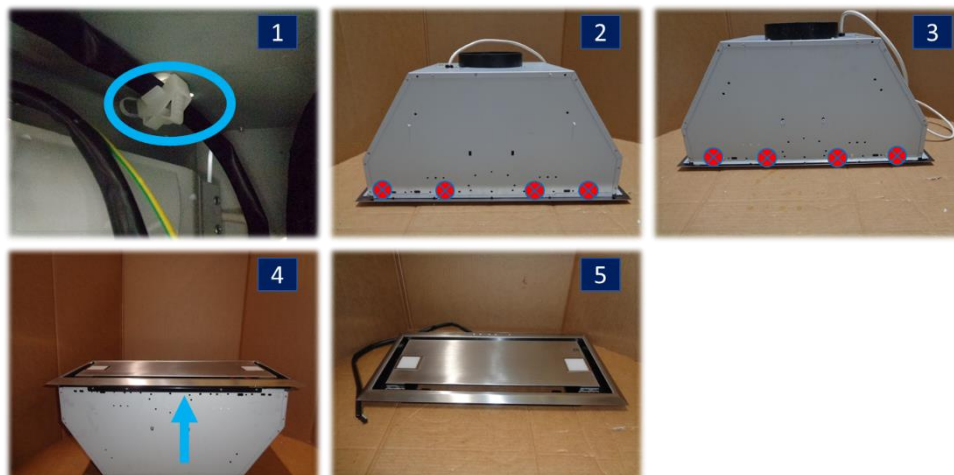

4.8 Blower Assembly

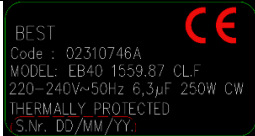
	MAX Speed	3 rd Speed	2 nd Speed	MIN Speed	Label
Motor Power(W) HF8	240	230	215	180	
Motor Power(W) EB 40	245	210	175	140	

Perform chapter [4.1](#), the 2nd step of chapter [4.4](#), (1st and 6th) steps of chapter [4.5](#) and (2nd, 3rd and 4th) steps of chapter [4.7](#)

! Dismount the cooking hood before performing this chapter

1. Unfasten 4* screws which secure the [BA](#) to the upper side of the hood chassis .
2. Unfasten 2* screws which secure the [BA](#) to the back side of the hood chassis.
3. Extract the [BA](#).
4. The [BA](#) removed.

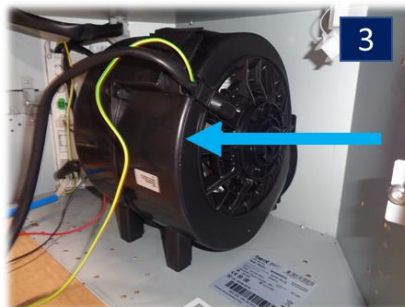

4.9 Control Assembly

Perform chapter [4.1](#), the 2nd step of chapter [4.5](#) and the 1st step of chapter [4.7](#)

1. Unfasten 2* screws which secure the [CA](#) to the [FA](#).
2. Extract the [CA](#).
3. The [CA](#) removed.

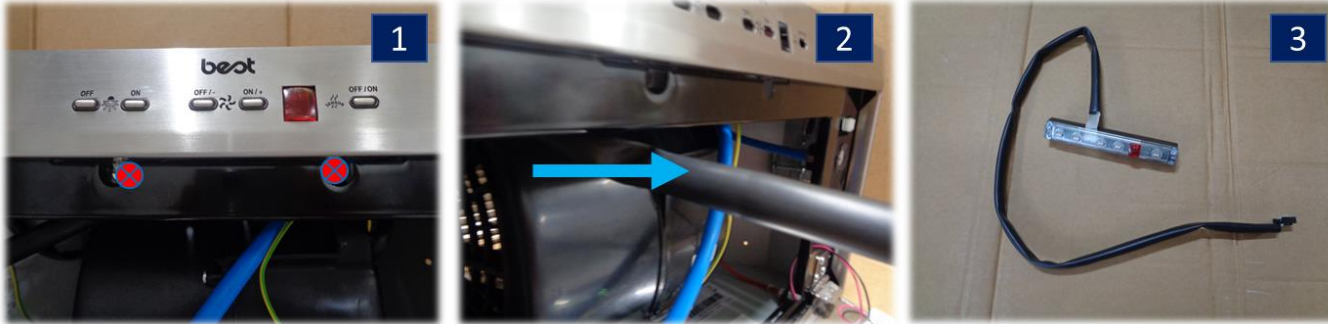

5 ELECTRICAL WIRING

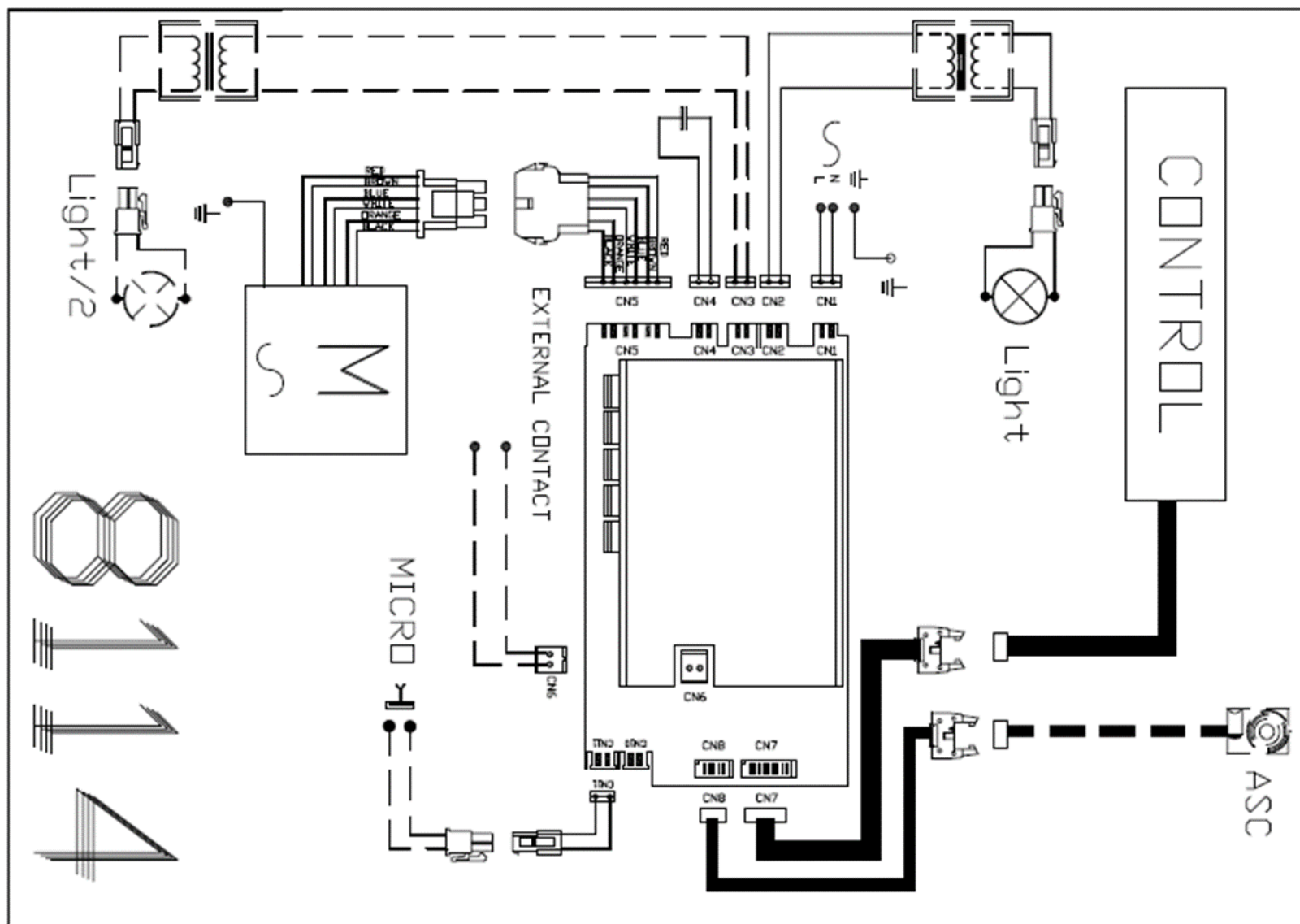

6 TROUBLESHOOTING

Term	Feeder Cable	Control Assembly	Blower Assembly	Heat Sensor	Electrical Installation Assembly
Initial	FC	CA	BA	HS	EIA

6.1 Blower Assembly

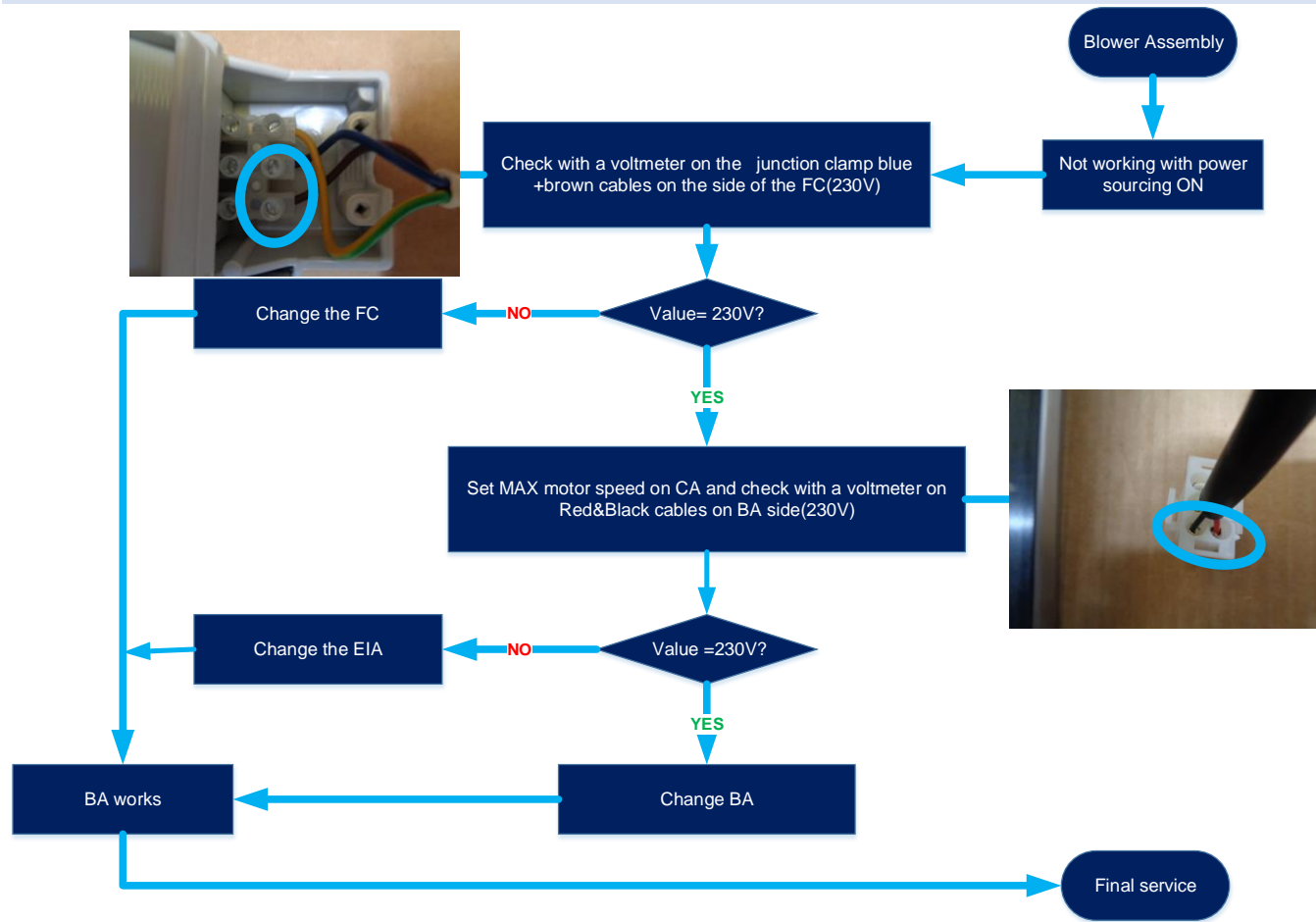

6.2 Lamp

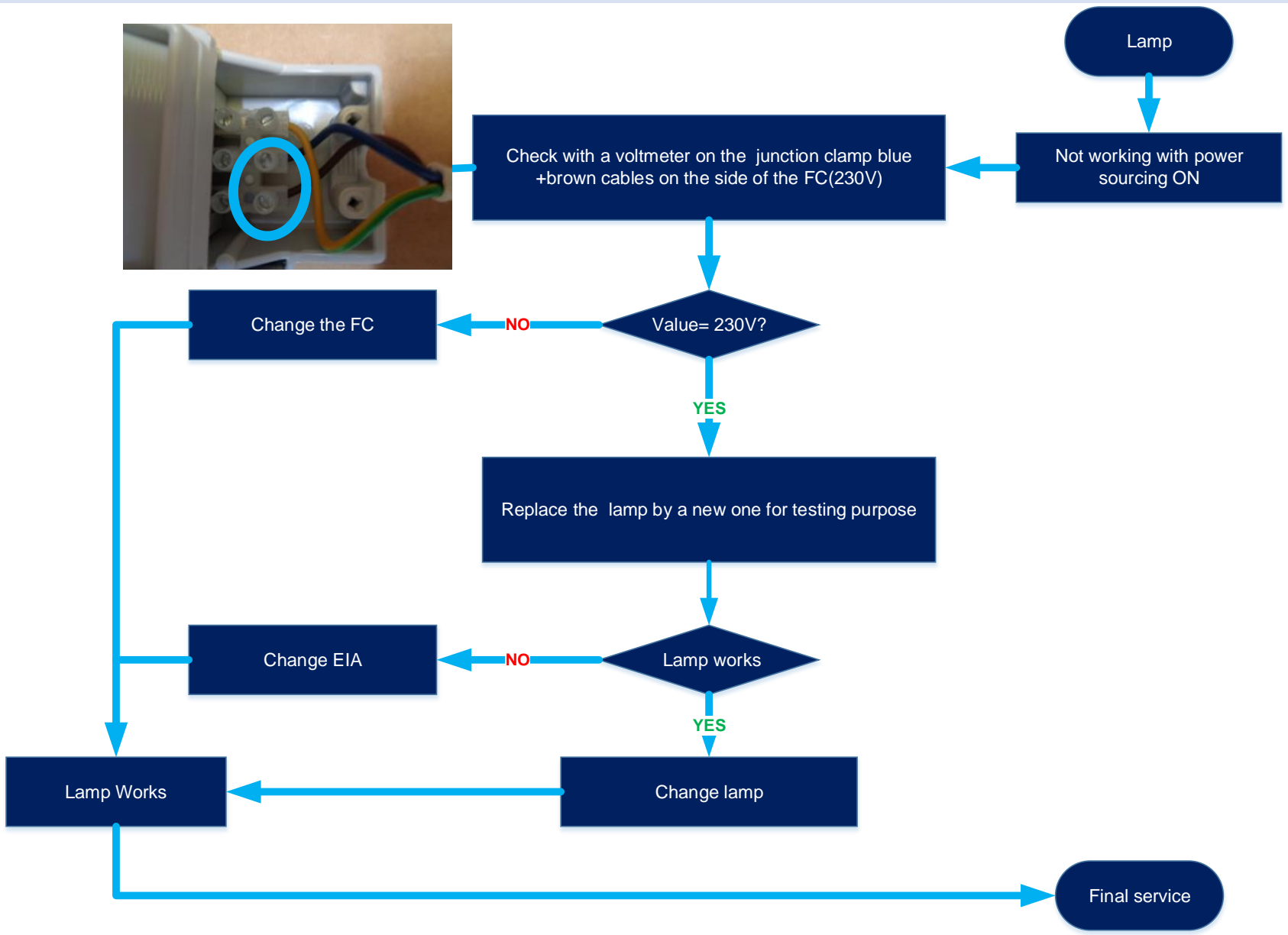

6.3 Control Assembly

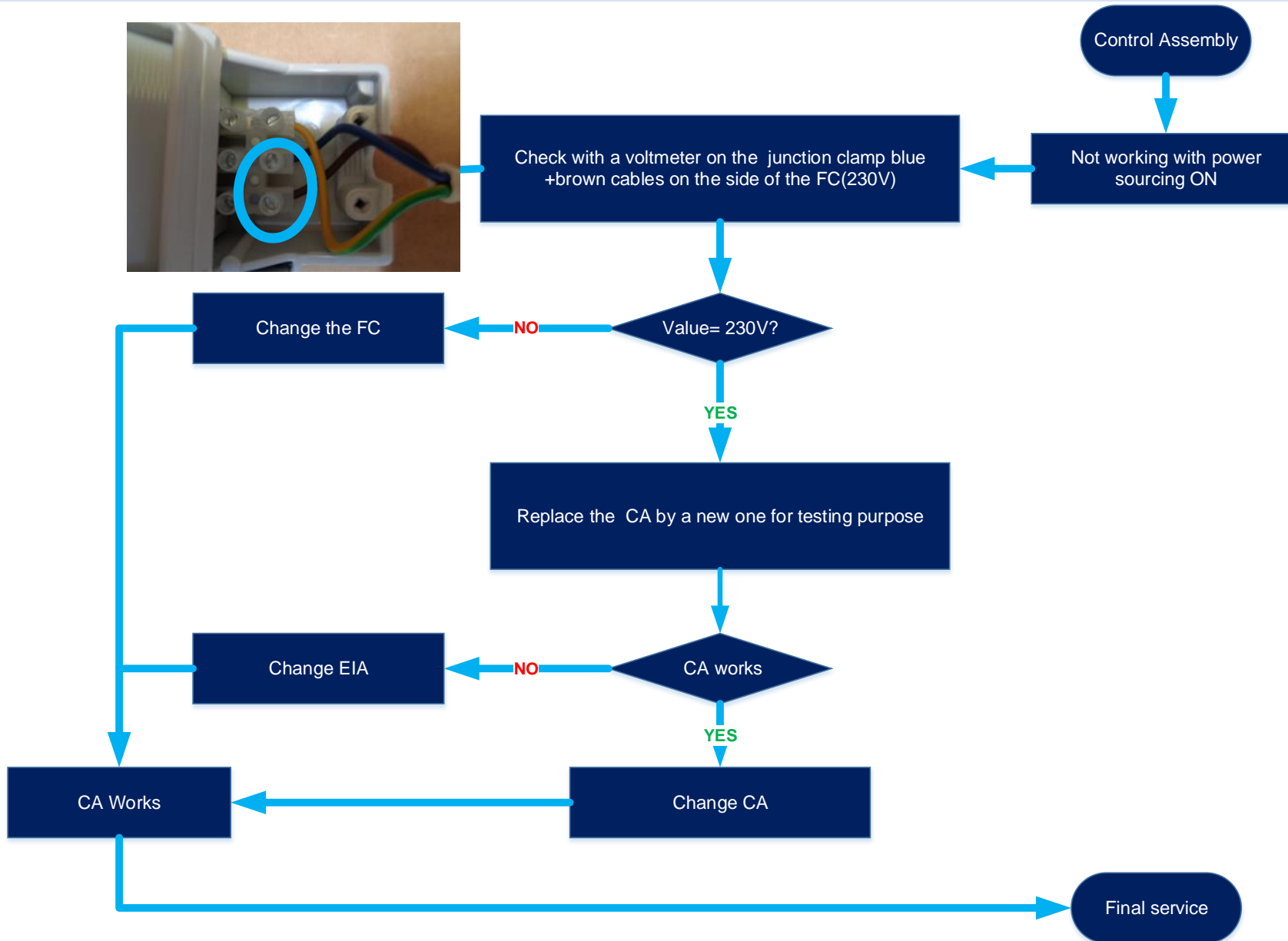

6.4 Heat Sensor

