



Electrolux

SERVICE MANUAL

COOKING

FOR INTERNAL AND PARTNERS USE ONLY

© ELECTROLUX HOME PRODUCTS

Consumer Service - EMEA

Quality & Continuous Improvement - Technical Support

RANGE HOOD

GARDA



EN

Publication number

599 819 802

Edition: 06/2018 - Rev. 00

CONTENTS

CONTENTS	1
1 PURPOSE OF THIS MANUAL	2
2 SAFETY	3
3 GARDA RANGE HOOD	4
4 ACCESSIBILITY	5
5 CIRCUIT	15
6 TROUBLESHOOTING	19

1 PURPOSE OF THIS MANUAL

The purpose of this Service Manual (SM) is to provide Service Engineers who are already familiar with the repair procedures of Hoods

This SM will provide information on:

- Hood Range
- Accessibility
- Technical and functional characteristics
- Trouble shooter

Document Revisions

Rev.	Date	Description	Author
00	05/2018	Document creation	Said Hatem

Acronyms and Abbreviations

Terms	Initialism
Stainless Steel Grease Filter	SSGF
Aluminium Grease Filter	AGF
Metal Frame Assembly	MFA
Control Assembly	CA
Slider Control Assembly	SCA
Electronic Control Assembly	ECA
Led Driver	LD
Electrical Installation Assembly	EIA
Feeder Cable	FC
Blower Assembly	BA

2 SAFETY



- All the work to be performed inside the appliance requires specific skills and knowledge and may only be carried out by qualified and authorised Service Engineers.
- Before you access internal components, take the plug out of the socket to disconnect the power supply.
- Use a pair of safety gloves to avoid sharp cuts.
- Some of the components in the mechanical part could cause injuries, so wear suitable protection and proceed with caution.
- Prior to touching the light bulbs ensure they are cooled down.

3 GARDA RANGE HOOD

3.1 Hood Features

It's a mechanical device which situated upper the cooktop, mainly contains a Blower Assembly, Grease Filters and a Control Assembly.

1	Control Assembly
2	Lamp
3	Blower Assembly
4	Grill Assembly

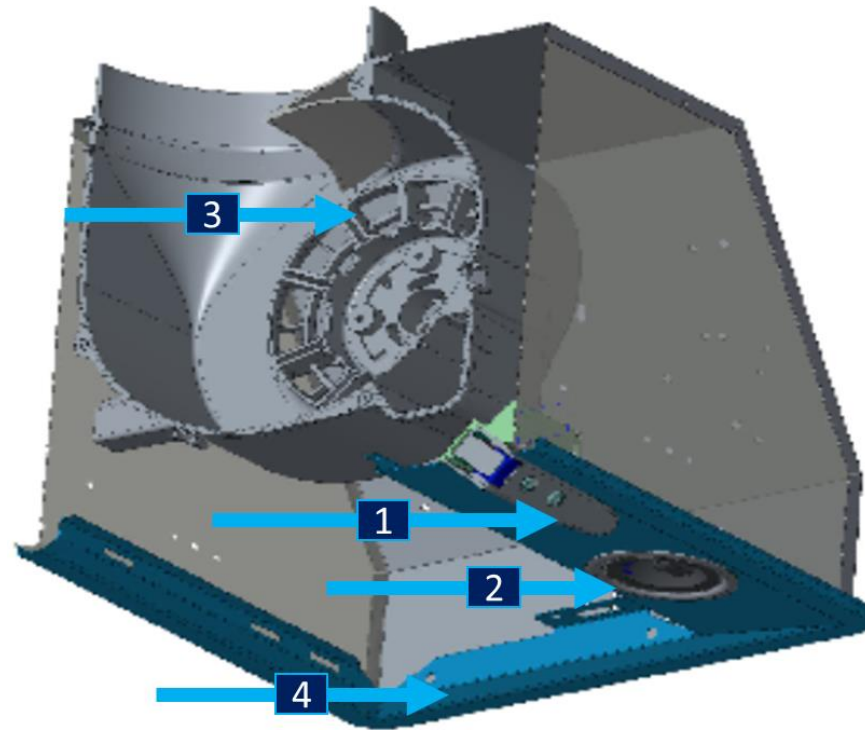

4 ACCESSIBILITY

4.1 Grease Filter

4.1.1 Stainless steel Grease Filter (SSGF)

1. Pull down the latch in the handle structure to unsnap the [SSGF](#).
2. Release the [SSGF](#) from the slots in the back side of the [MFA](#).

To place back the filter start with the 2nd step.

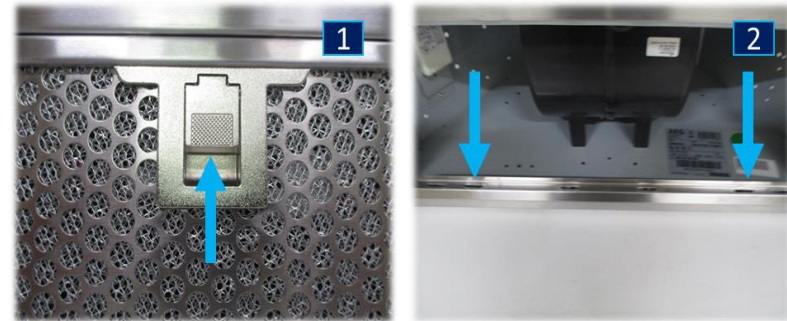

4.1.2 Aluminium Grease Filter (AGF)

1. Slide the latch in the handle structure backwards to unsnap [AGF](#).
2. Release the [AGF](#) from the slots in the back side of the [MFA](#).

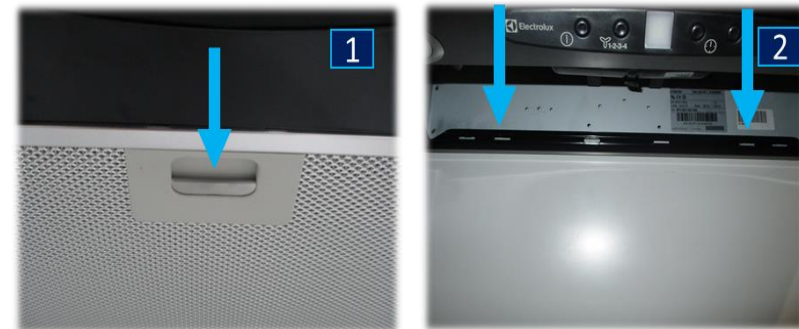

4.2 Metal Frame Assembly(MFA)

Perform Chapter [4.1](#)

1. Unsnap the Lamp connectors and pull in opposite direction.
2. Push the 2* Stops forward to unhook the [MFA](#).
3. Remove the [MFA](#).

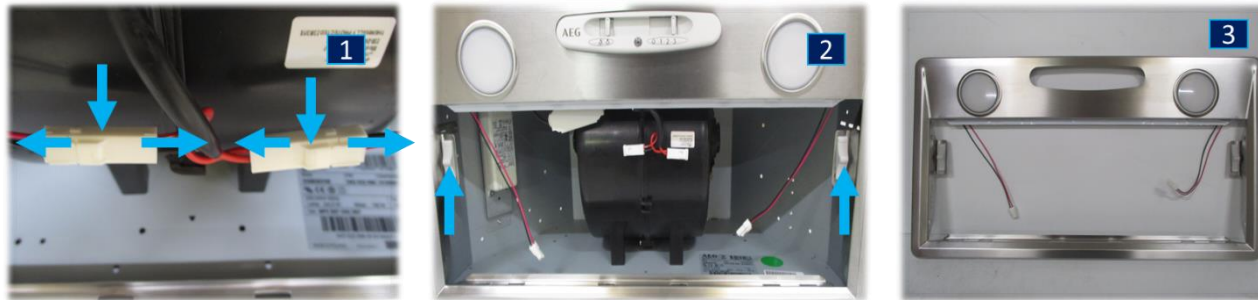

4.3 Lamp

Perform chapter [4.1](#)



! Use gloves to avoid cut

! Disconnect the power supply

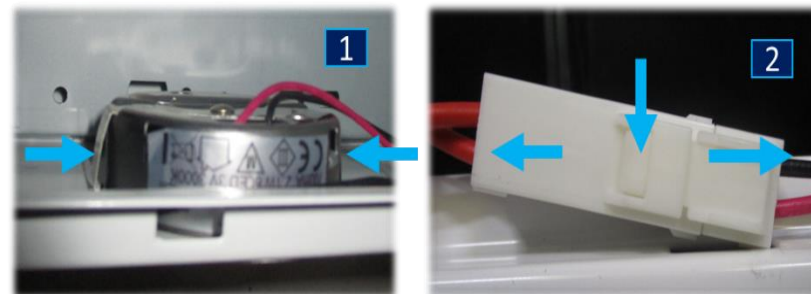
1. Unsnap the lamp from inside and push out.
2. Unsnap the Lamp connector and pull in opposite direction.



4.4 [Control Assembly\(CA\)](#)

4.4	Control Assembly	Picture	Procedure to Access
4.4.1	Slider Control Assembly	 <p>The image shows a white slider control assembly. On the left is the Electrolux logo. In the center, there are two vertical sliders. Below the sliders are several icons: a snowflake, a sun, a clock, and a lightbulb. To the right of the sliders is a circular dial with numbers 0, 1, 2, and 3.</p>	<p>See subchapter 4.4.1</p>
4.4.2	Electronic Control Assembly	 <p>The image shows a black electronic control assembly. On the left is the Electrolux logo. To its right are two circular buttons. Below these buttons is a 'Y' symbol with '1-2-3-4' underneath. In the center is a rectangular touch-sensitive area. To the right of this area are two more circular buttons, and further right is a lightbulb icon.</p>	<p>See subchapter 4.4.2</p>

4.4.1 [Slider Control Assembly\(SCA\)](#)

Perform chapter [4.1](#) and chapter [4.2](#)

1. Unfasten 2* screws which secure the [SCA](#) to the hood body.
2. Unsnap to remove the [LD](#) connection box.
3. Unsnap to disconnect the [SCA](#) from the [LD](#).
4. Cut 2* latches which collect the cables.
5. Unsnap to disconnect the [SCA](#) from the [BA](#).
6. Unfasten 1* screw which secure the Power Connection Box Cover.
7. Loosen 2* screws which secure the [SCA](#) power cables.
8. Pull out the cables from inside the hood body and extract the [SCA](#).

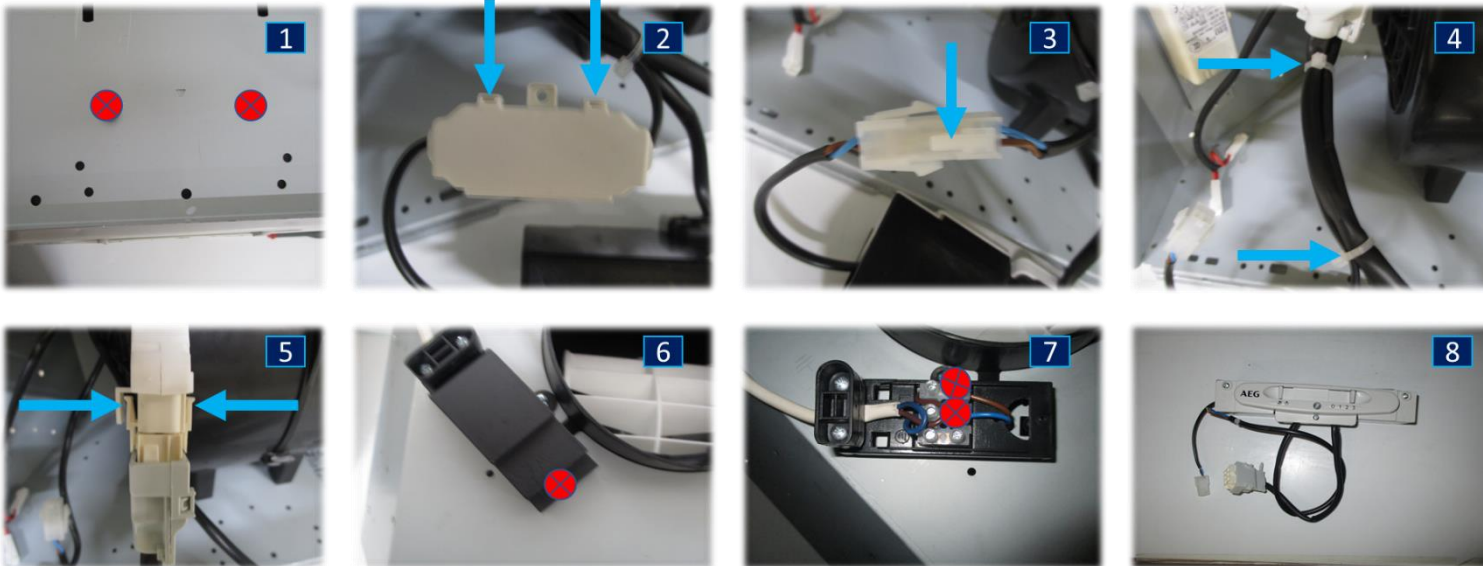

4.4.2 [Electronic Control Assembly \(ECA\)](#)

! Disconnect the power supply

Perform chapter [4.1](#) and chapter [4.2](#)

1. Unfasten 2* screws which secure the [ECA](#) to the hood body.
2. Pull out the flat cable junction.

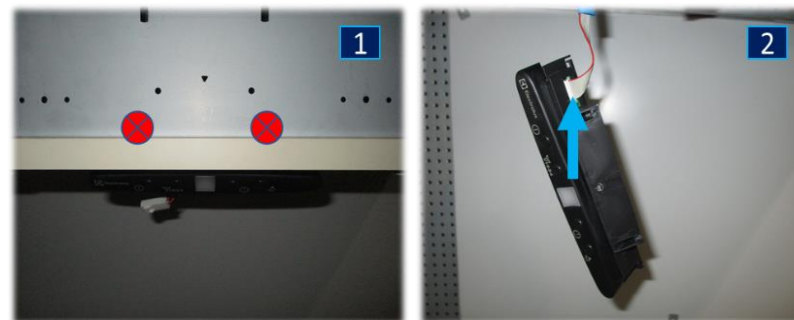

4.5 [Led Driver \(! Only for some models\)](#)

Perform chapter [4.1](#), chapter [4.2](#) and 2nd, 3rd steps of subchapter [4.4.1](#)

1. Unfasten 2* screws which secure the [LD](#) to the hood body.
2. Extract the [LD](#).



4.6 Electrical Installation Assembly(EIA)(! Only for some models)

Perform chapter [4.1](#) and chapter [4.2](#)

1. Unsnap the cables from the hooks.
2. Unfasten 1* screw which secure the [EIA](#) to the hood body.
3. Unfasten 2* screws which secure the 2* [EIA](#) covers.
4. Pull out the 2* covers.
5. Remove the 3* harnesses from the Printed Circuit Board.
6. Loosen 4* screws of grounding and power connection.
7. Remove the [EIA](#).

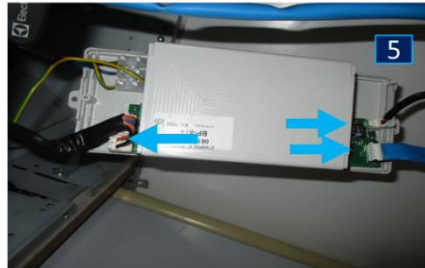
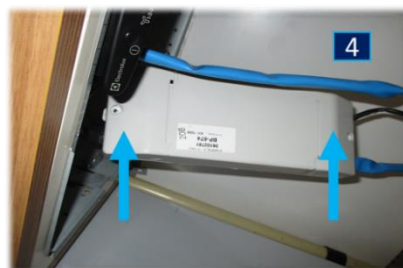
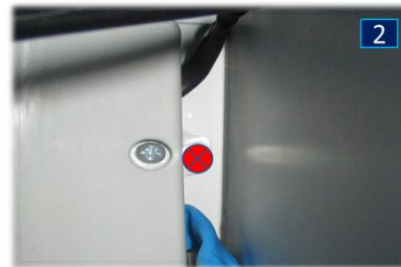

4.7 Capacitor (! Only for some models)

Perform chapter [4.1](#) and chapter [4.2](#)

1. Unfasten 2* screws of the Capacitor box cover.
2. Extract the Capacitor and the Power Connector.
3. Pull up to unsnap the cables.

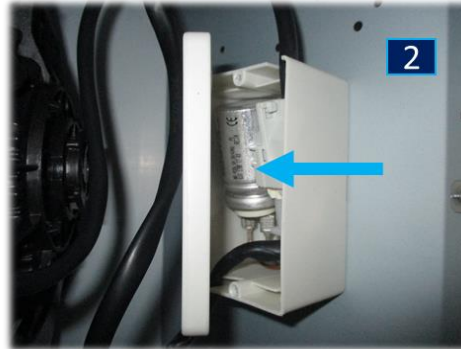

4.8 Feeder Cable (FC)

4.8.1 Slider Control Feeder Cable

Perform chapter [4.1](#) and chapter [4.2](#)

1. Unfasten 3* screws which secure the Wires Stop and the Connection Box Cover.
2. Loosen 3* screws which secure the cables to the junction clamp.

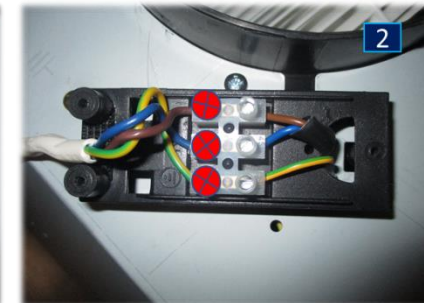

4.8.2 Electronic Control Feeder Cable

Perform chapter [4.1](#) , chapter [4.2](#) and chapter [4.6](#)

1. Unfasten 1* screw which secure the cover of the Feeder Cable connection.
2. Loosen 3* screws which secure the cables to the junction clamp.
3. Depress and lift up the cable holder.
4. Pull up to remove.

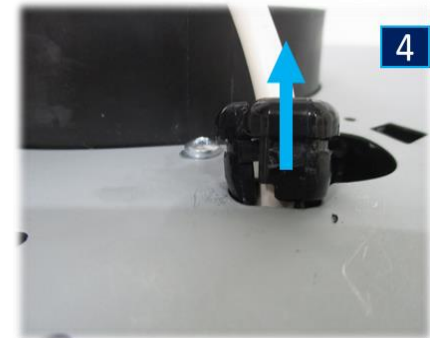
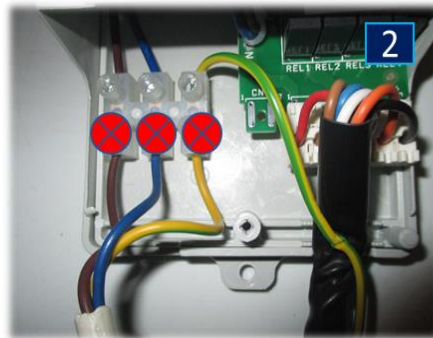

4.9 [Blower Assembly\(BA\)](#)

	EB25 D2 EL Motor Power(W)	Eb25 D2 SL Motor Power (W)	L1 D2 EL Motor Power (W)	M1 D2 SL Motor Power (W)
MAX Speed	205	205	250	145
3rd Speed	170	----	230	----
2nd Speed	150	145	190	85
MIN Speed	130	125	155	70
Label	<p>BEST S.p.A. Code : 06002303 CL.F 220-240V~50Hz 210W 5μF CW THERMALLY PROTECTED GG/M/A</p>	<p>BEST S.p.A. Code : 06002304 CL.F 220-240V~50Hz 210W 5μF CW THERMALLY PROTECTED GG/M/A</p>	<p>BEST S.p.A. Code : 06002240 CL.F 220-240V~50Hz 250W 6.3μF CW THERMALLY PROTECTED GG/M/A</p>	<p> Code : 06002244 CL.F 230-240V~50Hz 155W THERMALLY PROTECTED GG/M/A</p>



Uninstall and place the hood on an working table

Perform chapter [4.1](#) ,chapter [4.2](#) , 1st , 2nd steps of chapter [4.7](#) (! Only for some models) and 1st,2nd , 3rd ,5th steps of subchapter [4.4.1](#) , subchapter [4.4.2](#) (! Only for some models) and 1st step of chapter [4.6](#)

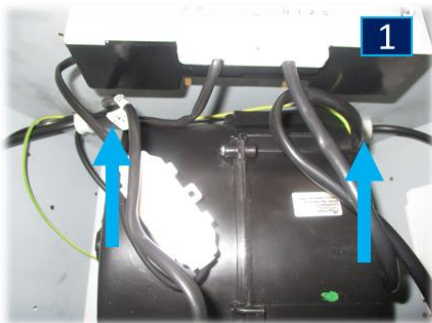
1. Unsnap the cables from the wire hooks.
2. Unfasten 2* screws which secure the [BA](#) in the back side of the hood.
3. Unfasten 4* screws which secure the [BA](#) in the upper side of the hood.
4. Turn the nut anti clockwise to release the grounding cable (! Not present in some models).
5. Extract the [BA](#).



5 CIRCUIT

5	Circuit Code Number	Circuit Links	Combinations
5.1	04808136 Motor Code: 06002240 + 06002303	5.1	 <div style="display: flex; justify-content: space-around;"> <div style="border: 1px solid black; padding: 5px; width: 45%;"> <p>BEST S.p.A. Code : 06002303 CL.F 220-240V-50Hz 210W 5µF CW THERMALLY PROTECTED GG/M/A</p> </div> <div style="border: 1px solid black; padding: 5px; width: 45%;"> <p>BEST S.p.A. Code : 06002240 CL.F 220-240V-50Hz 250W 6.3µF CW THERMALLY PROTECTED GG/M/A</p> </div> </div>
5.2	04808999 Motor Code: 06002304	5.2	 <div style="border: 1px solid black; padding: 5px; width: 60%; margin-left: auto;"> <p>BEST S.p.A. Code : 06002304 CL.F 220-240V-50Hz 210W 5µF CW THERMALLY PROTECTED GG/M/A</p> </div>
5.3	04808692 Motor Code: 06002244	5.3	 <div style="border: 1px solid black; padding: 5px; width: 60%; margin-left: auto;"> <p>ELEKTROMECH by best Code : 06002244 CL.F 230-240V~50Hz 155W THERMALLY PROTECTED GG/M/A</p> </div>

5.1 [Circuit 04808136](#)

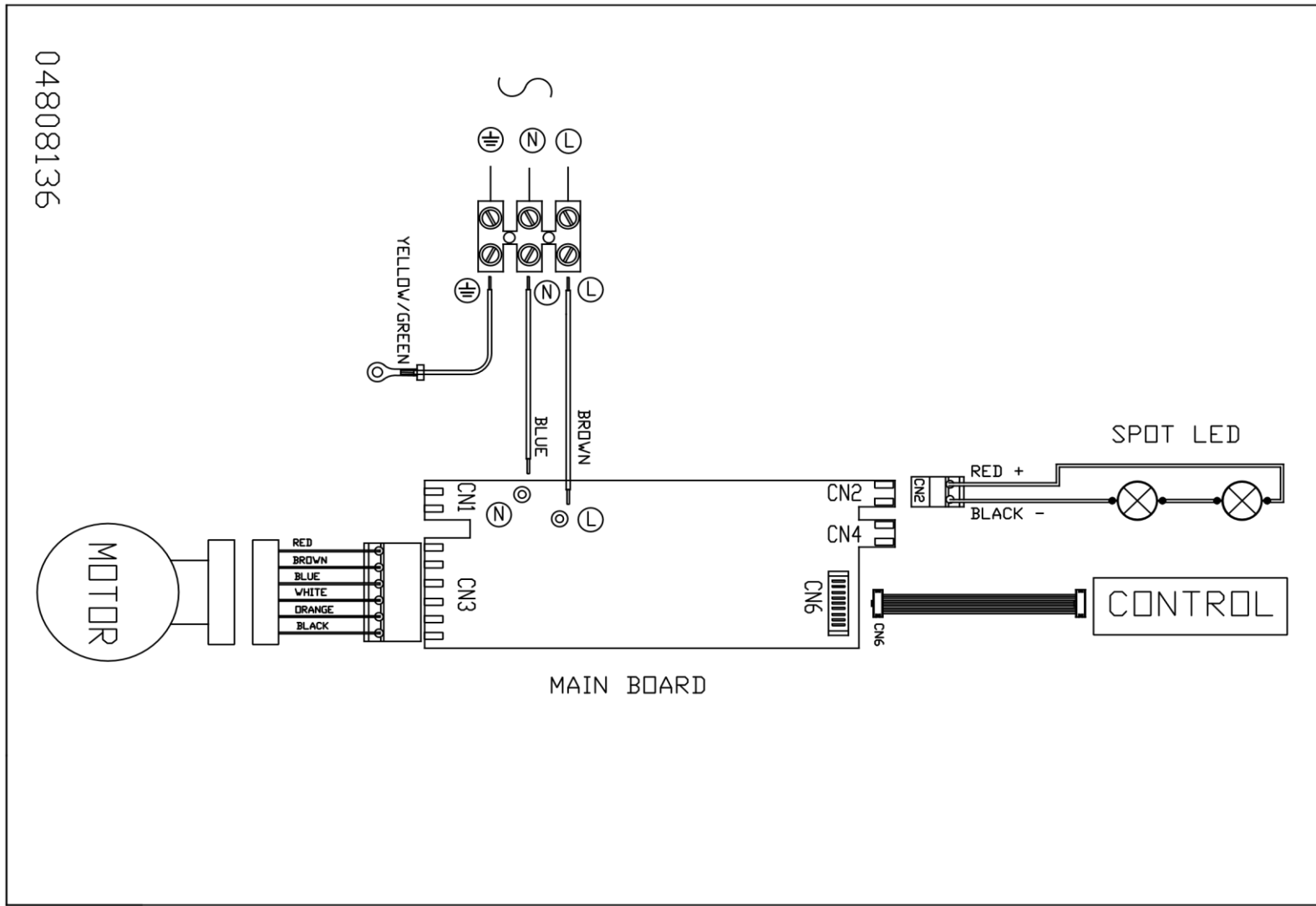

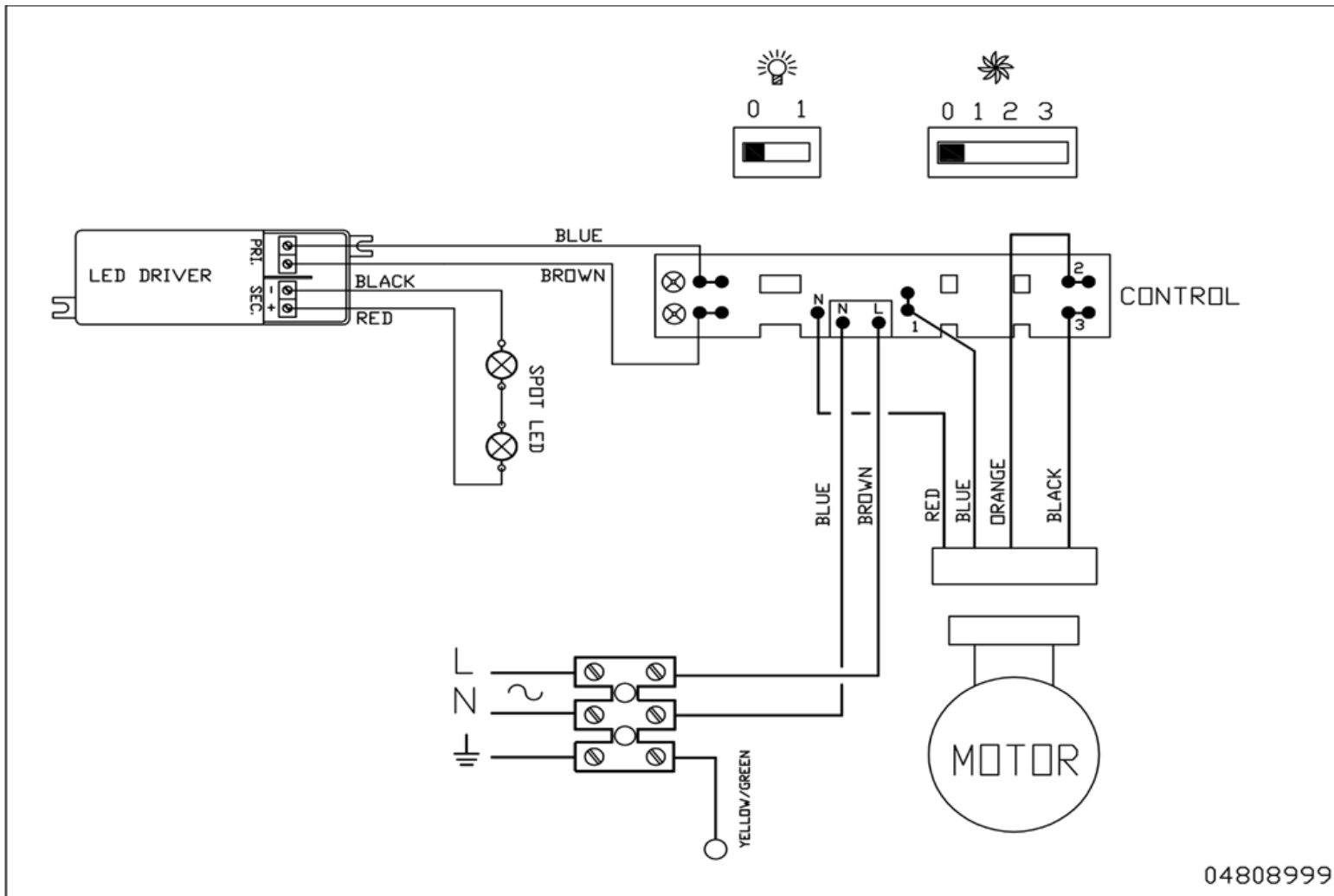

5.2 [Circuit 04808999](#)

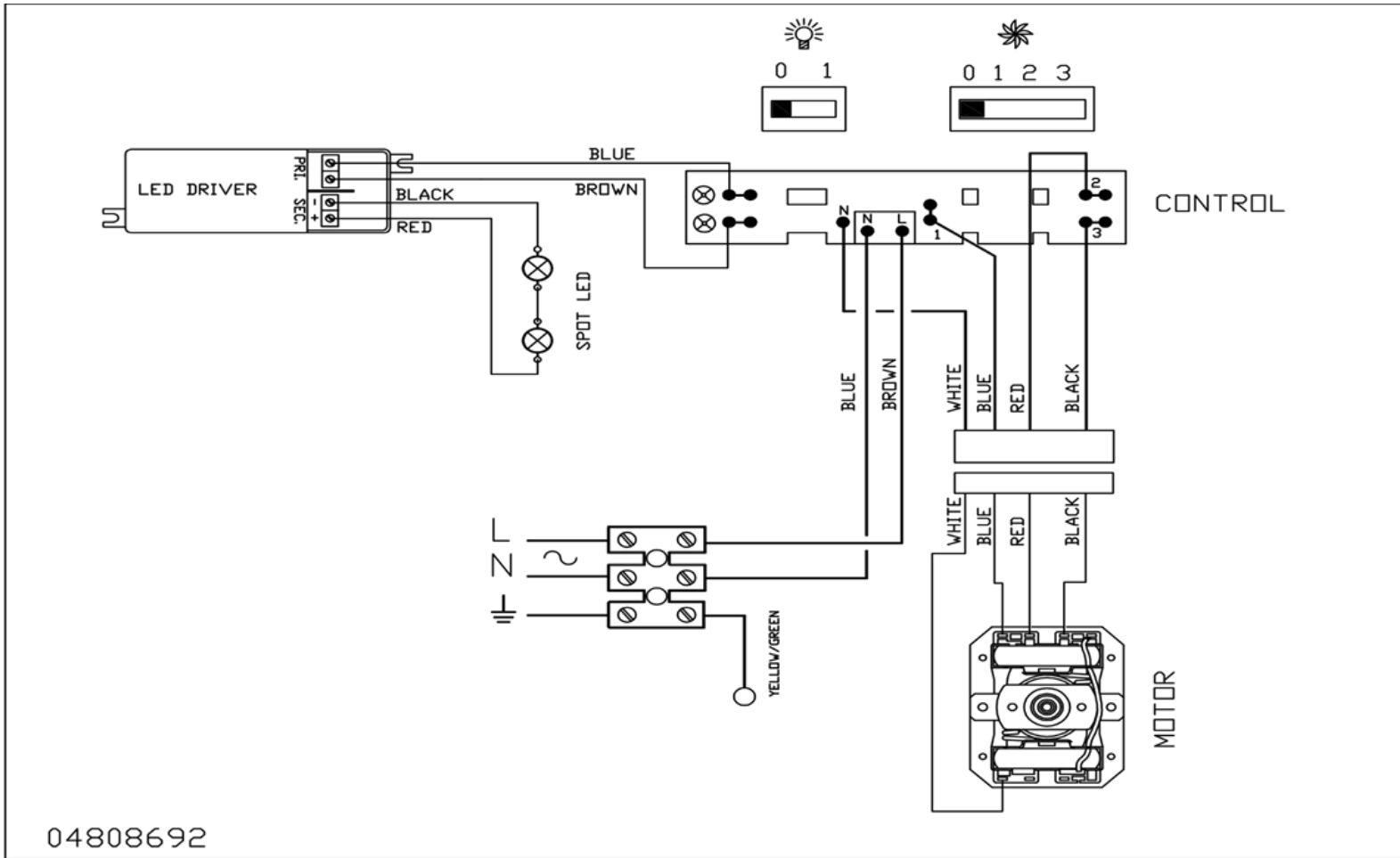

5.3 [Circuit 04808692](#)



6 TROUBLESHOOTING

	Model	Blower Assembly	Lamp	Control Assembly
6.1	P550 M1 D2 SL & P550 EB25 D2 SL	6.1.1 <div style="border: 1px solid black; padding: 5px; width: fit-content;"> BEST S.p.A. Code : 06002304 CL.F 220-240V~50Hz 210W 5µF CW THERMALLY PROTECTED GG/M/A </div> <div style="border: 1px solid black; padding: 5px; width: fit-content; margin-left: 20px;">  Code : 06002244 CL.F 230-240V~50Hz 155W THERMALLY PROTECTED GG/M/A </div>	6.1.2	6.1.3 
6.2	P580 L1 D2 EL & P780 EB25 D2 EL	6.2.1 <div style="border: 1px solid black; padding: 5px; width: fit-content;"> BEST S.p.A. Code : 06002240 CL.F 220-240V~50Hz 250W 6.3µF CW THERMALLY PROTECTED GG/M/A </div> <div style="border: 1px solid black; padding: 5px; width: fit-content; margin-left: 20px;"> BEST S.p.A. Code : 06002303 CL.F 220-240V~50Hz 210W 5µF CW THERMALLY PROTECTED GG/M/A </div>	6.2.2	6.2.3 

Acronyms

TERMS	INITIALISM
Printed Circuit Board	PCB
Electrical Installation Assembly	EIA

6.1 Slider Control Models

6.1.1 Blower assembly

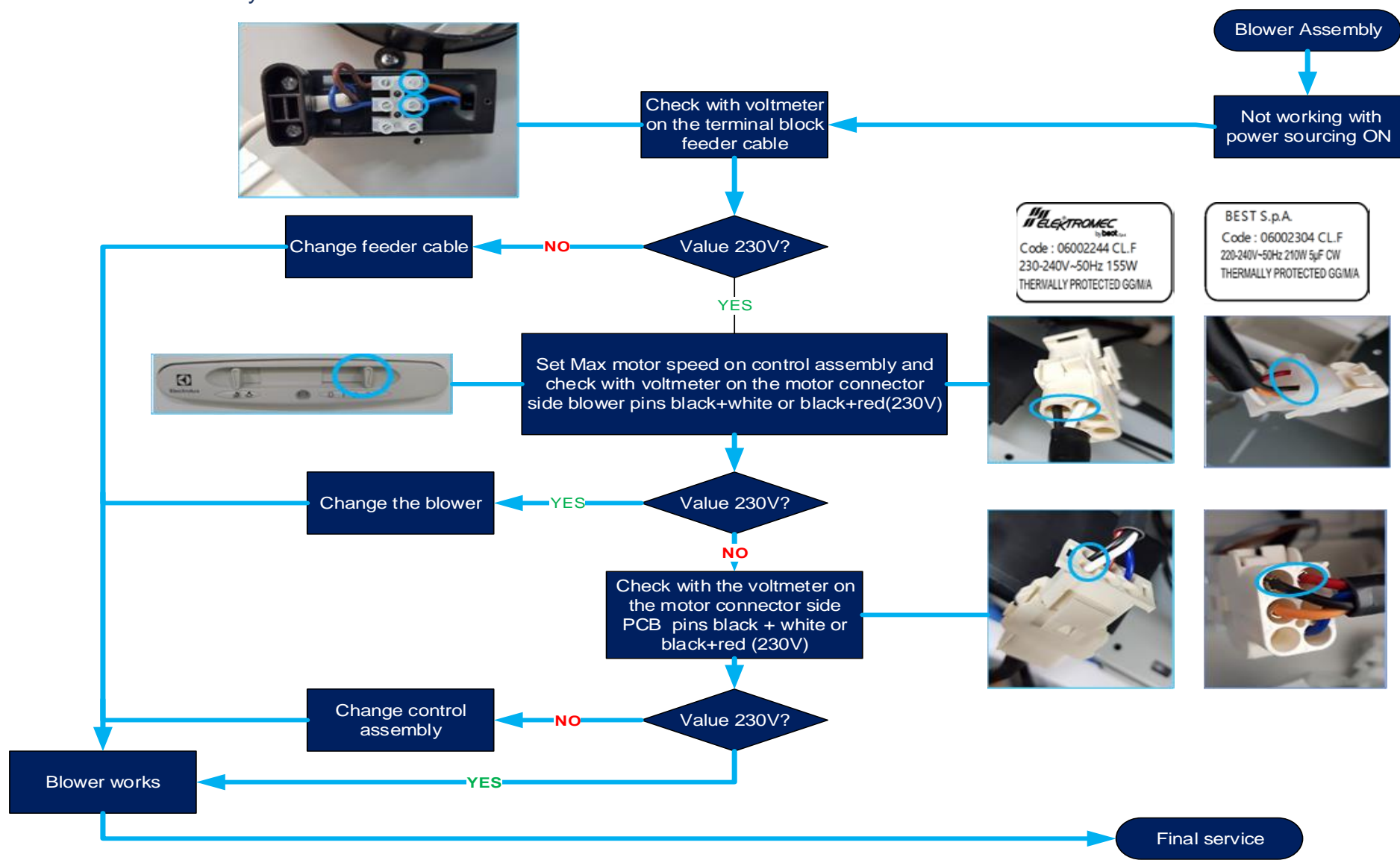

6.1.2 Lamp

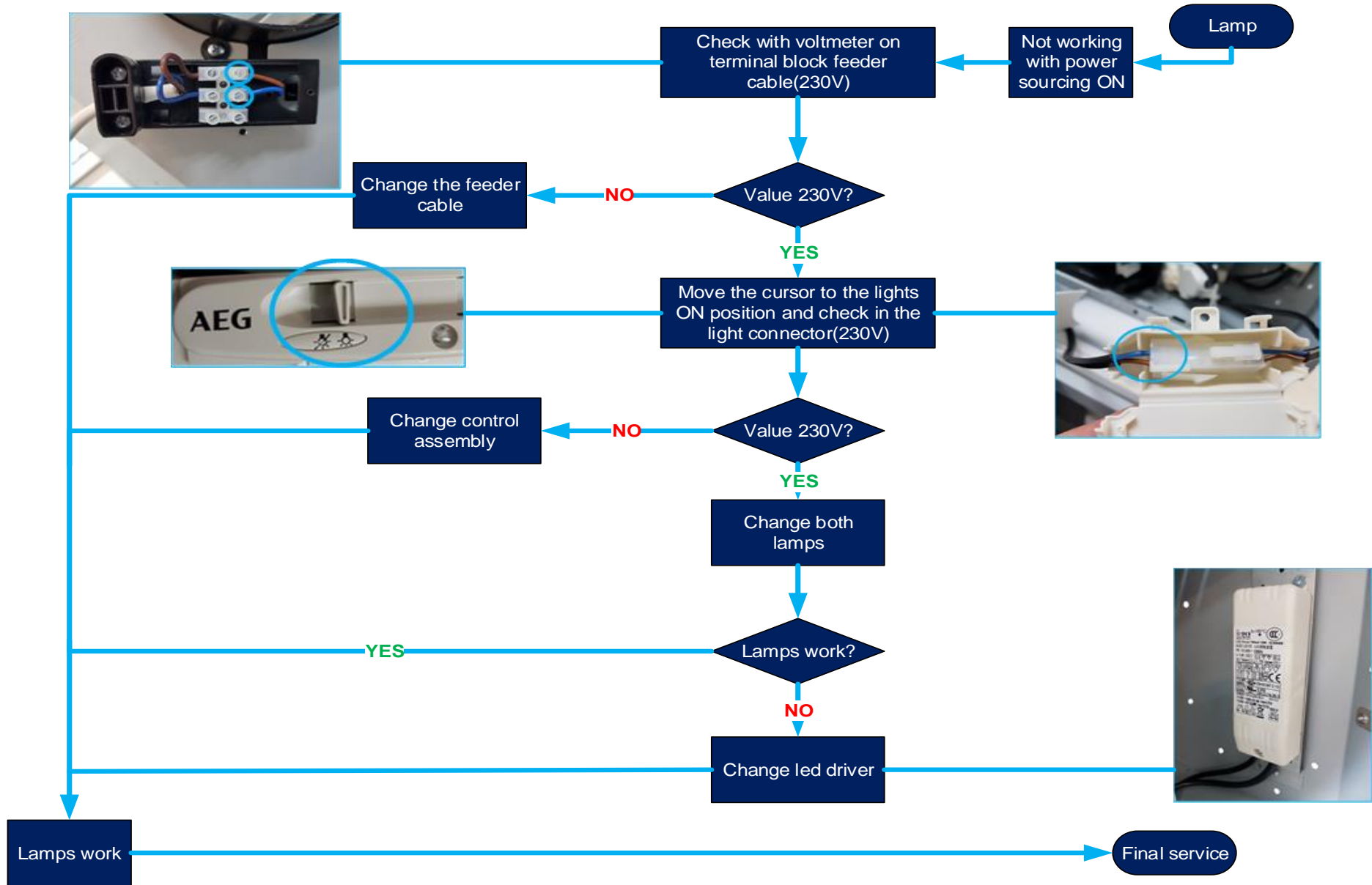

6.1.3 Control Assembly

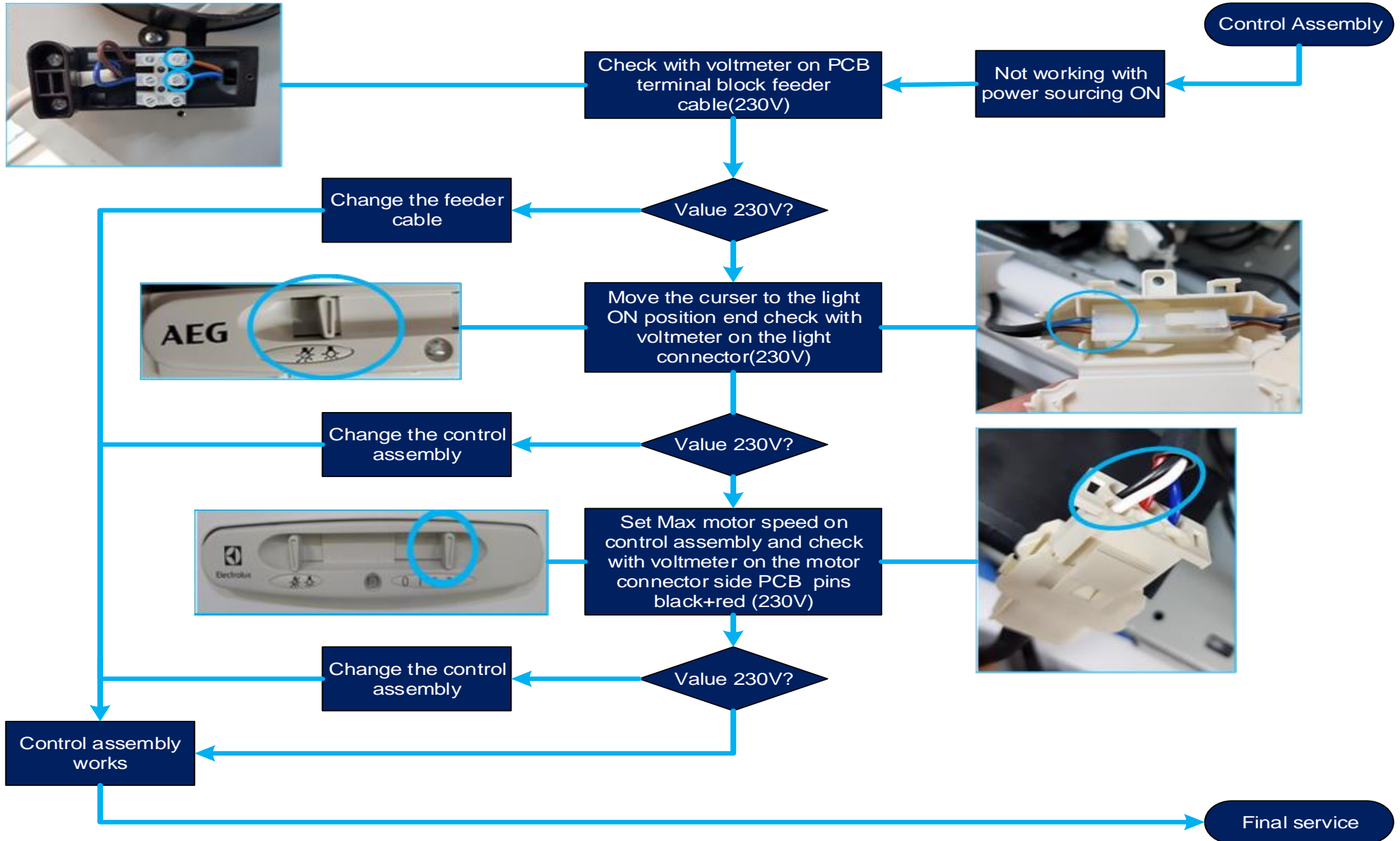

6.2 Electronic Control Models

6.2.1 Blower Assembly

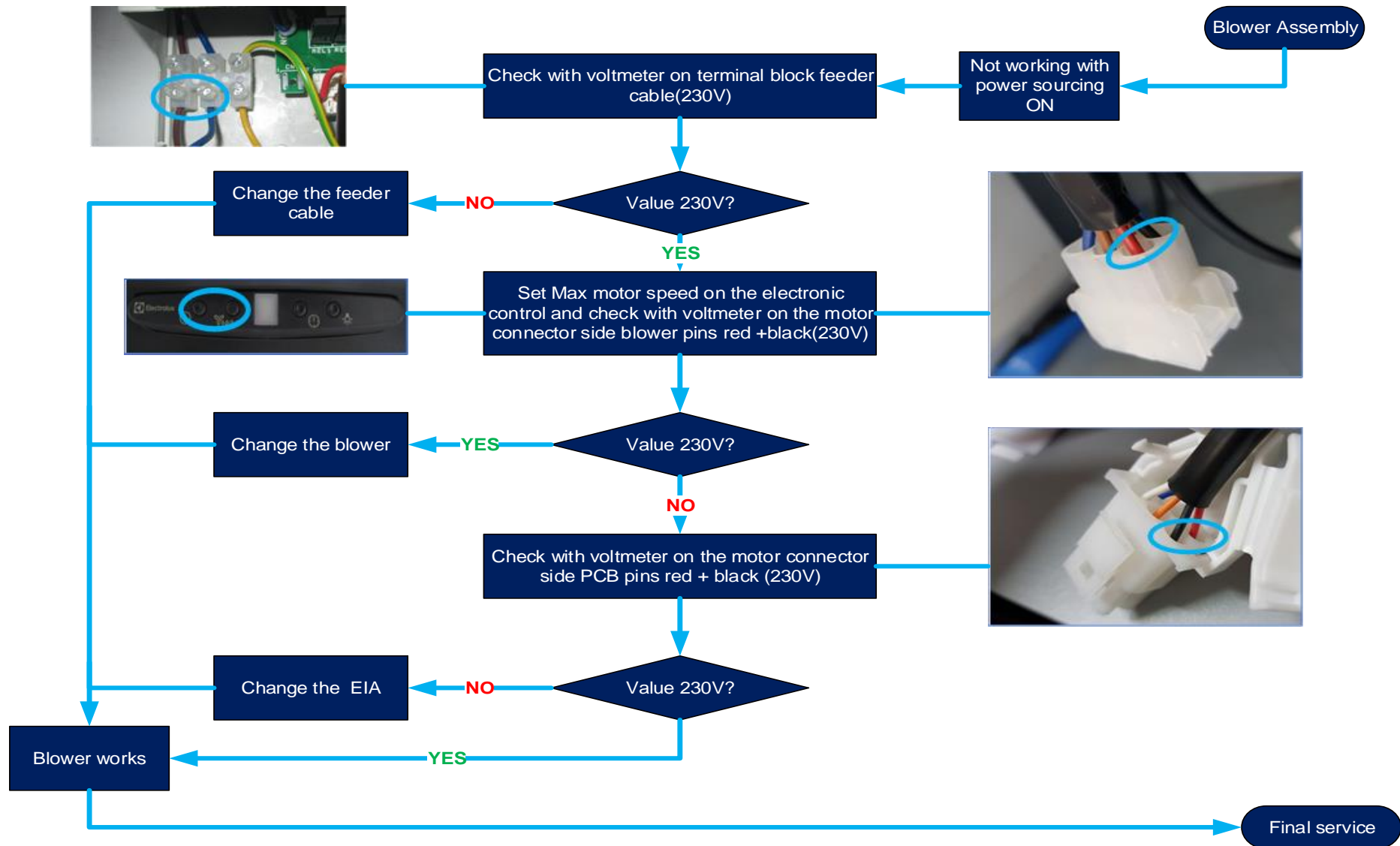

6.2.2 Lamp

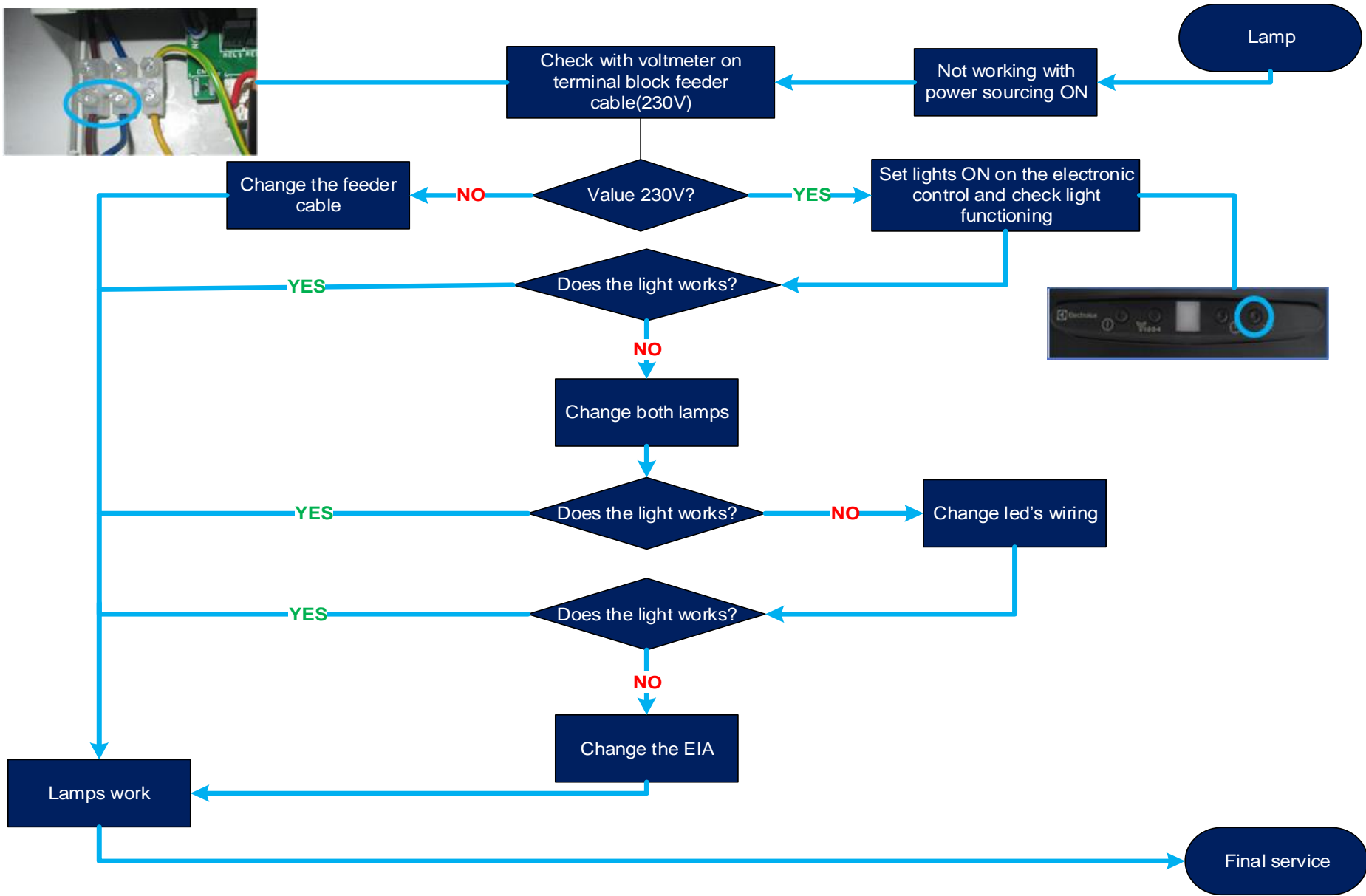
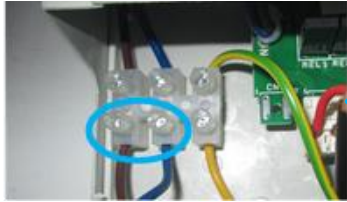

6.2.3 Control Assembly

