



# Electrolux

## SERVICE MANUAL COOKING

FOR INTERNAL AND PARTNERS USE ONLY

© ELECTROLUX HOME PRODUCTS  
Consumer Service - EMEA  
Quality & Continuous Improvement - Technical Support

HOOD  
WIN Range



EN

Publication number  
599 817-071  
Edition: 03/2018 - Rev. 00

# CONTENTS

CONTENTS	1
1 PURPOSE OF THIS MANUAL	2
2 SAFETY	3
3 WIN RANGE HOOD	4
4 ACCESSIBILITY	5
5 CIRCUIT	11
6 TROUBLE SHOOTING	12

# 1 PURPOSE OF THIS MANUAL

The purpose of this Service Manual (SM) is to provide Service Engineers who are already familiar with the repair procedures of Hoods

This SM will provide information on:

- Hood Range
- Accessesbility
- Technical and functional characteristics
- Trouble shooter

## Document Revisions

Rev.	Date	Description	Author
00	03/2018	Document creation	Hatem Said

## 2 SAFETY



- All the work to be performed inside the appliance requires specific skills and knowledge and may only be carried out by qualified and authorised Service Engineers
- Before you access internal components, take the plug out of the socket to disconnect the power supply.
- Use pair of safety gloves to avoid sharp cuts
- Some of the components in the mechanical part could cause injuries, so wear suitable protection and proceed with caution.

## 3 WIN RANGE HOOD

### 3.1 Hood Features

It's a mechanical Hob with Blower assembly, Lights, Switch buttons to operate the electrical components

1	Control Assembly
2	Light Diffuser & Lamp
3	Grease Filter
4	Blower Assembly

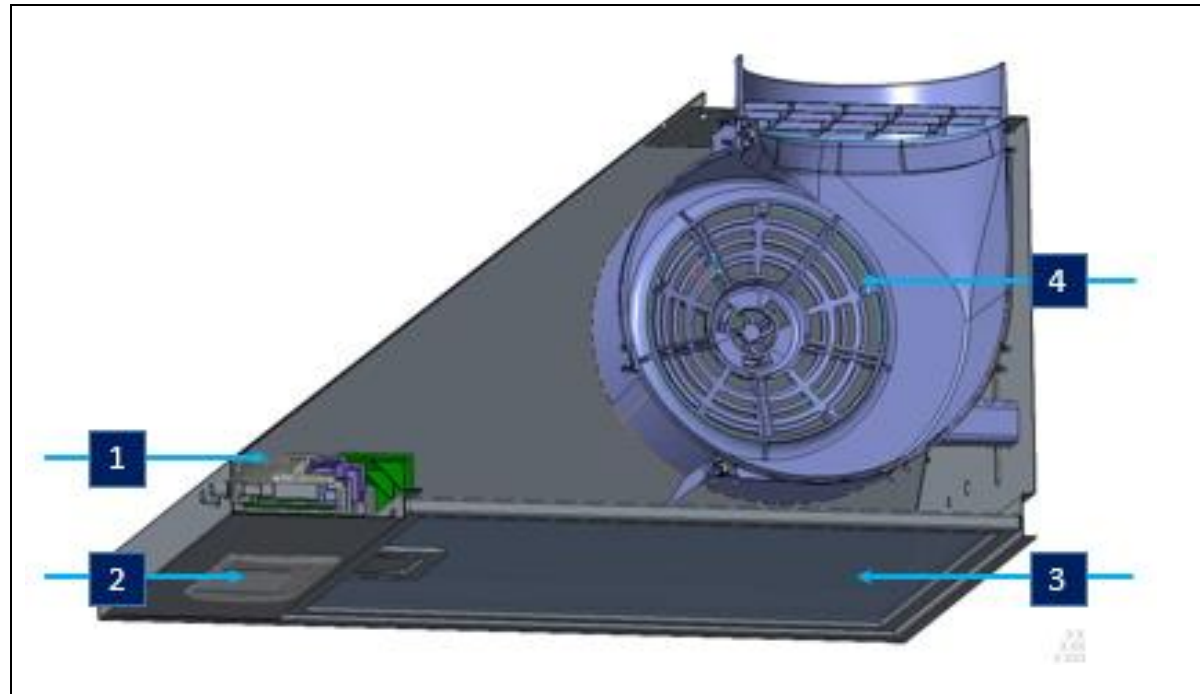

## 4 ACCESSIBILITY

### 4.1.1 Grease Filter

1. Slide the Handle structure down to unsnap the grease filter for accessing the internal components or for cleaning
2. Guide projections on the filter side and guide on the body flange to support the filter assembly.

Placing back the Grease Filter: Start with the step 2 placing the guide projections in the guide and snap the handle lock

! Depending on the size of the Hood, number of filters vary

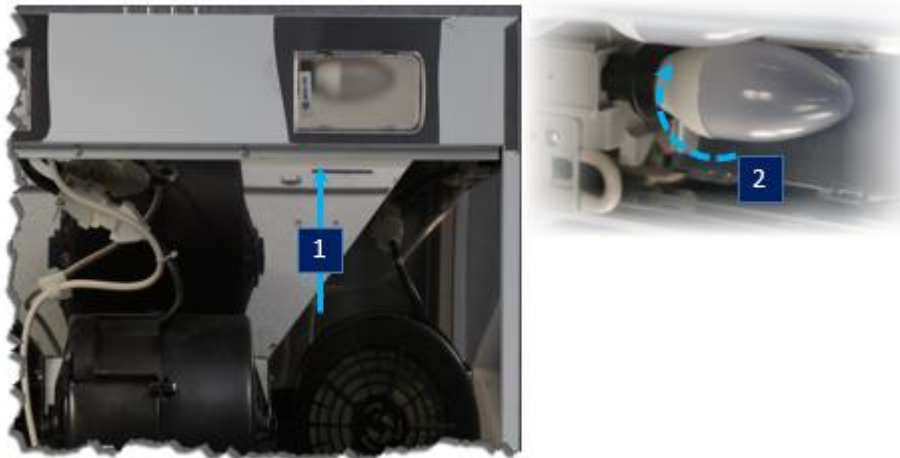

### 4.1.2 Lamp bulb

Perform the Step 1 of chapter 4.1.1 to access the bulb

1. Reach the bulb by hand after opening the grease Filter
2. Turn the bulb with anti-clock rotations for taking it out and clock rotation for fixing it back

! Assure that power cable is plugged out  
! Check if the Lamp is hot

### 4.1.3 Light Diffuser

Perform the Step 1 of chapter [4.1.1](#) and steps of [4.1.2](#) to access the Light Diffuser

1. Reach the Light Diffuser by hand after opening the grease Filter and removing the bulb
2. Unsnap two snaps and push it down to remove

! Have work gloves to avoid the cuts when you unsnap

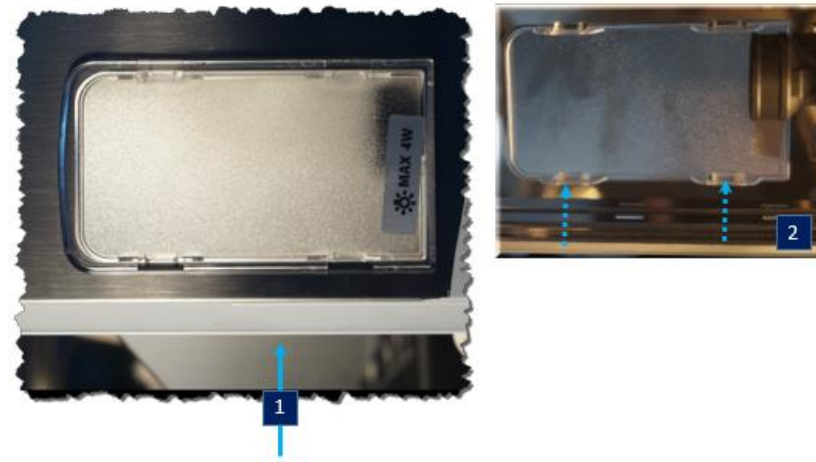

#### 4.1.4 Blower Assembly

Perform the Step 1 of chapter 4.1.1 to access the Blower Assembly

1. Press the snaps ( one snap is covered with flange of connector )
2. Pull the connector in opposite direction
3. Lift the lower telescopic Pipe
4. Unfasten Blower top N°4 Screws

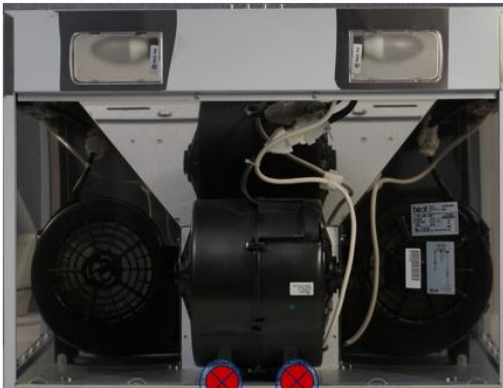
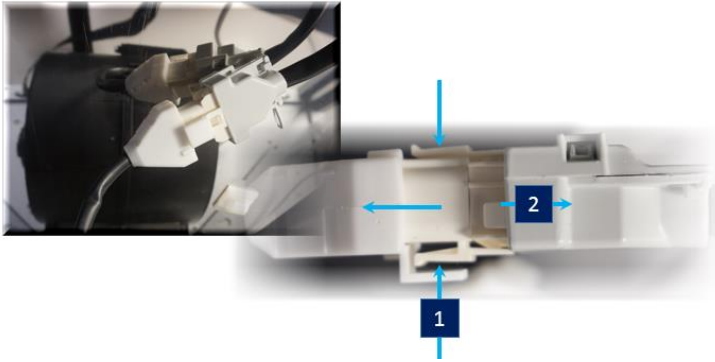

5. Unfasten the Blower side N°2 Screws

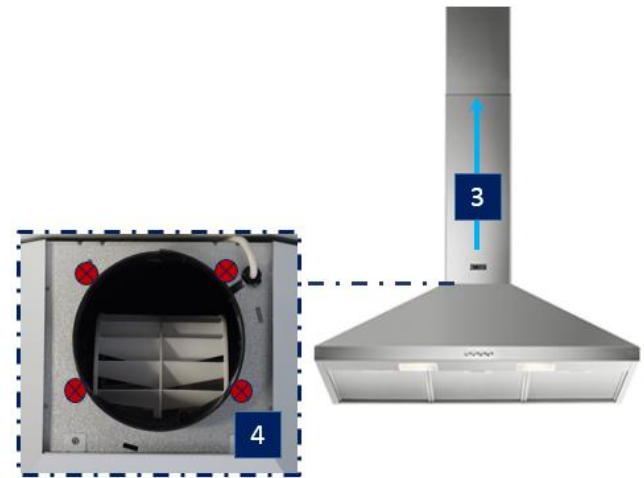



## 4.1.5 Feeder Cable

Perform the step 3 in chapter 4.1.4 (Lift the lower telescopic Pipe) to access the Feeder cable

6. Lift the plastic cable holder in the direction of the telescopic pipe
7. Unsnap the plastic cable holder to release the Feeder Cable
8. Release the Feeder cable from the Cable hook

Check Chapter 4.1.6 for removing the other end of Feeder Cable

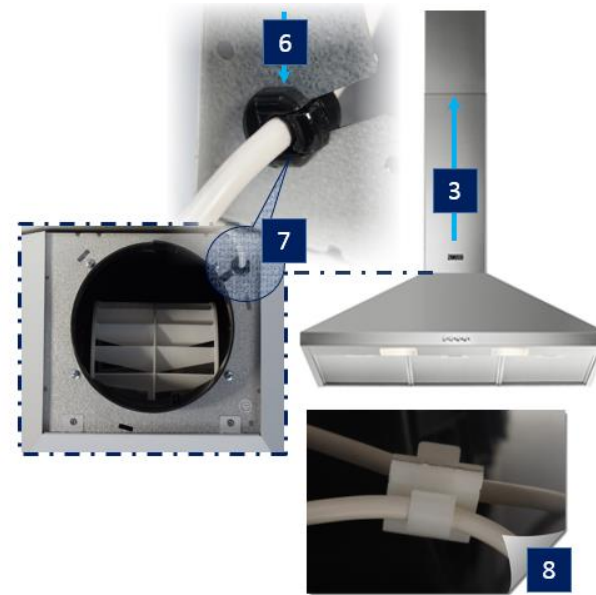

## 4.1.6 Control Assembly

Perform step 1 in chapter 4.1.1 to remove the Grease Filter and Chapter 4.1.5 to remove the Feeder cable

1. Unfasten the N°2 Screws
2. Slide the EIA out of hood to access the PCB and the harness

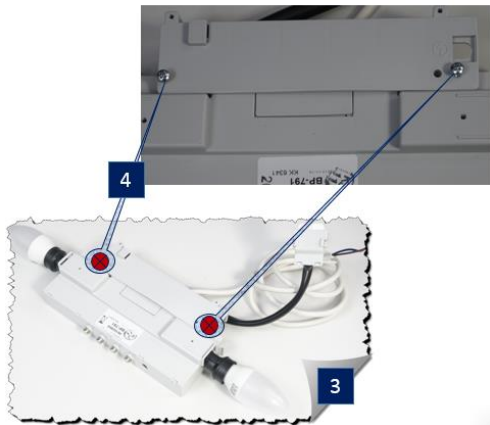

3. Place the EIA on a work place
4. Unfasten the N°2 Screws on EIA to remove the holder

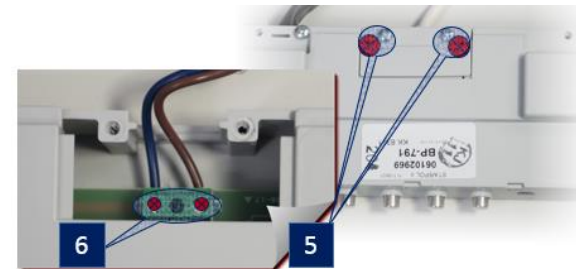
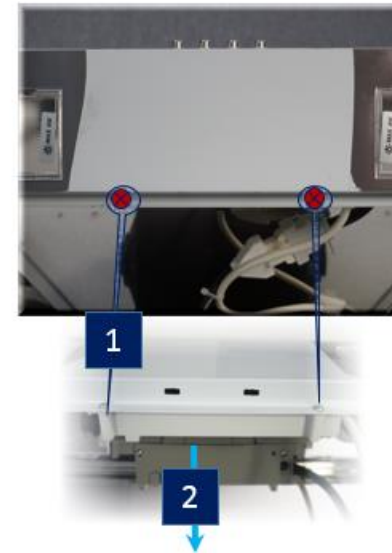
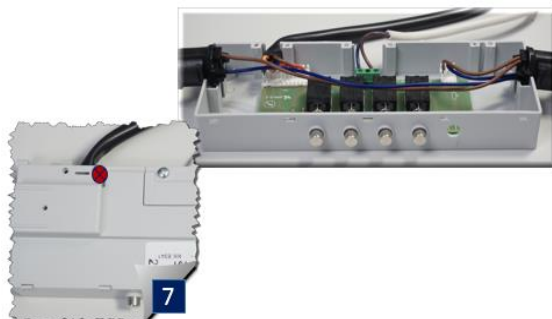

5. Unfasten the N°2 Screws to access the Feeder cable other end
6. Unfasten the N°2 Screws to remove the Feeder cable
7. Unfasten the N°2 Screws to access the PCB and the harness

## 4.2 PCB

Perform 7<sup>th</sup> step in chapter 4.1.6 to access PCB and harness

### 4.2.1 PCB connections

1. Feeder cable (mains power)
2. Power to Blower Assembly
3. Power to Light Assembly

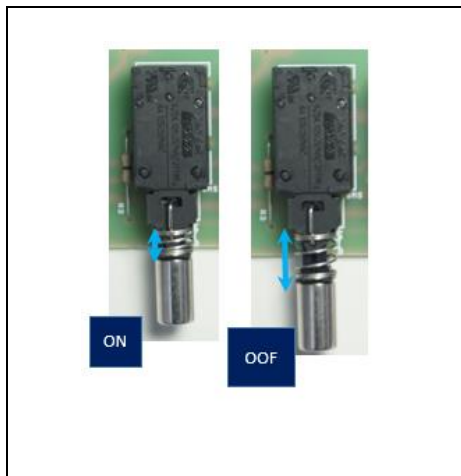
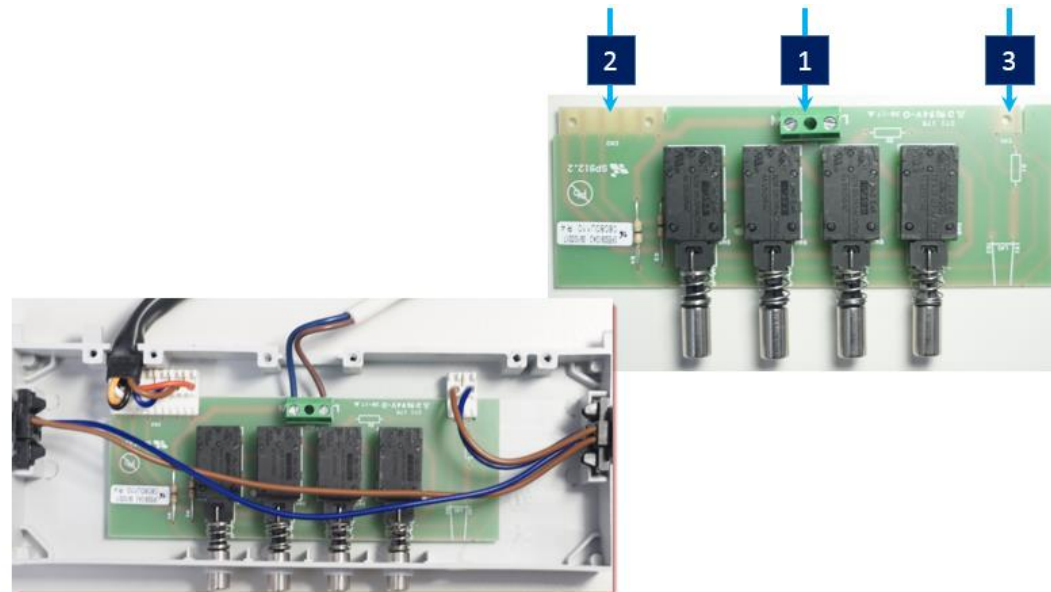

### 4.2.2 Accessing PCB

Remove all the harness

1. Keep all the Buttons in the ON position
2. Lift the PCB in an angular position

# 5 CIRCUIT

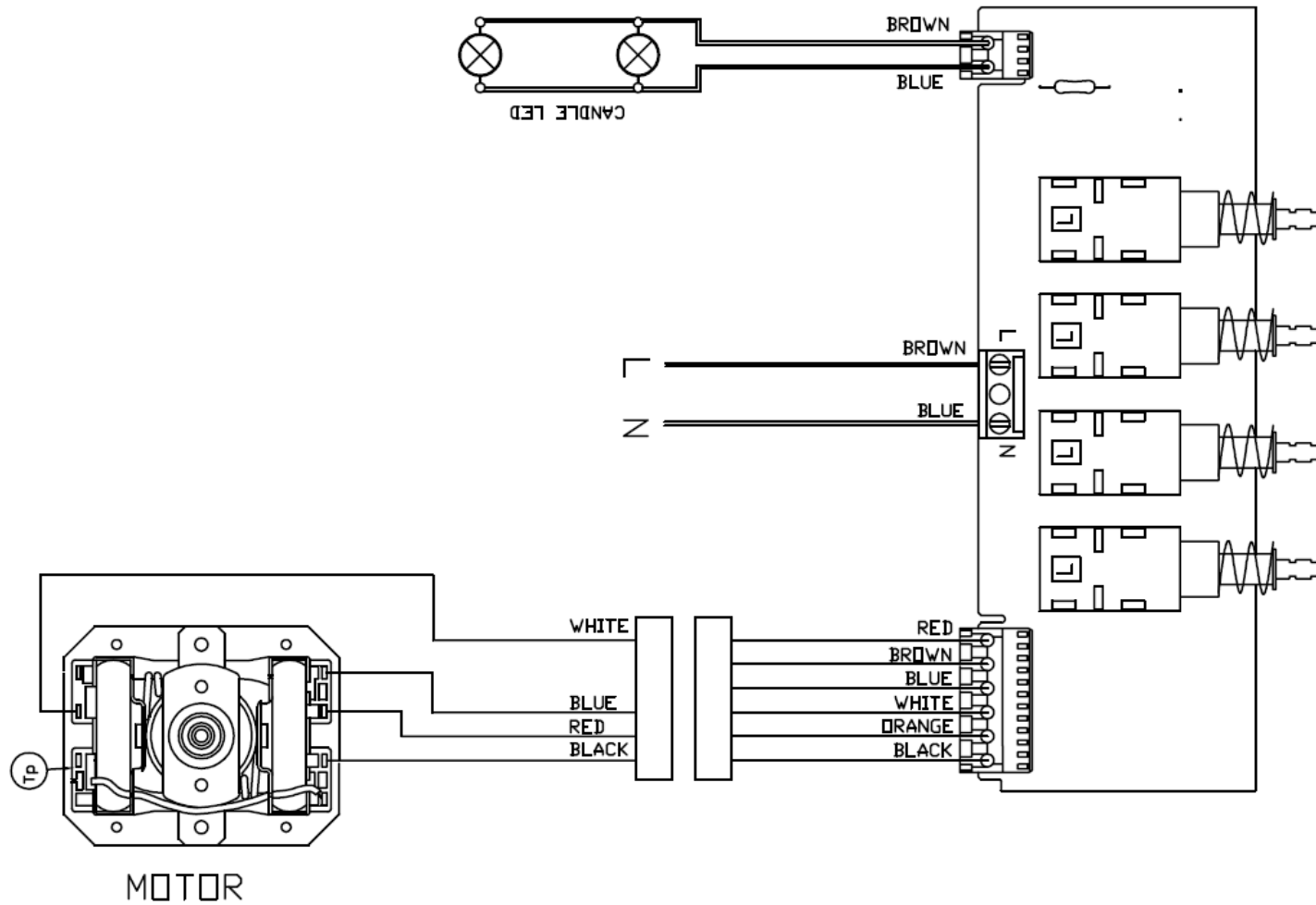

# 6 TROUBLE SHOOTING

## 6.1 Blower Assembly

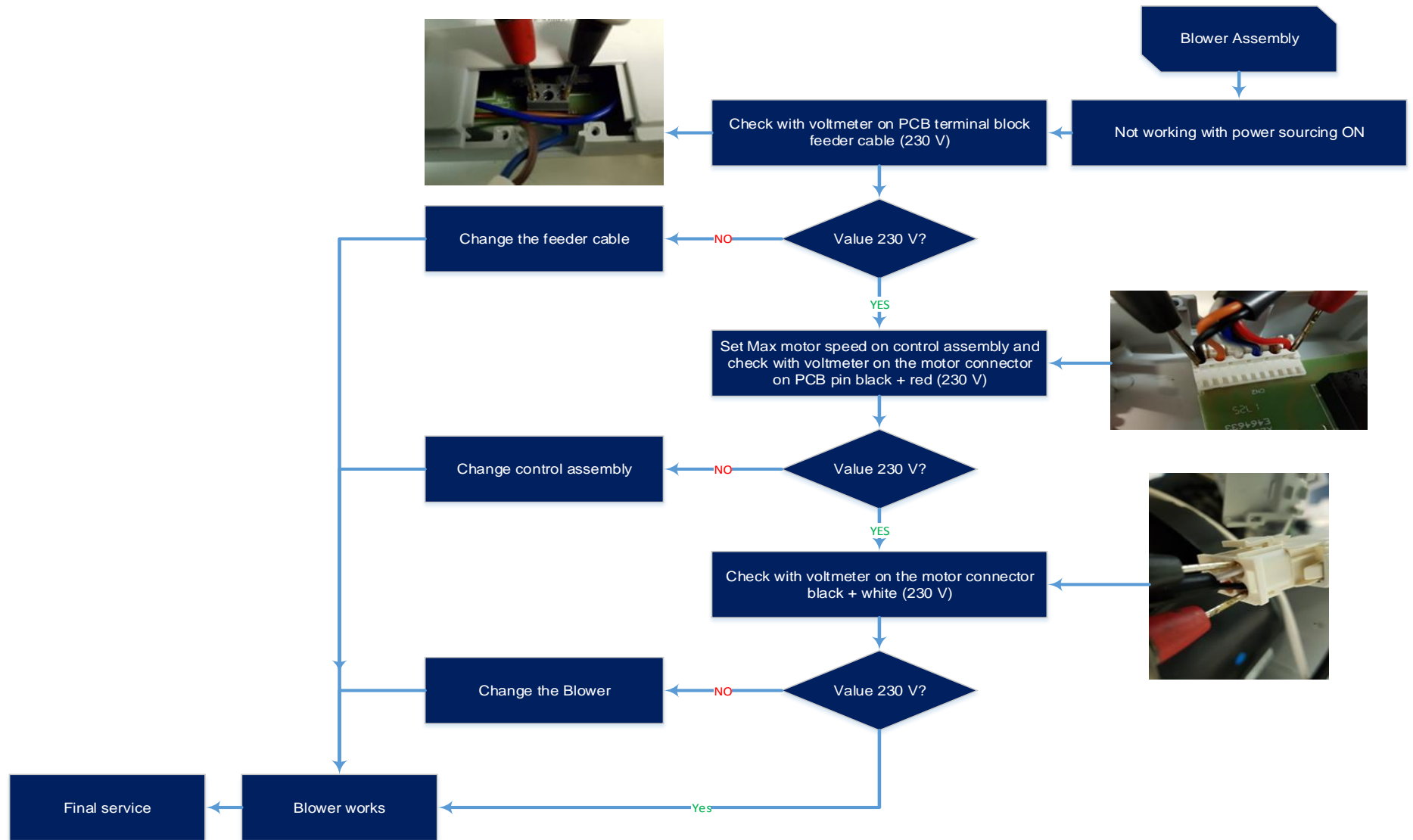

## 6.2 Lamps

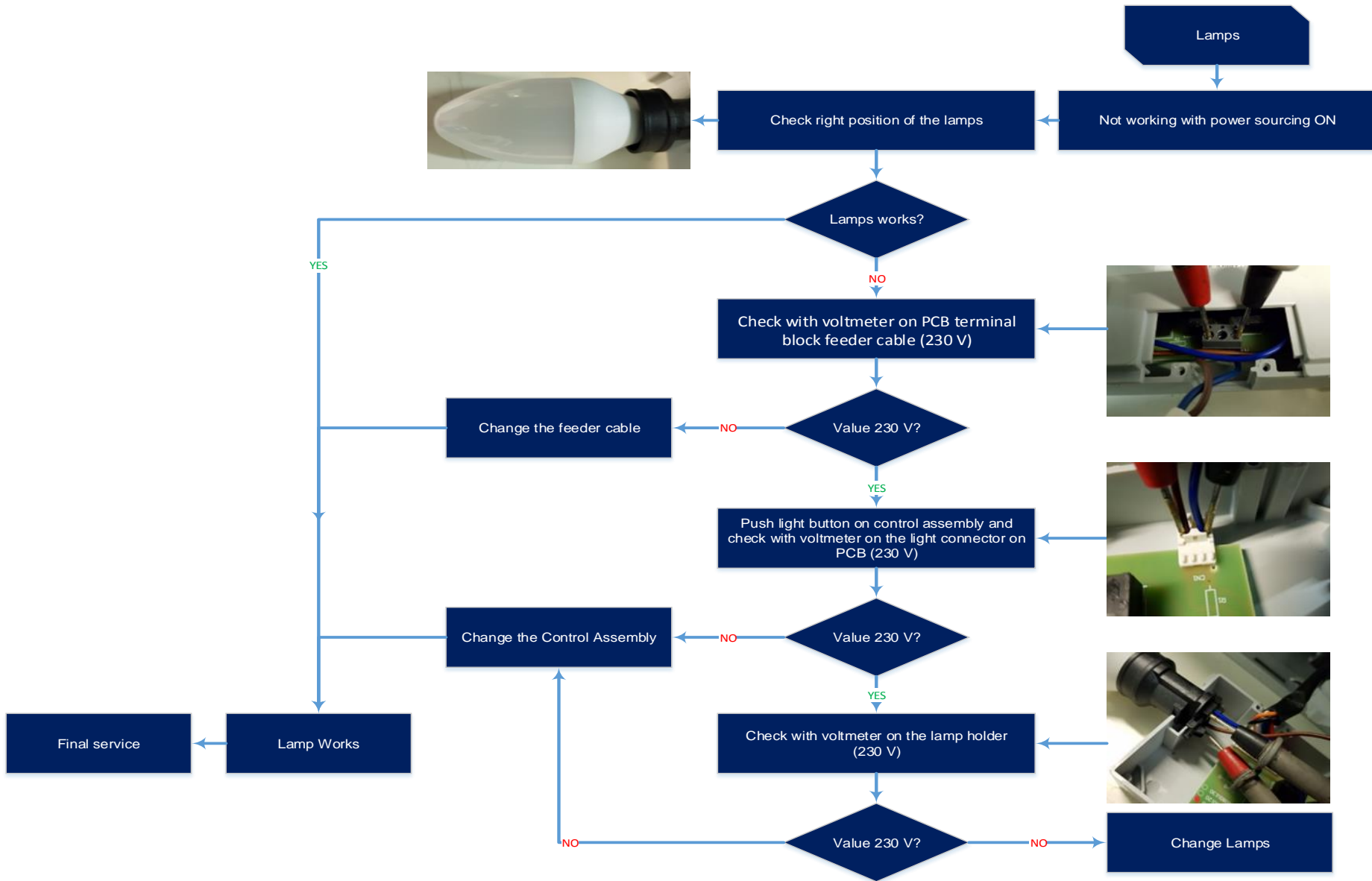

## 6.3 Control Assembly

