

Hood - Glass Panel Opening/Closing System

DESCRIPTION

Glass panel opening/closing system not functioning correctly

ROOT CAUSE

Wrong position/parallelism between the magnet surface and bracket

MODELS INVOLVED

PNC	Model
942122877	X86264MP1
942122878	X89264MP1
942150333	EFP60560OX
942150351	QFP60800X
942150323	DAGL5540VI
942150324	DAGL6040VI
942150325	DAGL9040VI
942150547	DPE5650G
942150546	DPE5950G

SOLUTION

Changed the closure system replacing the actual magnet with a new one with joint in order to improve/ensure the seal of the glass panel.

SERVICE SOLUTION

Change the glass panel inserting the new one with the self-adjustable magnets.
Refer to the pictures below to recognize the difference between the old glass panel and the new one.

OLD BRACKET



NEW BRACKET



To order an appropriate outer glass panel, please refer to the last page of this document.

Open the doors of the cabinet (1), remove the four screws installation (2) and uninstall the product (3)

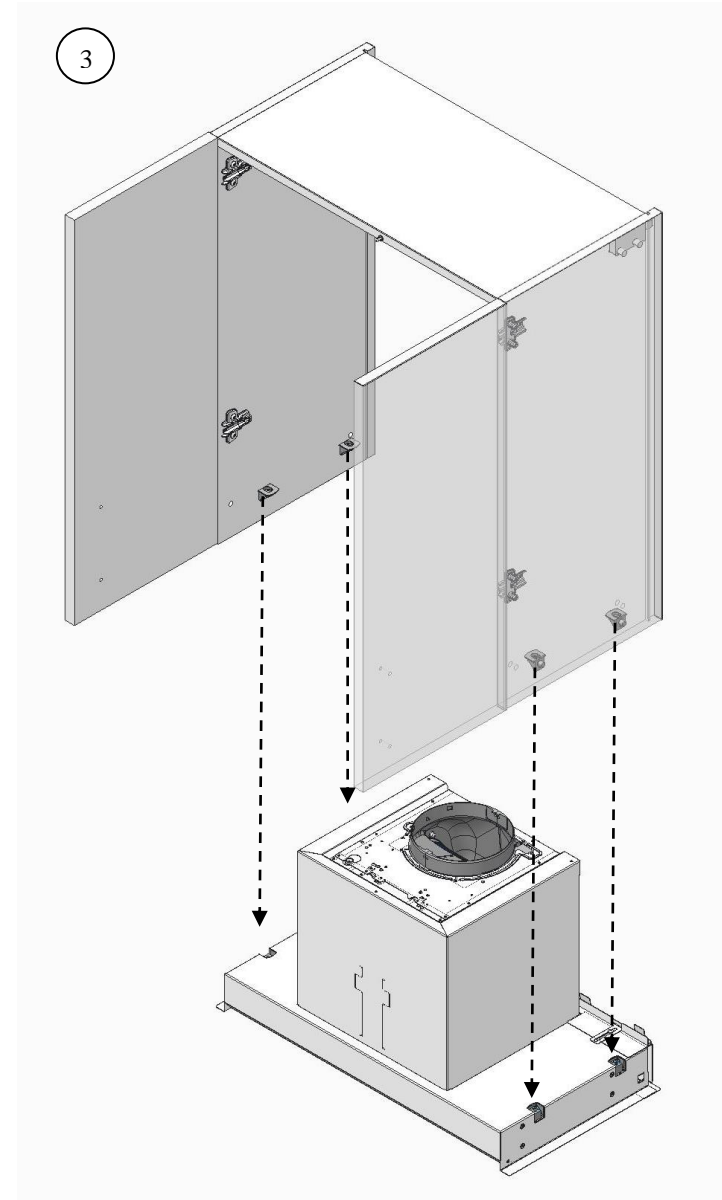
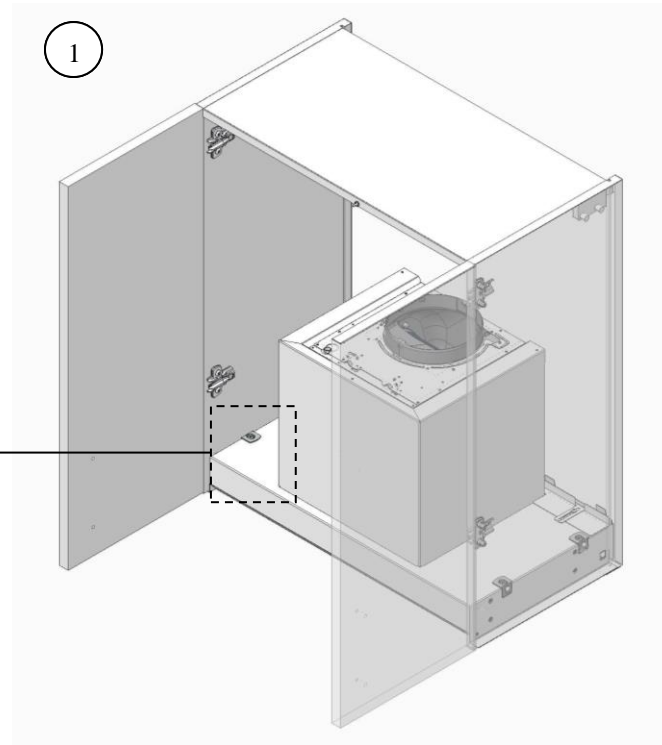
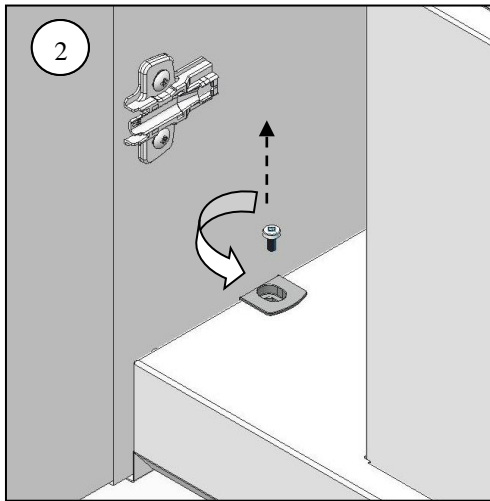

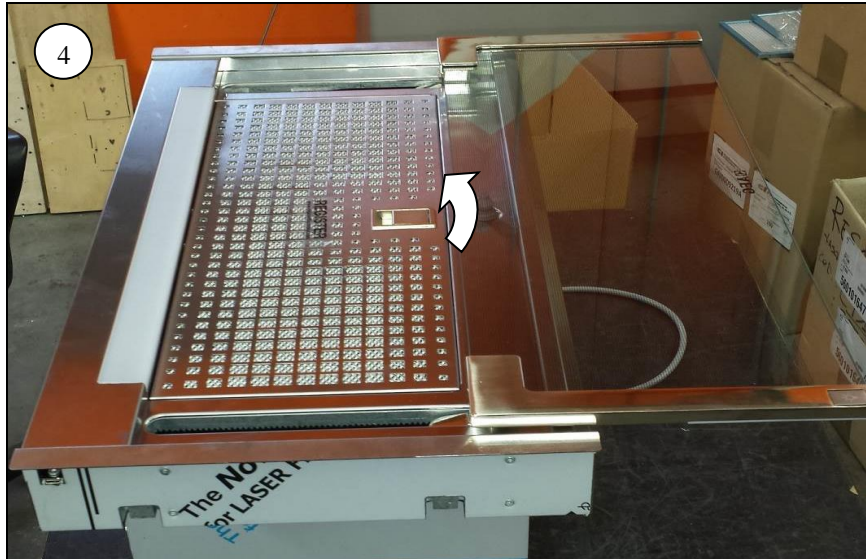

Open the glass veil and remove the grease filter (4) then remove the two screws of lamp support (5)

Disconnect wiring and remove wiring from fairlead (6)

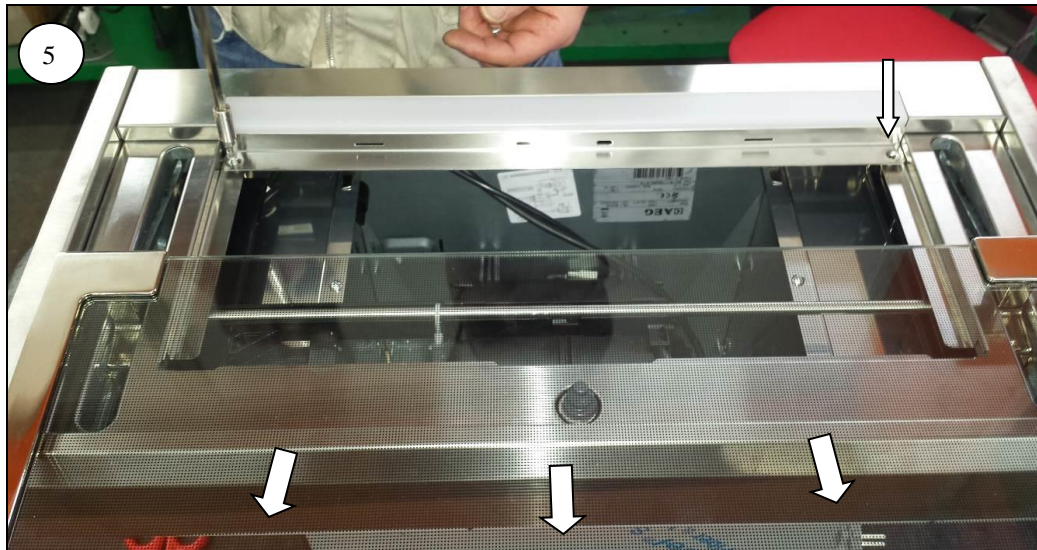



Rotate and move the lamp support as shown (7),(8) to remove itself

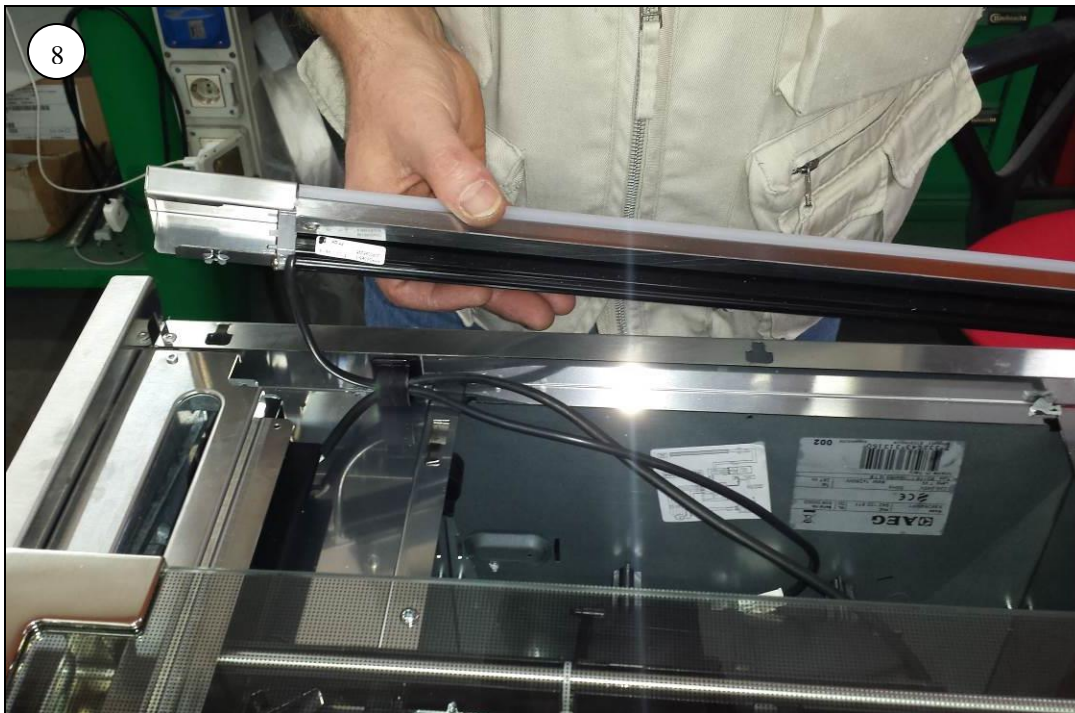

Remove wiring from fairlead (9)



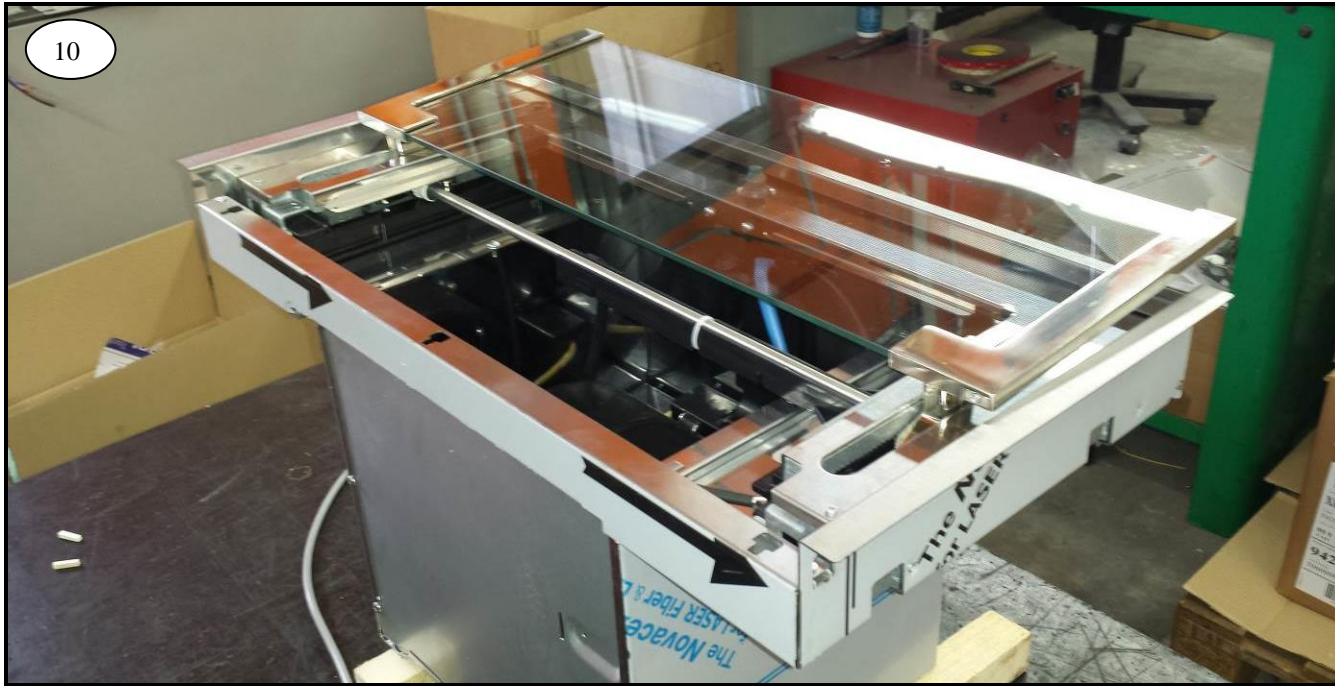

Move the veil until the holes of the support push-pull are accessible (10)

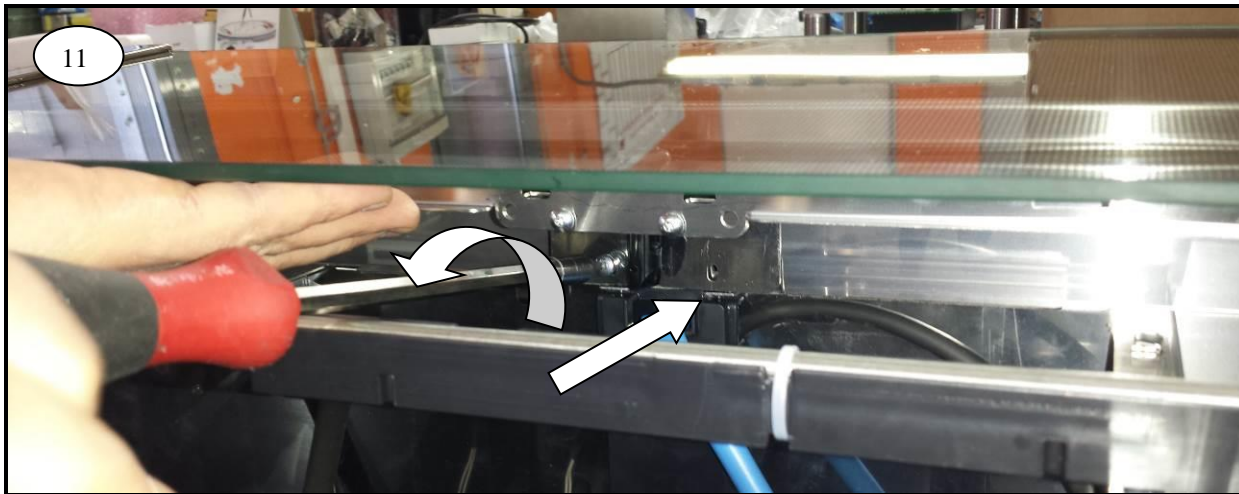

Remove the two screws of push-pull bracket (11)

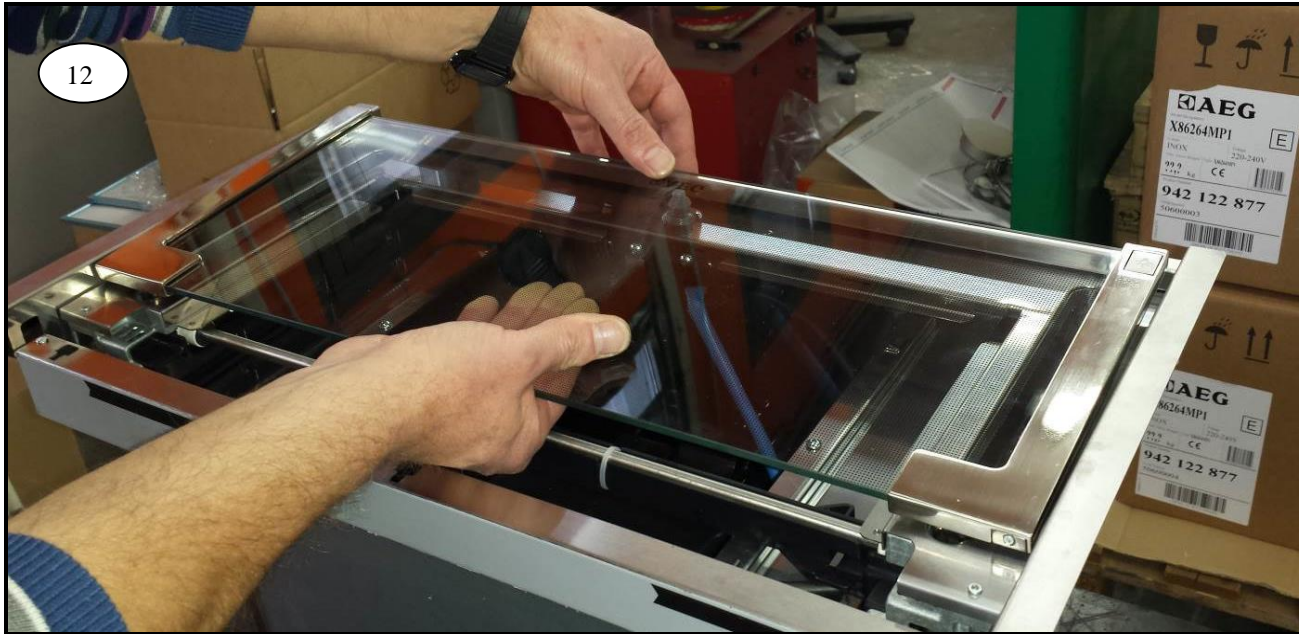

Close the glass veil (12) then remove the four screws on both lateral side (13)

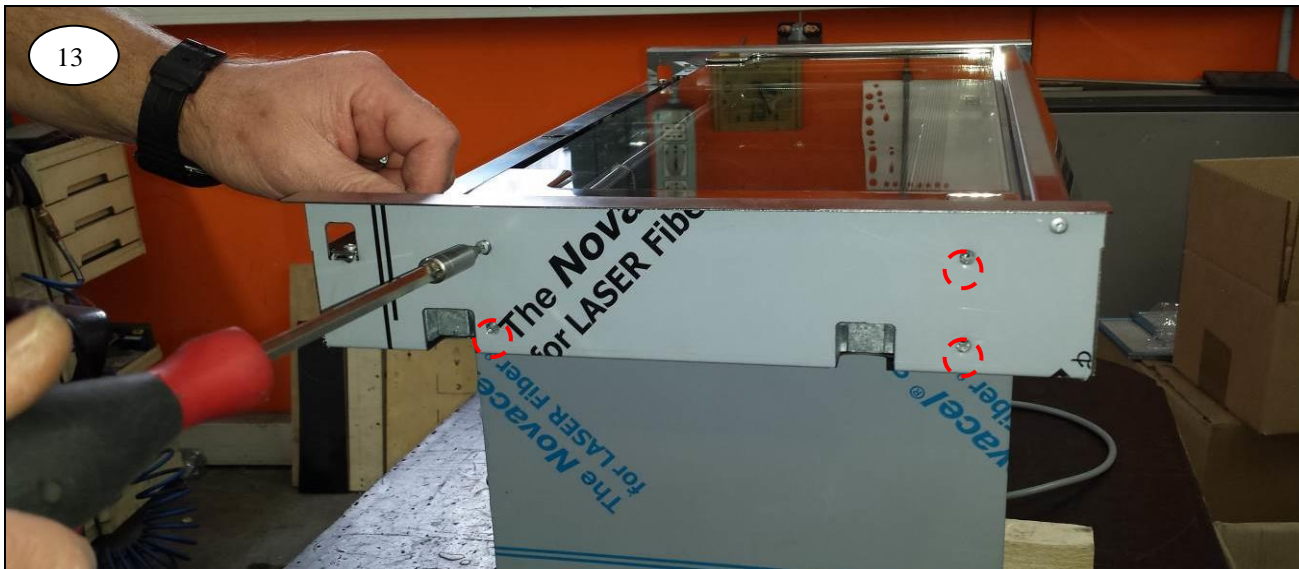

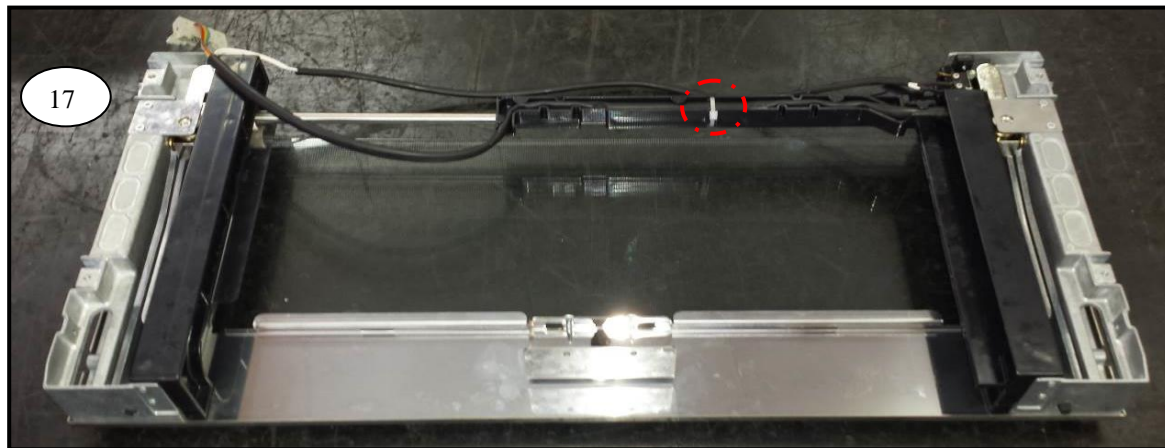
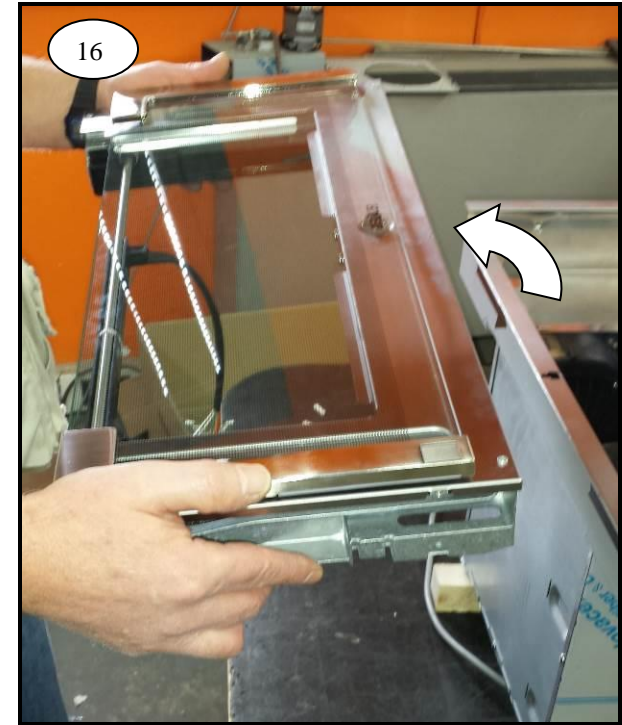

To remove the glass veil rotate and translate as shown (14), (15), (16) then remove the wire strap (17)



Remove wiring guide (18), (19)

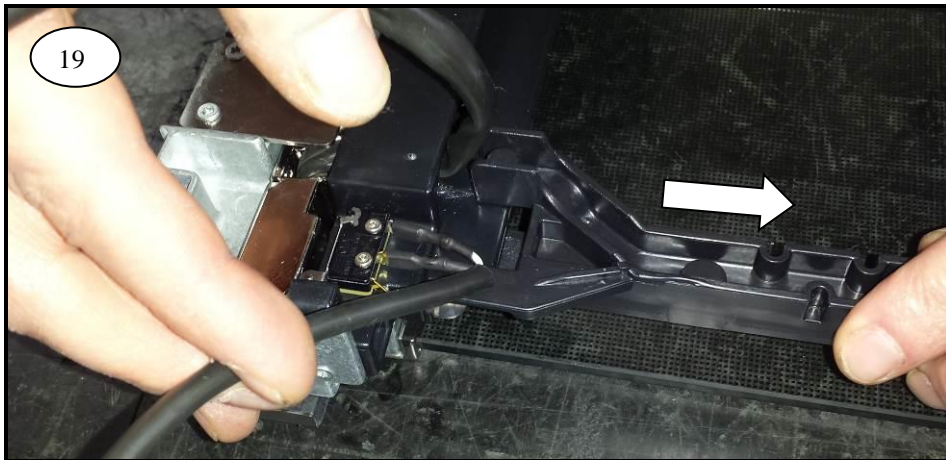

Remove the magnet support on both lateral sides (20), (21)



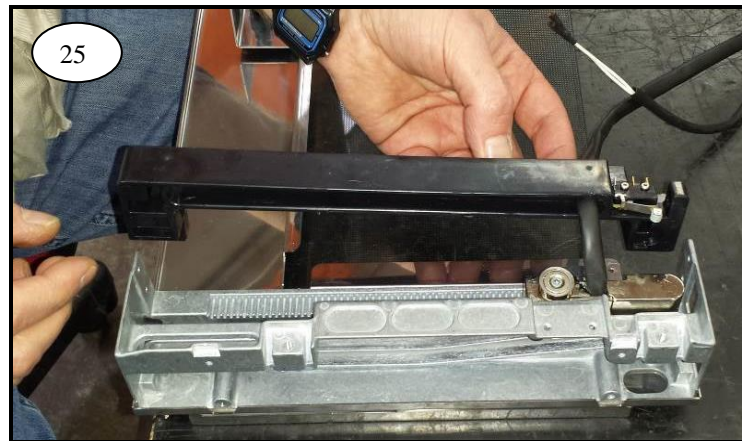
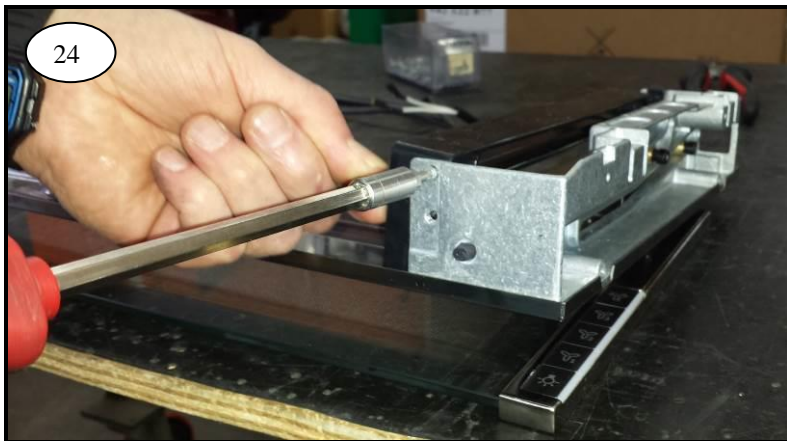
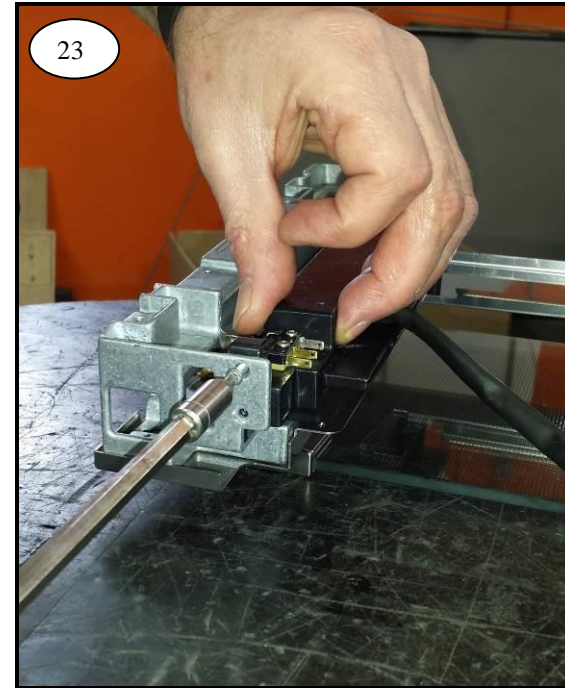

Disconnect the micro switch (22) and remove the four screws of support (23), (24) then remove controls wiring (25)

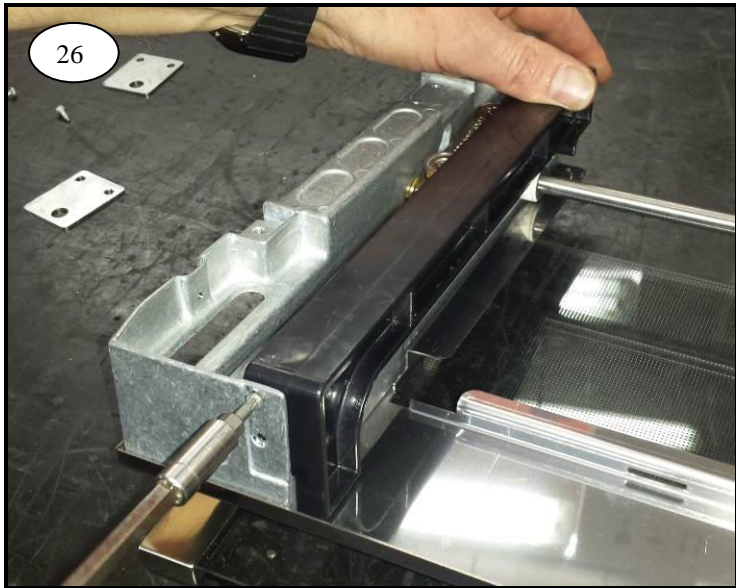

Remove the four screws of support on the other side (26), (27) then remove itself (28)





Remove transmission shaft (29)



Remove the four screws of glass support on both lateral side

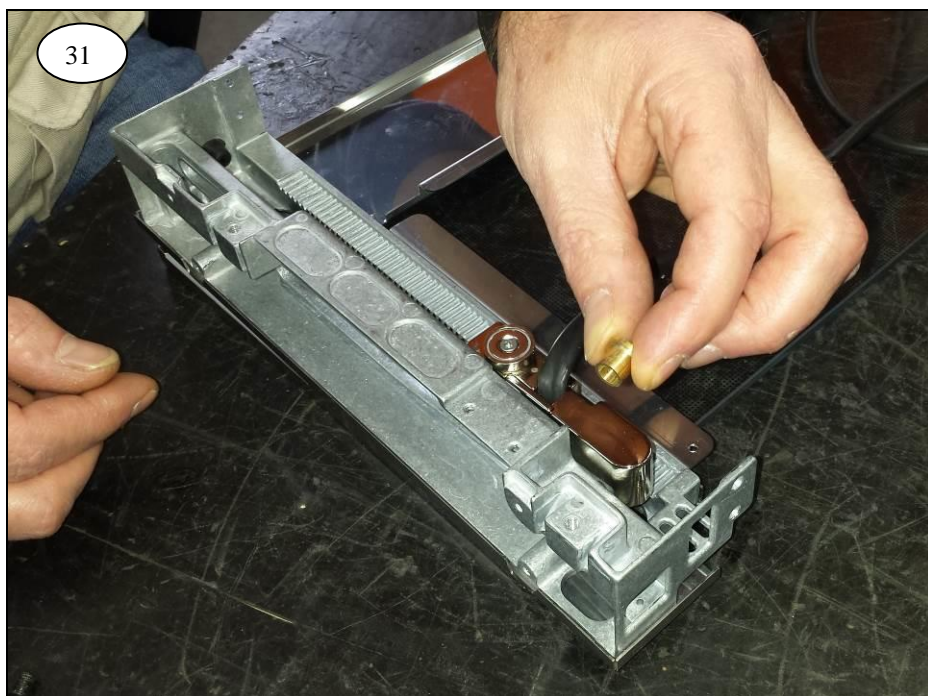

Remove the four bushings on both lateral side (31) then unthread upwards the support guides (32)



Assemble the spare part components (glass panel with joint magnets) according to the described procedure

SPARE PART NUMBER

PNC&ELC	Production date	Model	Outer glass panel part number
94212287702	20150910	X86264MP1	4055352340
94215032402	20150910	DAGL6040VI	4055352340
94215032403	20160314	DAGL6040VI	4055352340
94215032404	20160509	DAGL6040VI	4055352340
94215033302	20150910	EFP60560OX	4055352340
94215033303	20160509	EFP60560OX	4055352340

PNC&ELC	Production date	Model	Outer glass panel part number
94212287700	20150401	X86264MP1	4055335428

PNC&ELC	Production date	Model	Outer glass panel part number
94212287703	20160509	X86264MP1	4055367496

PNC&ELC	Production date	Model	Outer glass panel part number
94212287800	20150401	X89264MP1	4055335642

PNC&ELC	Production date	Model	Outer glass panel part number
94212287803	20160509	X89264MP1	4055367504

PNC&ELC	Production date	Model	Outer glass panel part number
94212287802	20150910	X89264MP1	4055352365

94215032502	20150910	DAGL9040VI	4055352365
94215032503	20160314	DAGL9040VI	4055352365
PNC&ELC	Production date	Model	Outer glass panel part number
94215035100	20150501	QFP60800X	4055335782
94215035101	20150910	QFP60800X	4055335782

PNC&ELC	Production date	Model	Outer glass panel part number
94215032300	20150415	DAGL5540VI	4055335667

PNC&ELC	Production date	Model	Outer glass panel part number
94215032302	20150910	DAGL5540VI	4055352357
94215032303	20160314	DAGL5540VI	4055352357

PNC&ELC	Production date	Model	Outer glass panel part number
94215032500	20150415	DAGL9040VI	4055335766

PNC&ELC	Production date	Model	Outer glass panel part number
94215054700	20160901	DPE5650G	4055373486

PNC&ELC	Production date	Model	Outer glass panel part number
94215054600	20160901	DPE5950G	4055373452