

Elimination of Blanking Button in New Production

Presently we have Blanking Buttons (White Caps) on alternate terminals of the Terminal block to prevent incorrect connection.

1. Blanking Buttons
2. Terminal Block

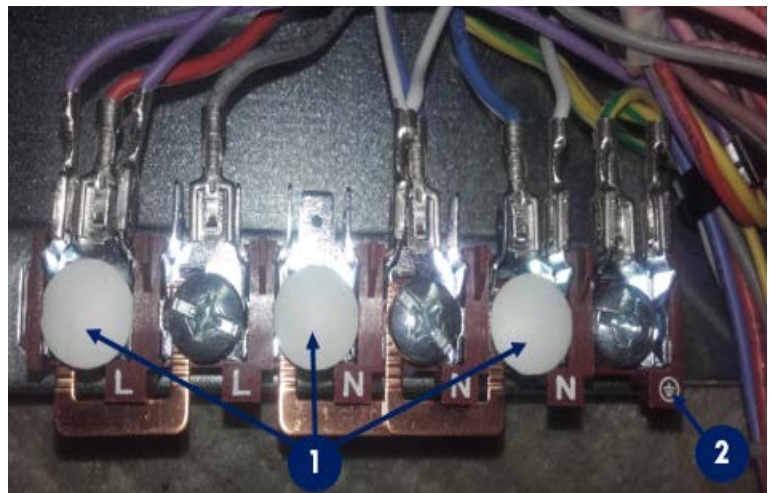

Future Production will eliminate these Blanking Buttons. When removal is required for service operation note the correct connections. The connection plate is adhered to the rear panel.

3. Unfasten the screws
4. Remove the connection cover.

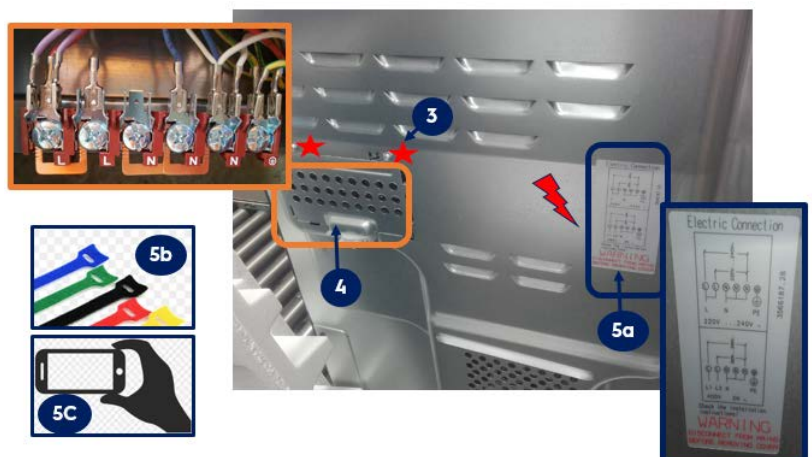

5. To assist correct connection
 - a. Refer to the adhered Electrical connection label
 - b. Use Cable tags
 - c. Photograph the connections for reference.

Revision	Date	Description	Approved by
0.0	04/2017	Document creation	Ireneusz Zapala