

DRAIN PUMP BLOCKAGES

DESCRIPTION:

It is possible for drain pumps from manufacturer Leili produced before 24.05.2013 to become jammed.

SOLUTION:

1. Identify the drain pump you have by comparing the data label with those below.
 The later pumps also have a support bracket.

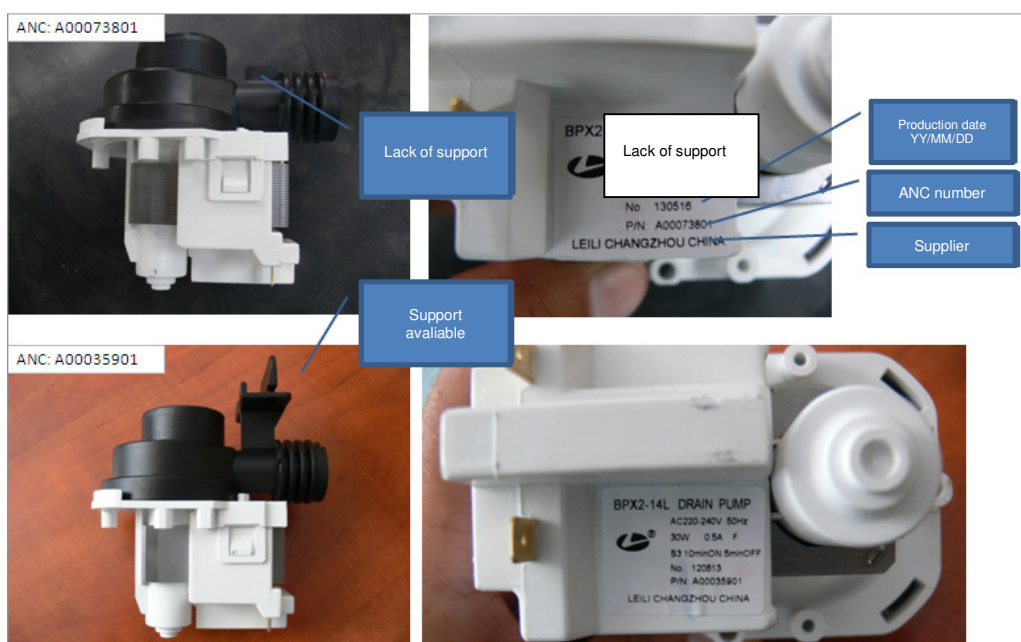

2. Replace with a new one produced after 24.05.2013.

Do not unblock the pump, replace with a new one!
 Specific part numbers can be located on TDS for the model you have.

MODELS INVOLVED:

All PNC.

REVISION:

Revision	Date	Description	Author	Approved by - on
00	10/2013	Document Creation	Marek Zemsta	Krzysztof Dobrzański