

Change of Main Board. All 321 and 391 models

SUBJECT: Main board is supplied from vsel Electronic

ITEM NR: ECN124E / 04-03/FR10 E

PURPOSE: Alternative supplier

IMPLEMENTATION DATE: 26.02.2013

Component codes

OLD PART		NEW PARTS:	
4055213153	MAIN BOARD/391-321	4055254868	MAIN BOARD/VE(BDA02-3)391
-		4055254934	DISPLAY CARD/VE(20BDD03)391
-		50298477006	SENSOR
-		4055143780	HOLDER-SENSOR (WHITE)
-		4055182812	HOLDER-SENSOR (GRAY)

Note

If the unit was produced before 26.02.2013, 4055213153 code must be used.

KEMA certificates are available for new electronic boards.

Component picture

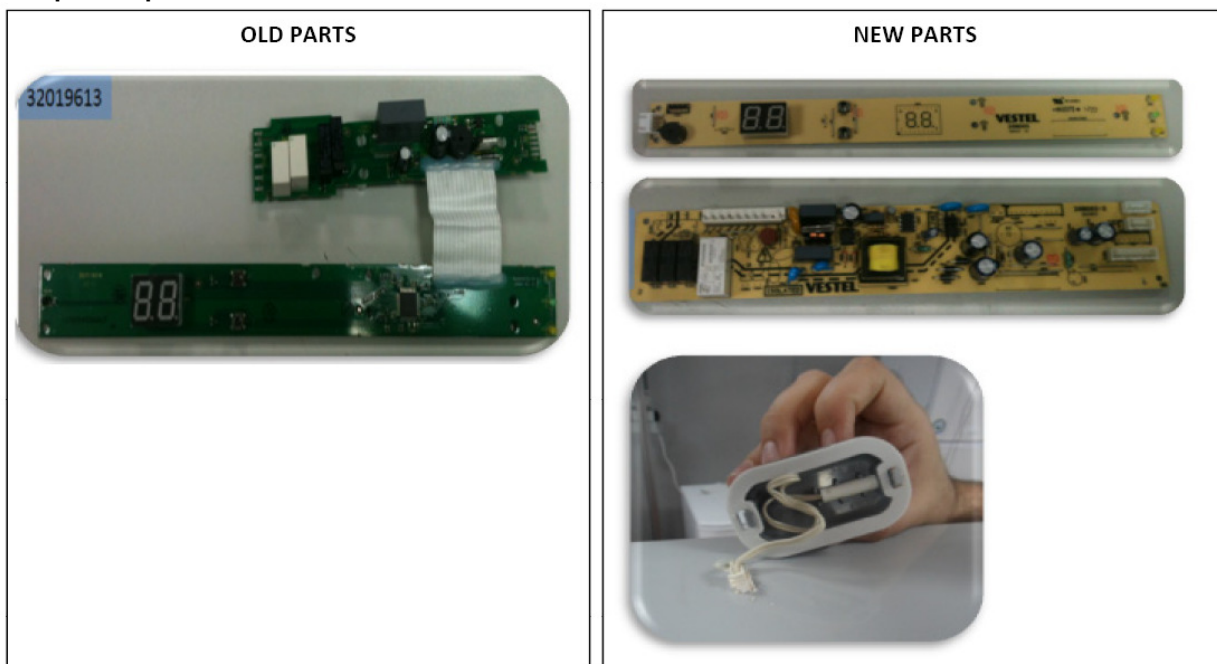

Additional Data

AT (Ambient Temperature) sensor was moved to top of the appliance.

Appliance's height increased 13mm. Sensor cover and ambient sensor were added.



Revision	Date	Description	Author	Approved by - on
00	05/2013	Document Creation	Blanka Kucharska/ P.Dogaci	B.K. 2013-05