

DISPLAY HAVE NO FUNCTION OR IS DARK ON OVENS WITH HEXAGON, VISION VCU AND OMEGA UI

FAULT:

Display have no function or is dark.

DESCRIPTION:

Some oven models with electronic Omega, Vision VCU and Hexagon are equipped with a power saving mode to deactivate the display in standby mode.

1. Omega electronic

The electronics Omega has the power saving function to deactivate the display (dark display, only in standby).

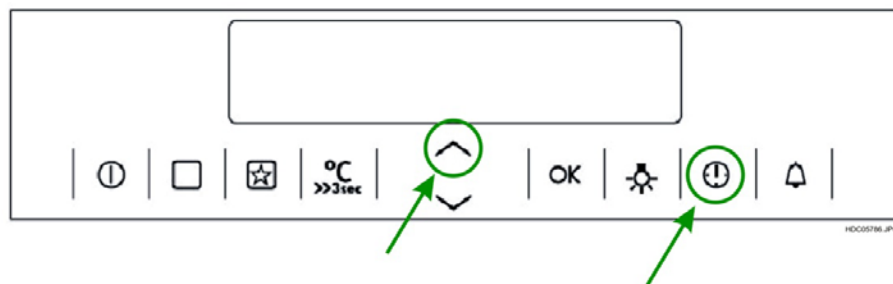





Fig. 1- EXAMPLE AEG AESTHETIC

If simultaneously the button "up"  and the button with symbol "clock"  is pressed, then the display is dark (only in standby mode).

If the display is dark you have to press the "UP" button  and the "clock" button . Then the display shows again the time in standby mode.

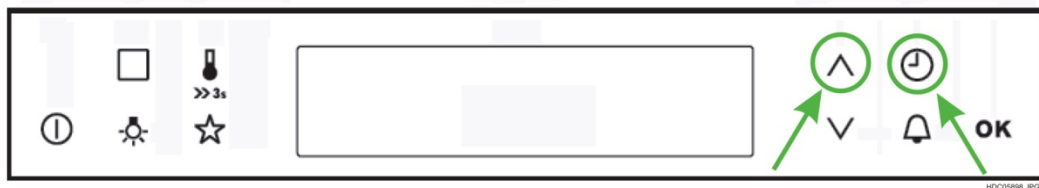

Fig. 2 - EXAMPLE ELECTROLUX AESTHETIC

NOTE: Be careful in Electrolux aesthetic where the two keys to activate the function are close and sometimes unintentionally activated.

2. Vision VCU electronic

The electronics Vision VCU has the power saving function to deactivate the display (dark display, only in standby).

This function can be enabled / disabled from the menu BASIC SETTING and then TIME INDICATION.



Fig. 3



NOTE: In any case, when there are problems in Vision VCU with display dark, before replacing components, disconnect the equipment from the network and reconnect it to reset any electronics problems (due to known issue in Vision VCU that sometimes also a power interruption can disable the display).

3. Hexagon electronic

Some versions of electronic Hexagon have the power saving function to deactivate the display (dark display, only in standby).



To deactivate (on display in standby) or reactivate the function (display turns off in standby), simultaneously press the button  and the button  for 2 seconds.



Fig. 4

NOTE: In some versions of the interfaces Omega, Vision VCU and Hexagon the function to deactivate the display (**display dark**) is inhibited by configuration software.

In any case, when there are problems in electronic models with display off, before replacing components, disconnect the equipment from the network and reconnect it to reset any electronics problems (due, sometimes also to the lack of electrical energy for a certain time).

REVISION:

Revision	Date	Description	Author	Approved by - on
00	09/2012	Document Creation	FV	