

Lamp unit doesn't work properly (lamp doesn't light)

Description

The consumer can experience that the lamp doesn't light inside the refrigerator or the lamp actuator sticks in and doesn't switch on the lamp.

Root cause

Burr on the plastic components of the lamp unit.

Models involved

TT refrigerators

Cabinet refrigerators

CT235, CT280

Solution

Repairing solution is to remove the burr from the plastic components of the lamp unit based on the bellow instructions.

Service instruction:

1. Be sure that the appliance is disconnected from the electrical power.
2. Remove the lamp unit.



3. Remove the inside components of the lamp unit.

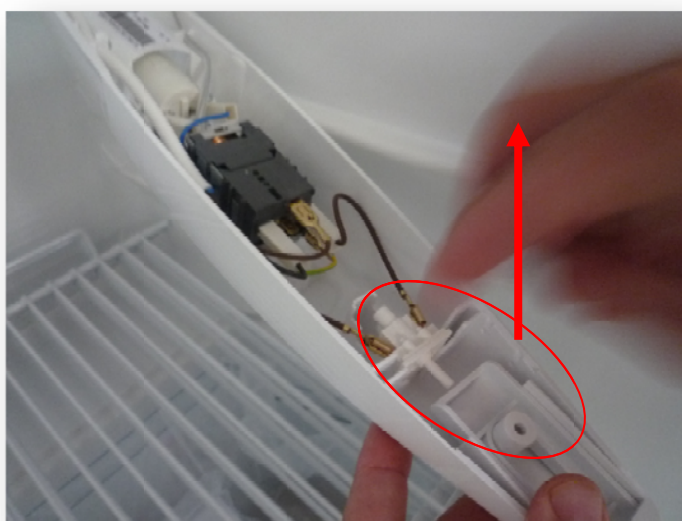



4. Remove the burr from the lamp unit cover with the help of a small knife – no burr can remain!!!



5. Assembly back the lamp unit internal components.

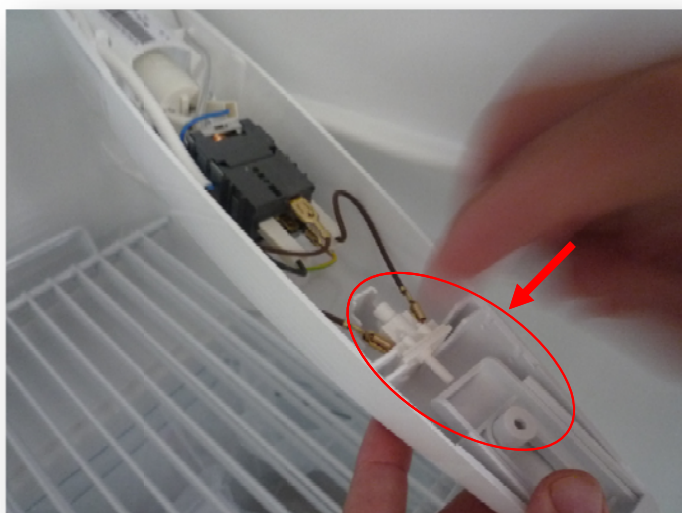



6. Assembly back the lamp unit.





7. Check the proper working of the lamp unit.

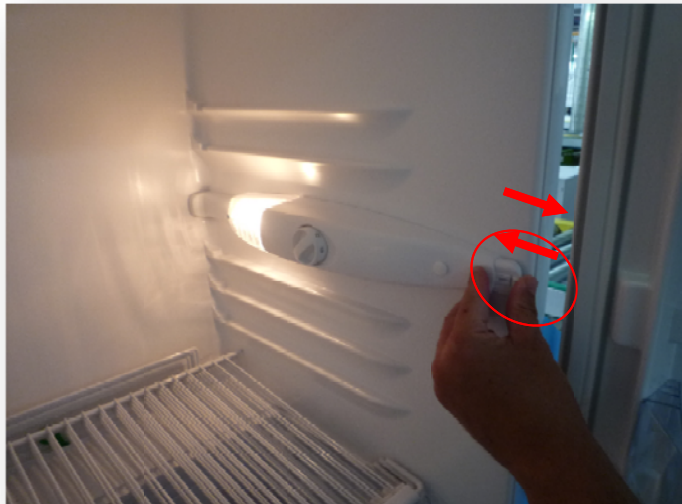

Distance between side panel and door panel when the light switch on / off must be min. 40 mm.

