



Dometic

Absorption-Build-in-Refrigerators

Removal of the Appliance

Caravan & Motorcaravan

1 Description of the ventilation system

In this vehicle the cooling unit of the absorption refrigerator is ventilated via **integrated ventilation pipes** and a **roof ventilator**. Access to components on the backside of the fridge is only possible after demounting the fridge.

The cool air is led to the cooling unit through an opening in the bottom and two air ducts.

Above the cooling unit there are two openings, which, via two ducts, transport the waste heat of the cooling unit and the waste gas to the roof ventilator.

There are no ventilation openings on the side walls of the vehicle.

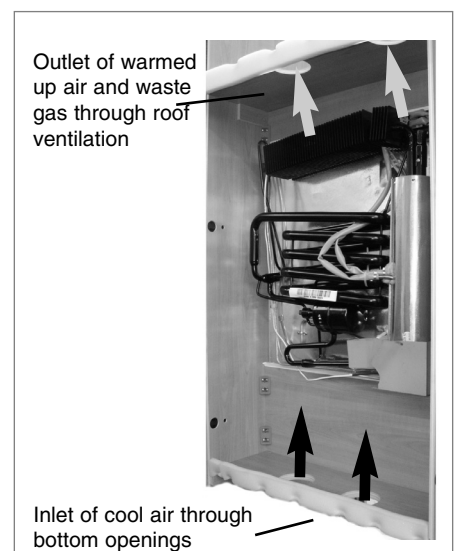

In case of maintenance or repair, please follow the description below.

2 Demounting the fridge

Single-Door fridges:

First of all, demount the cooker above the fridge.

Gas connection and electrical connections are now accessible and can be unfastened.

The fridge is fixed onto the mounting sockets. After removing the covering caps, unfasten the screws.

Pull out the fridge carefully.

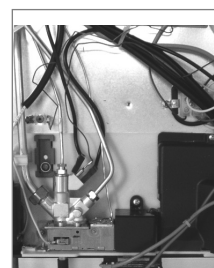

Demounting the fridge

Double-Door Fridges :

First of all, demount the covering plate above the fridge.

Gas connection and electrical connections are now accessible and can be unfastened.

Cut-off the electrical voltage supply for 12V and 230V on the wrap connections.

The fridge is fixed onto the mounting sockets. After removing the covering caps, unfasten the screws.

Pull out the fridge carefully.

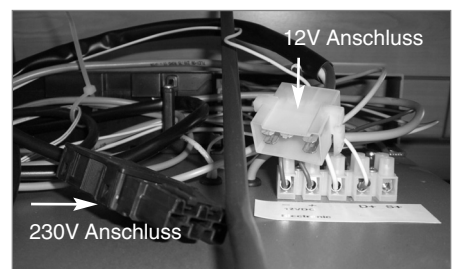

i **Cleaning the gas burner**

This model is equipped with an integrated air duct for a simple cleaning with air pressure. Thus, there is no need to take out the fridge, if the gas burner has to be cleaned.

For description, please see the supplement within the fridge.

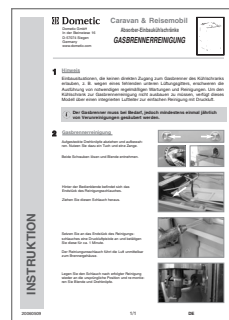

LMC Caravan GmbH
Rudolf-Diesel-Straße 4
D-48336 Sassenberg

Dometic GmbH
In der Steinwiese 16
D-57074 Siegen



The Sign of Comfort