



© ELECTROLUX ITALIA S.p.A.  
Corso Lino Zanussi,30  
I - 33080 PORCIA /PN (ITALY)  
Tel +39 0434 394850  
Fax +39 0434 394096

Publication  
number

**599 38 54-25**

IT/SERVICE/FV

**Built-in ovens**  
**REVERSIBILITY OF THE**  
**HINGED DOOR**  
**ON ACCESS PLUS OVENS**

SOI

Edition: 02.2009 - Rev. 01



## TABLE OF CONTENTS

<b>1</b>	<b>INTRODUCTION</b>	<b>5</b>
1.1	PURPOSE OF THIS MANUAL	5
<b>2</b>	<b>REMOVING A LEFT-HINGED DOOR</b>	<b>5</b>
2.1	REMOVING THE OVEN FROM THE CABINET	5
2.2	REMOVING THE DOOR	6
2.2.1	POSITION OF THE DOOR HINGES AND LATCH	6
2.2.2	POSITION OF THE HINGE SCREWS	7
2.2.3	REMOVING THE FRONT PANEL SCREW	7
2.2.4	CLOSE-UP VIEW OF HINGE SCREW	7
2.2.5	REMOVING THE UPPER HINGE	8
2.2.6	CLOSE-UP VIEW OF DOOR REMOVAL	8
<b>3</b>	<b>SUMMARY OF OPERATIONS</b>	<b>9</b>
3.1	PREPARING THE DOOR FOR REVERSAL OF APERTURE	9
3.1.1	POSITION OF THE COMPONENTS ON A DOOR WITH APERTURE FROM RIGHT TO LEFT	9
3.1.2	PROCEDURE	10
3.1.3	POSITION OF THE COMPONENTS ON A DOOR WITH APERTURE FROM LEFT TO RIGHT	10
3.2	REMOVING THE TERMINAL SUPPORTS	11
3.2.1	REMOVING THE UPPER TERMINALS	11
3.2.2	CLOSE-UP VIEW OF UPPER TERMINAL SUPPORT	11
3.2.3	REMOVING THE INNER GLASS DOOR	12
3.2.4	REMOVING THE LOWER TERMINALS	12
3.2.5	REMOVING THE LOWER TERMINALS	13
3.2.6	CLOSE-UP VIEW OF LOWER TERMINAL SUPPORT	14
3.3	ROTATION OF THE DOOR WITH HINGE SUPPORT	14
3.4	REPLACING THE TERMINALS	15
3.4.1	REMOVING THE HINGE SUPPORT SCREW	15
3.4.2	REPLACING THE LOWER TERMINALS	15
3.4.3	CLOSE-UP VIEW OF SECURING THE LOWER TERMINALS	16
3.4.4	REPLACING THE INNER GLASS DOOR	16
3.4.5	REPLACING THE UPPER TERMINALS AND PROFILE	17
3.4.6	FITTING THE SPRINGS AND THE RUBBER SPACING ELEMENTS	17
3.4.7	DIFFERENCES BETWEEN TERMINALS	18
<b>4</b>	<b>REPLACING THE DOOR WITH LEFT-TO-RIGHT OPENING</b>	<b>19</b>
4.1	REVERSAL OF APERTURE FROM LEFT TO RIGHT	19
4.1.1	CLOSE-UP VIEW OF THE DOOR LATCH	19
4.1.2	REMOVING THE DOOR LATCH	19
4.1.3	REMOVING LATCH MASKING CAP	20
4.1.4	REFITTING THE DOOR LATCH ON THE OPPOSITE SIDE	21
4.1.6	REMOVING THE LOWER HINGE	22
4.2	REVERSING THE HINGE SUPPORT UPRIGHT	23
4.2.1	REMOVING THE HINGE SUPPORT UPRIGHT	23
4.2.2	REPLACING THE HINGE SUPPORT UPRIGHT	24
4.2.3	REPLACING THE SCREWS IN THE UPPER SECTION OF THE HINGE SUPPORT UPRIGHT	25
4.2.4	REPLACING THE SCREWS IN THE LOWER SECTION OF THE HINGE SUPPORT UPRIGHT	25

4.3	RE-POSITIONING THE HINGE	26
4.3.1	RE-POSITIONING THE HINGE (FROM UPPER SECTION TO LOWER SECTION)	26
4.3.2	REPLACING THE LOWER HINGE	26
4.3.3	REMOVING THE UPPER MASKING CAP	26
4.3.4	REPLACING THE UPPER MASKING CAP	26
4.4	REPLACING THE DOOR	28
4.4.1	RE-POSITIONING THE DOOR WITH APERTURE FROM RIGHT TO LEFT	28
4.4.2	RE-POSITIONING THE UPPER HINGE	28
4.4.3	SECURING THE UPPER HINGE	29
4.4.4	FITTING THE FRONT CONTROL PANEL	29
<b>5</b>	<b>ADJUSTING THE ALIGNMENT OF THE DOOR</b>	<b>30</b>
5.1	DOOR ALIGNMENT SCREW	31
5.2	TIGHTENING THE SCREWS	31
<b>6</b>	<b>REVISIONS</b>	<b>33</b>

# 1 INTRODUCTION

## 1.1 PURPOSE OF THIS MANUAL

The purpose of this manual is to provide simple instructions for reversing the hinged-type door fitted to "Access Plus" ovens.

## 2 REMOVING A LEFT-HINGED DOOR

In order to remove the door, it is necessary to remove the oven from the cabinet.

### 2.1 REMOVING THE OVEN FROM THE CABINET

To extract the oven from the cabinet, remove the four screws which secure the appliance to the cabinet. These screws are located on the front of the frame (see Fig. 1 and 2)

Fig. 1

- 1 - UPPER SCREW (LEFT)
- 2 - UPPER SCREW (RIGHT)
- 3 - LOWER SCREW (LEFT)
- 4 - LOWER SCREW (RIGHT)

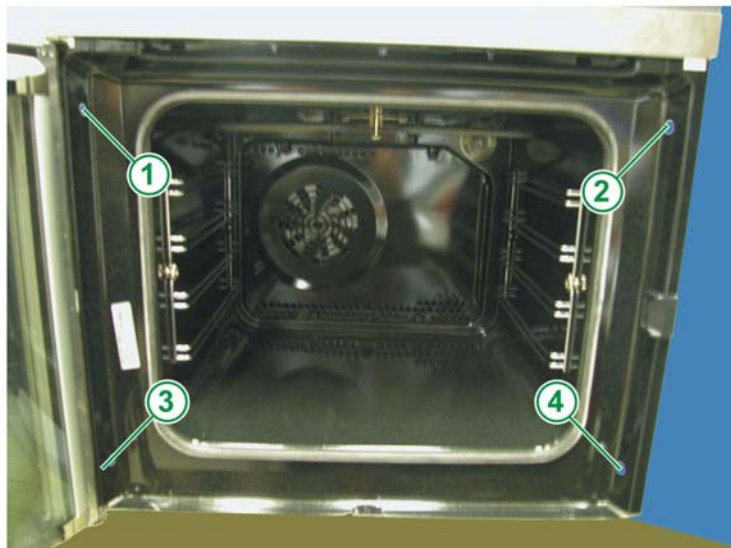

HDC01964.JPG

Fig. 2

- 1 - SCREW SECURING OVEN TO CABINET
- 2 - WASHER FOR SCREW 1



HDC01965.JPG

## 2.2 REMOVING THE DOOR

To remove the oven door, proceed as follows:

- Remove the screw which secures the front panel (see Fig. 6).
- Remove the screws which secure the upper hinge (see Fig. 7).
- Remove the upper hinge (hold the door in position to ensure that it does not fall) (see Fig. 8)

### 2.2.1 POSITION OF THE DOOR HINGES AND LATCH

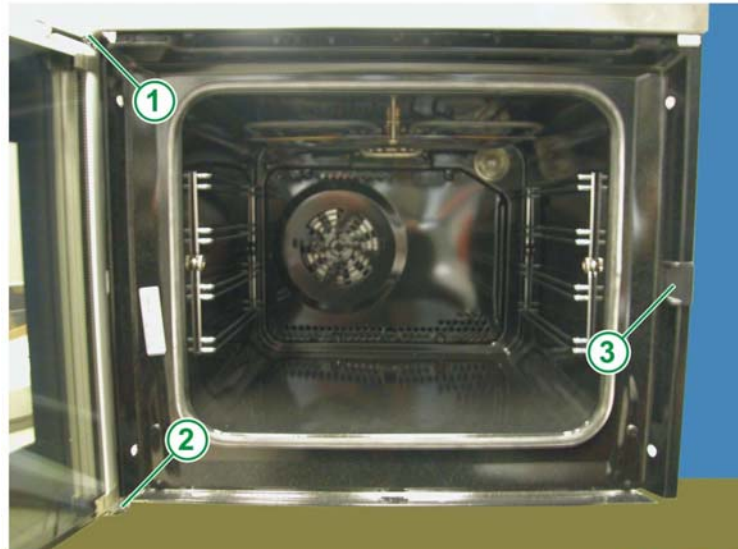

Fig. 3

- 1 - UPPER HINGE
- 2 - LOWER HINGE
- 3 - DOOR LATCH

HDC01966.JPG

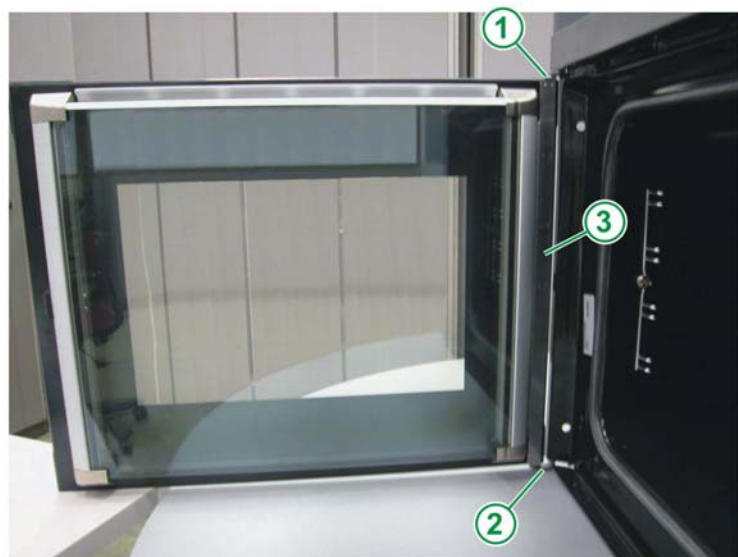

Fig. 4

- 1 - UPPER HINGE
- 2 - LOWER HINGE
- 3 - HINGE SUPPORT

HDC01967.JPG

## 2.2.2 POSITION OF THE HINGE SCREWS

Fig. 5

- 1 - SCREWS FOR UPPER HINGE
- 2 - HINGE SUPPORT
- 3 - SCREWS FOR LOWER HINGE



HDC01969.JPG

## 2.2.3 REMOVING THE FRONT PANEL SCREW

Fig. 6

- 1 - UPPER HINGE
- 2 - UPPER SCREW
- 3 - LOWER SCREW

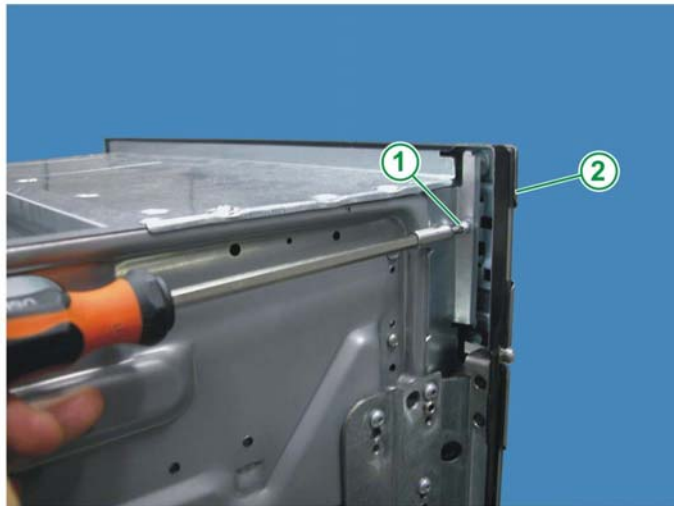

HDC01970.JPG

## 2.2.4 CLOSE-UP VIEW OF HINGE SCREW

Fig. 7

- 1 - UPPER HINGE
- 2 - UPPER SCREW
- 3 - LOWER SCREW

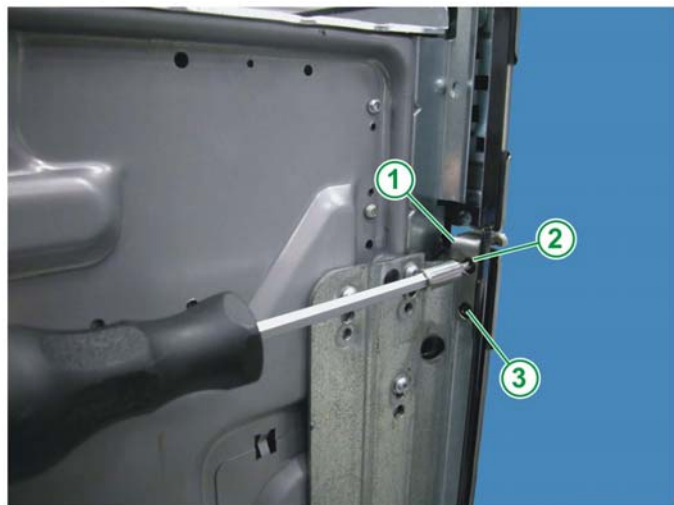

HDC01968.JPG



## 2.2.5 - REMOVING THE UPPER HINGE

To remove the upper hinge:

- Remove the screw which secures the front panel (see Fig. 6).
- Remove the screws which secure the upper hinge (see Fig. 7).
- Move the front panel slightly upwards and outwards to release the upper hinge (see Fig. 8).
- Extract the hinge by moving upwards and towards the interior of the oven (see Fig. 8).

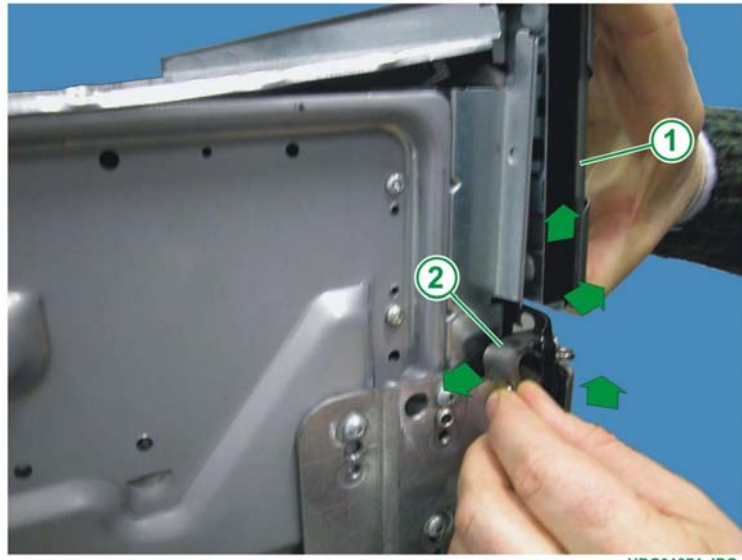

Fig. 8

- 1 - FRONT CONTROL PANEL
- 2 - UPPER HINGE

HDC01971.JPG

## 2.2.6 CLOSE-UP VIEW OF DOOR REMOVAL

To remove the oven door:

- Remove the upper hinge.
- Move the door upwards and outwards to remove (see Fig. 9).



Fig. 9

- 1 - FRONT CONTROL PANEL
- 2 - OVEN DOOR

HDC01972.JPG



### 3 SUMMARY OF OPERATIONS

Proceed as follows to change the door aperture from left to right:

- Remove the oven door
- Prepare the door for reverse installation
- Replace the oven door
- Adjust the alignment of the door

#### 3.1 PREPARING THE DOOR FOR REVERSAL OF APERTURE

##### 3.1.1 POSITION OF THE COMPONENTS ON A DOOR WITH APERTURE FROM RIGHT TO LEFT

Fig. 10

- 1 - UPPER TERMINAL SUPPORT (LEFT)
- 2 - UPPER STRIP
- 3 - UPPER TERMINAL SUPPORT (RIGHT)
- 4 - DOOR KNOB
- 5 - LATCH
- 6 - LOWER TERMINAL SUPPORT (RIGHT)
- 7 - LOWER TERMINAL SUPPORT (LEFT)
- 8 - HINGE SUPPORT ASSEMBLY

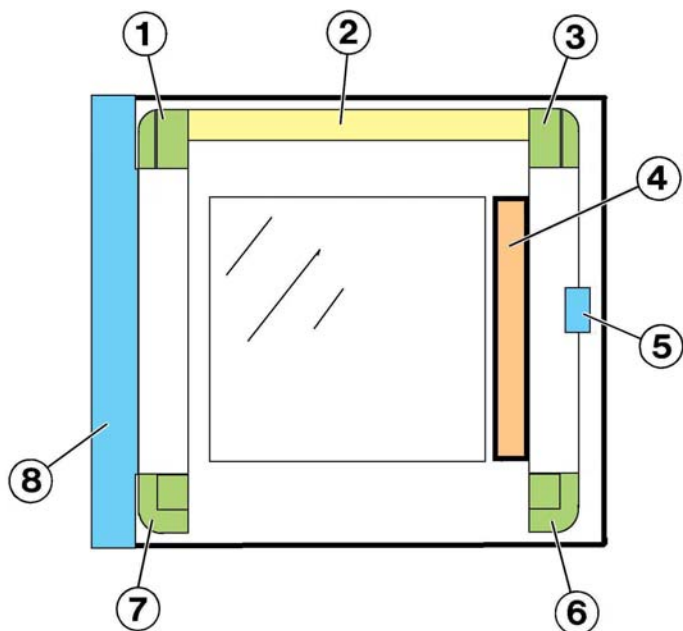

HDC01974.JPG

In order to reverse the door, it is necessary to rotate it, keeping the terminal supports for the inner glass door in the same positions. Before removing the terminal supports it is necessary to remove the hinges.

### 3.1.2 PROCEDURE

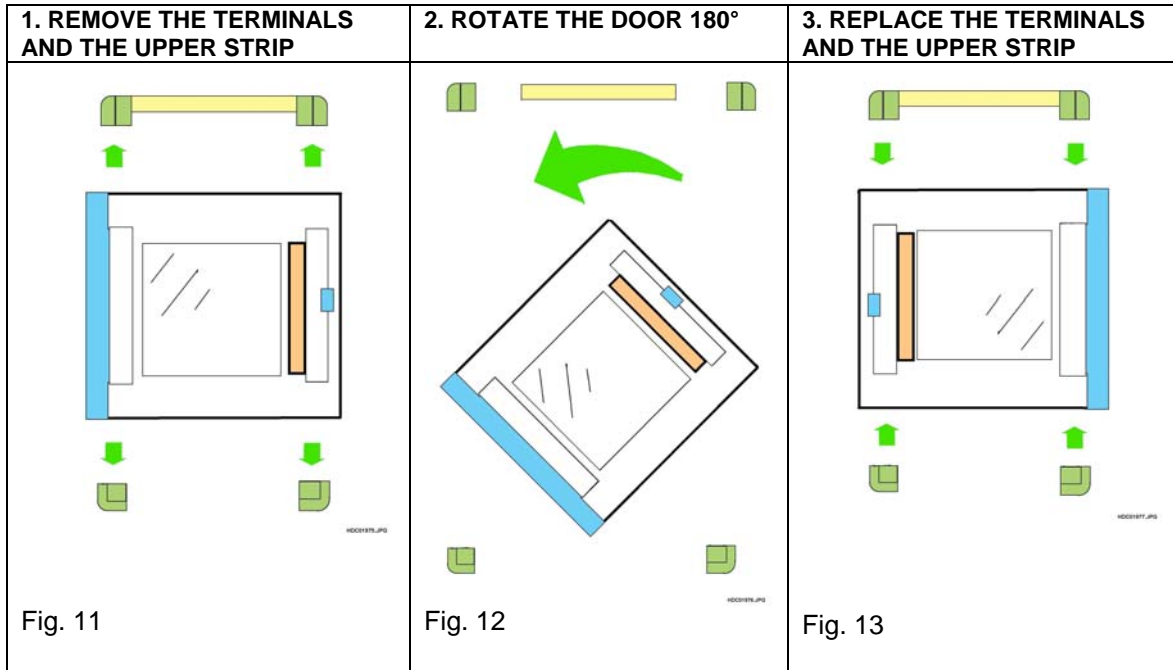

### 3.1.3 POSITION OF THE COMPONENTS ON A DOOR WITH APERTURE FROM LEFT TO RIGHT

Fig. 14

- 1 - UPPER TERMINAL SUPPORT (LEFT)
- 2 - UPPER STRIP
- 3 - UPPER TERMINAL SUPPORT (RIGHT)
- 4 - HINGE SUPPORT ASSEMBLY
- 5 - LOWER TERMINAL SUPPORT (RIGHT)
- 6 - LOWER TERMINAL SUPPORT (LEFT)
- 7 - LATCH
- 8 - DOOR KNOB

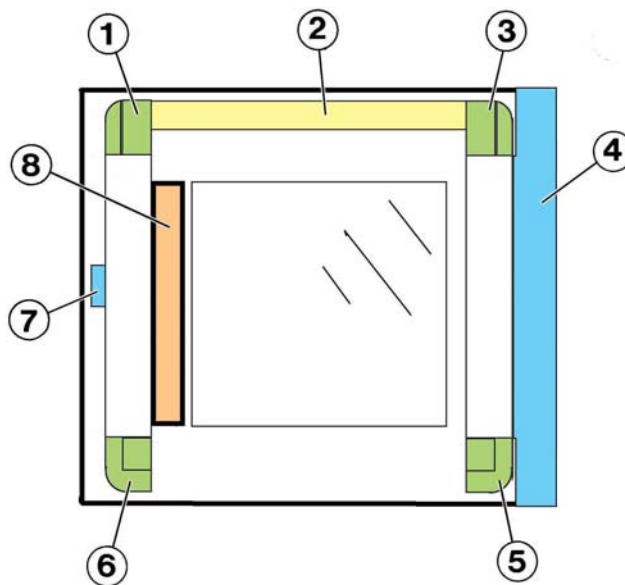

HDC01978.JPG

## 3.2 REMOVING THE TERMINAL SUPPORTS

### 3.2.1 REMOVING THE UPPER TERMINALS

Remove the upper terminals (a certain force is required to do this) (see Fig. 15).

Fig. 15

- 1 - UPPER TERMINAL SUPPORT (RIGHT)
- 2 - UPPER STRIP
- 3 - UPPER TERMINAL SUPPORT (LEFT)
- 4 - SUPPORT UPRIGHT FOR INNER GLASS DOOR

**NOTE:** The upper strip is inserted into the two upper terminals

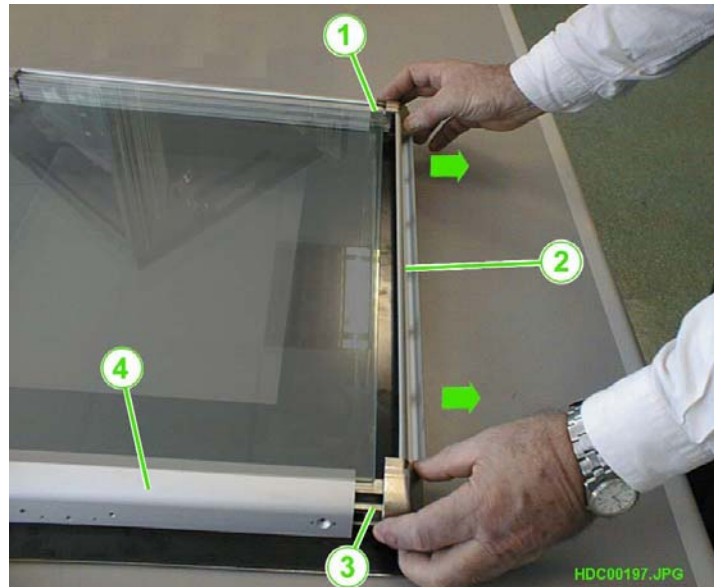

### 3.2.2 CLOSE-UP VIEW OF UPPER TERMINAL SUPPORT

Fig. 16

- 1 - TERMINAL
- 2 - SUPPORT UPRIGHT FOR INNER GLASS DOOR

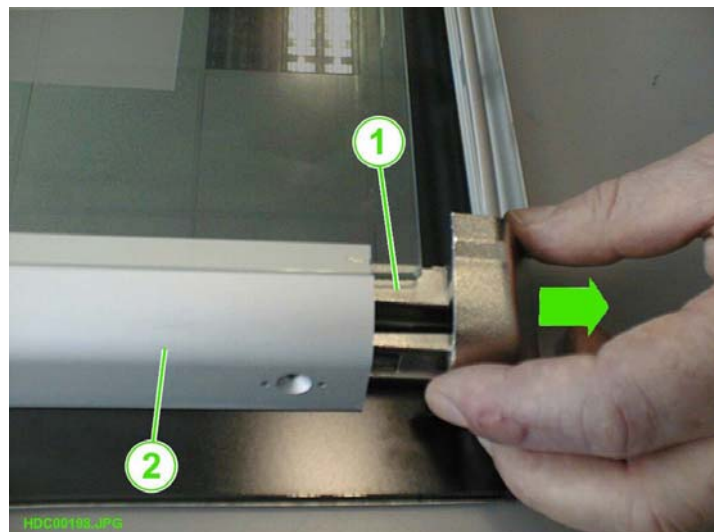

### 3.2.3 REMOVING THE INNER GLASS DOOR

After removing the terminals and the upper strip, it is possible to slide out the inner glass panel(s) (see Fig. 17).

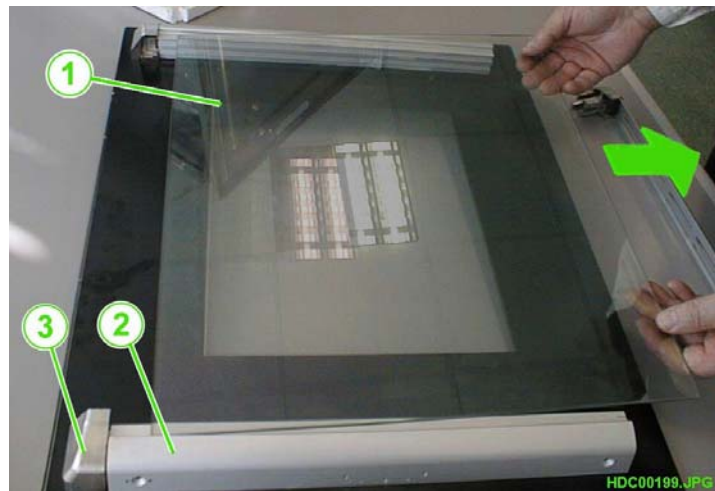

Fig. 17

- 1 - INNER GLASS DOOR
- 2 - SUPPORT UPRIGHT FOR INNER GLASS DOOR
- 3 - LOWER TERMINAL SUPPORT

### 3.2.4 REMOVING THE LOWER TERMINALS

To remove the lower terminal support (left), unscrew the external screw (see Fig. 18).

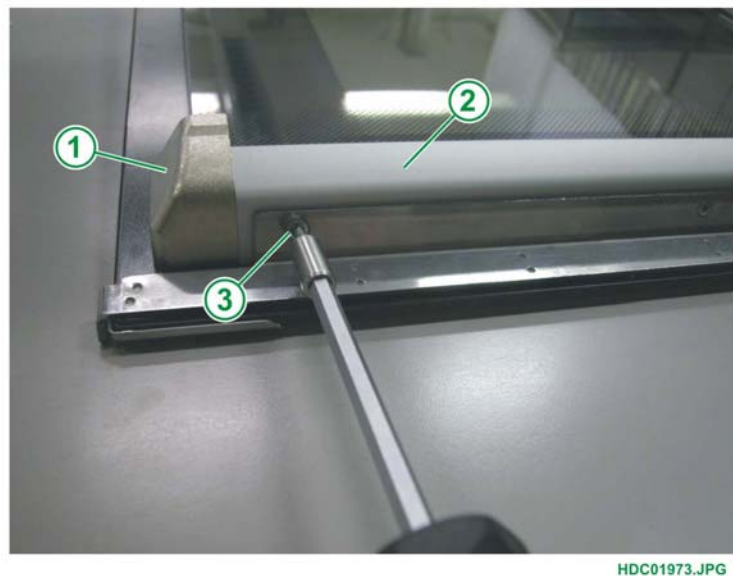
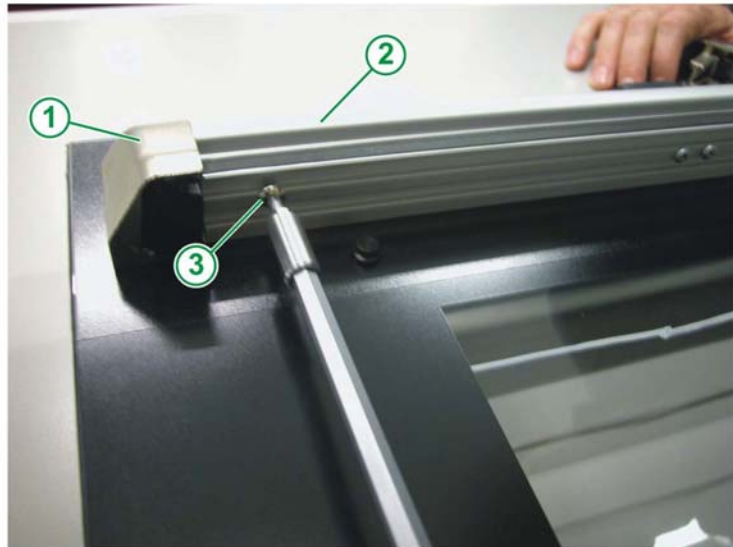

Fig. 18

- 1 - LOWER TERMINAL SUPPORT (LEFT)
- 2 - SUPPORT UPRIGHT FOR INNER GLASS DOOR
- 3 - EXTERNAL SCREW

After removing the inner glass panel(s), remove the screws which secure the lower terminal support (right) (see Fig. 19).



HDC01979.JPG

Fig. 19

- 1 - LOWER TERMINAL SUPPORT (LEFT)
- 2 - SUPPORT UPRIGHT FOR INNER GLASS DOOR
- 3 - INTERNAL SCREW

**ATTENTION :** From production week 39 of 2007 (serial no. 739XXXXX) to remove the left lower terminal it is not necessary to unscrew the external screw. Just unscrew the new screw inserted into the internal part as for the right lower terminal indicated in Fig. 19.

### 3.2.5 REMOVING THE LOWER TERMINALS

After removing the inner glass panel and the screws which secure the terminals, detach the lower terminals (a certain force is required for this) (see Fig. 20).

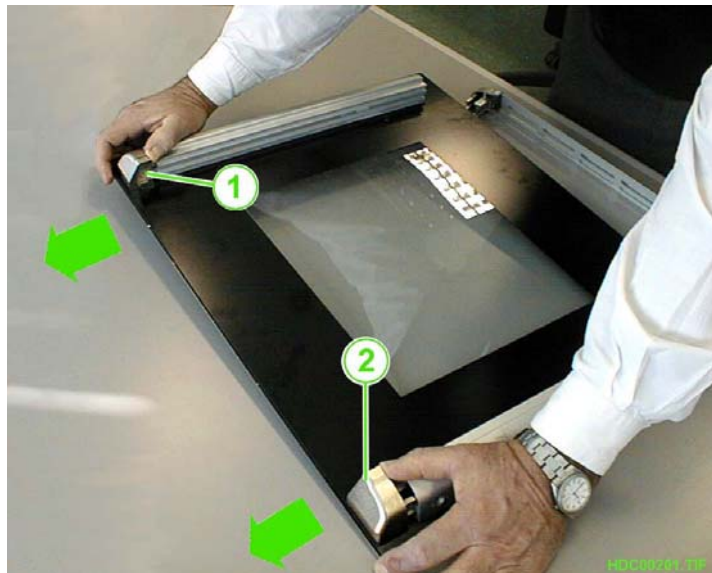

HDC00249.TIF

Fig. 20

- 1 - LOWER TERMINAL SUPPORT (LEFT)
- 2 - LOWER TERMINAL SUPPORT (RIGHT)

CLOSE-UP VIEW OF LOWER TERMINAL SUPPORT

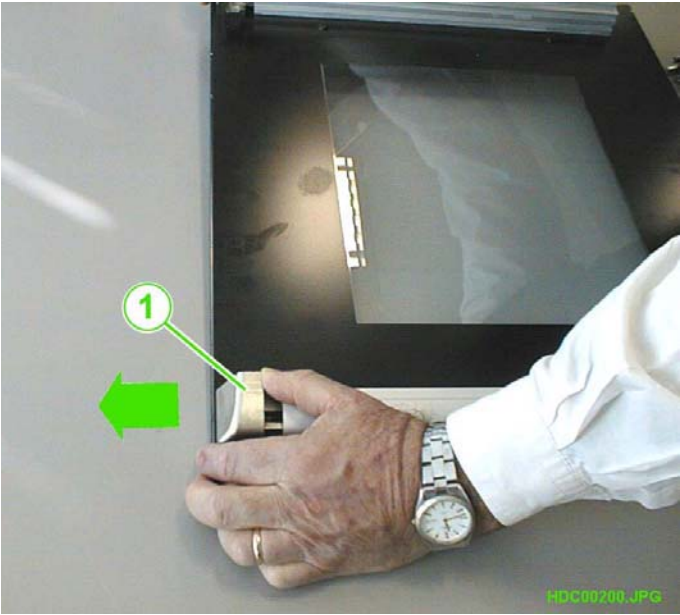

Fig. 21  
1 - LOWER TERMINAL SUPPORT

3.3 ROTATION OF THE DOOR WITH HINGE SUPPORT

Rotate the door + hinge support 180°.

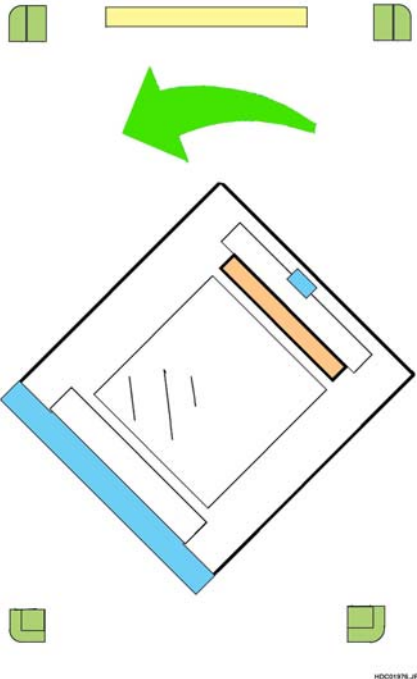

Fig. 22



### 3.4 REPLACING THE TERMINALS

#### 3.4.1 REMOVING THE HINGE SUPPORT SCREW

Before replacing the terminals, remove the external screw which secures the hinge support (see Fig. 23).

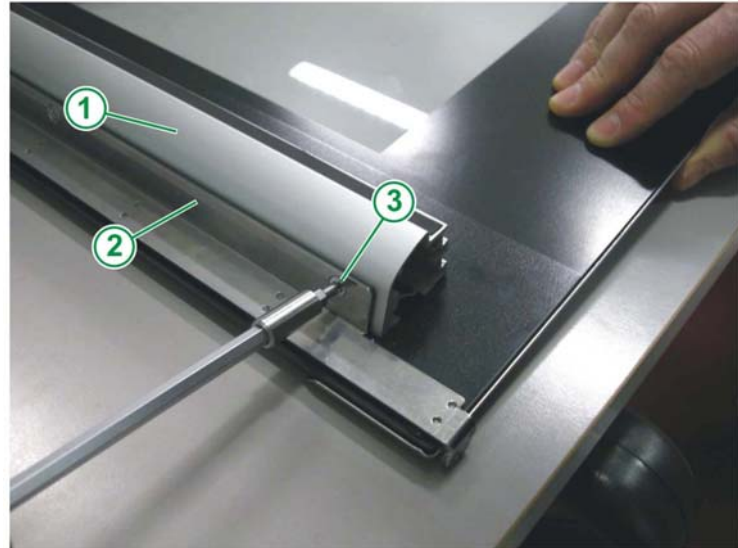

Fig. 23

- 1 - GLASS SUPPORT UPRIGHT
- 2 - HINGE SUPPORT
- 3 - SCREW FOR GLASS SUPPORT UPRIGHT

HDC01980.JPG

**ATTENTION :** From production week 39 of 2007 (serial no. 739XXXXX) to remove the left lower terminal it is not necessary to unscrew the external screw. Just insert the screw into the internal part as for the right lower terminal indicated in Fig. 19.

#### 3.4.2 REPLACING THE LOWER TERMINALS

Replace the lower terminals in the support uprights for the inner glass panels, in the new positions (see Fig. 24).



Fig. 24

- 1 - LOWER TERMINAL SUPPORT (LEFT)
- 2 - LOWER TERMINAL SUPPORT (RIGHT)

HDC01982.JPG



### 3.4.3 - CLOSE-UP VIEW OF SECURING THE LOWER TERMINALS

Secure the terminals as follows:

- The left-hand terminal with its screw.
- The right-hand terminal, together with the hinge upright, using the corresponding screws.

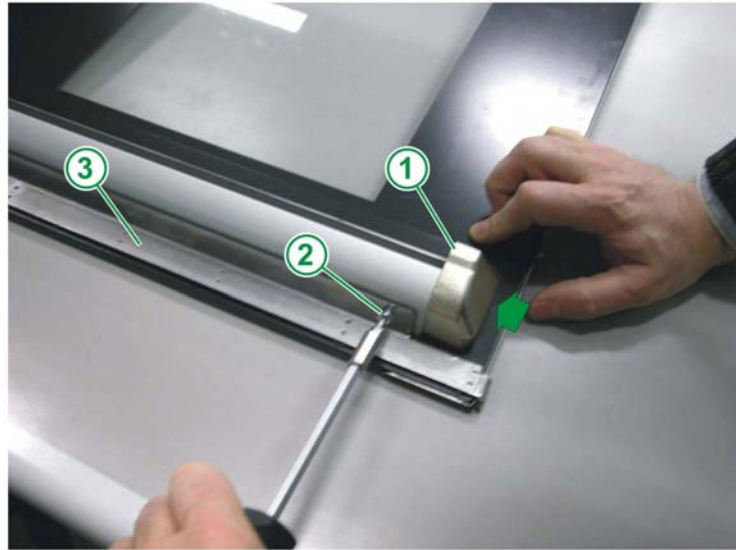

Fig. 25

- 1 - LOWER TERMINAL SUPPORT
- 2 - SCREW
- 3 - HINGE SUPPORT

HDC01983.JPG

**ATTENTION :** From production week 39 of 2007 (serial no. 739XXXXX) to remove the left lower terminal it is not necessary to unscrew the external screw. Just insert the screw into the internal part as for the right lower terminal indicated in Fig. 19.

### 3.4.4 REPLACING THE INNER GLASS DOOR

Replace the inner glass door (see Fig. 26).

Fig. 26

- 1 - INNER GLASS DOOR
- 2 - SUPPORT UPRIGHT FOR GLASS PANEL

**NOTE:** In the case of doors with three glass panels (two of which internal), care must be taken when replacing the panels. The silk-screened side must always face the exterior of the door. In the case of thermic glass doors without silk-screening, the thermic side is conductive and therefore must always face outwards (see "Athermic glass panels" in the manual describing accessibility – 599 38 11.05).

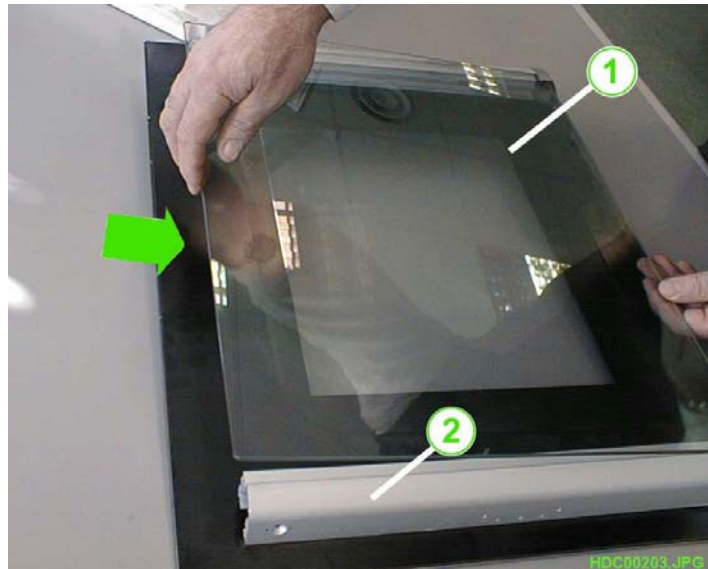

HDC00203.JPG

### 3.4.5 REPLACING THE UPPER TERMINALS AND PROFILE

Proceed as follows to replace the upper terminals and profile:

- Prepare the upper profile by inserting it into the upper terminals, then place in the correct position.
- Press the terminals until fully inserted (see Fig. 27).

Fig. 27

- 1 - UPPER TERMINAL SUPPORT (LEFT)
- 2 - UPPER STRIP
- 3 - UPPER TERMINAL SUPPORT (RIGHT)

**NOTE:** When positioning the upper terminals, ensure that the retaining spring and the rubber spacing element are correctly positioned (see Fig. 29 ).

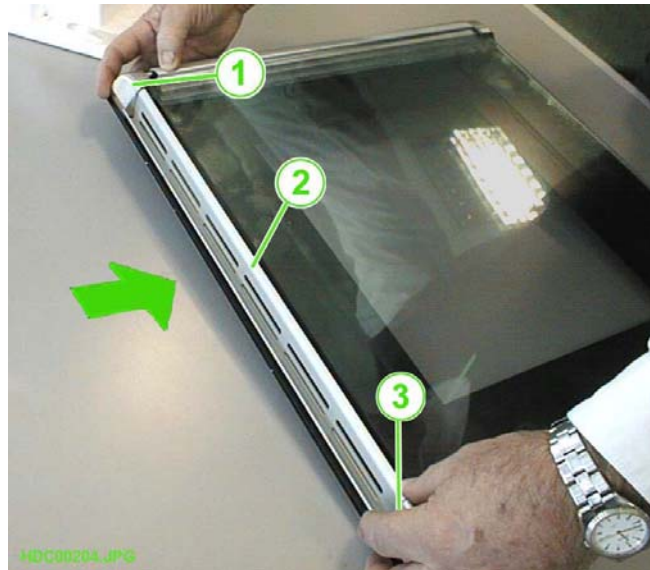

### 3.4.6 FITTING THE SPRINGS AND THE RUBBER SPACING ELEMENTS

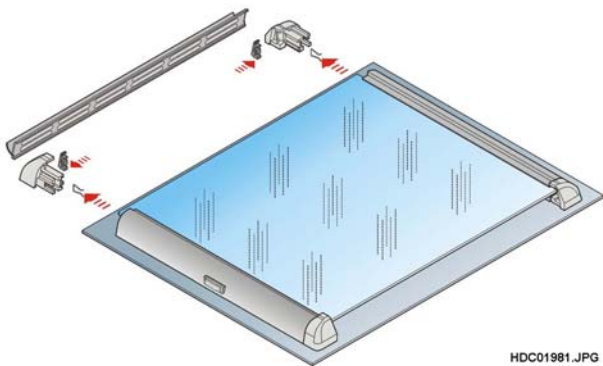

Fig. 28

**NOTE:** The springs are fitted to the upper terminals only; however, all four terminals feature the rubber spacing elements.

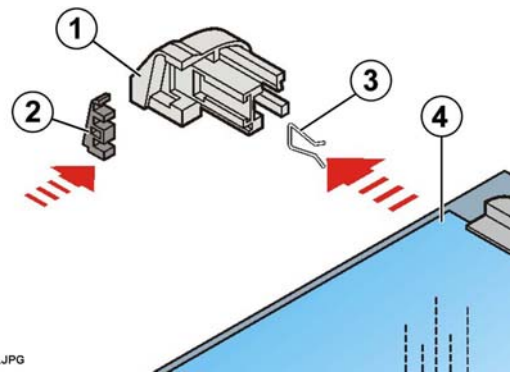

Fig. 29

- 1 - UPPER TERMINAL SUPPORT (LEFT)
- 2 - RUBBER SPACING ELEMENT
- 3 - RETAINING SPRING
- 4 - INNER GLASS PANEL

### 3.4.7 - DIFFERENCES BETWEEN TERMINALS

The lower terminals differ from the upper terminals in that they feature holes for the screws (see Fig. 30).

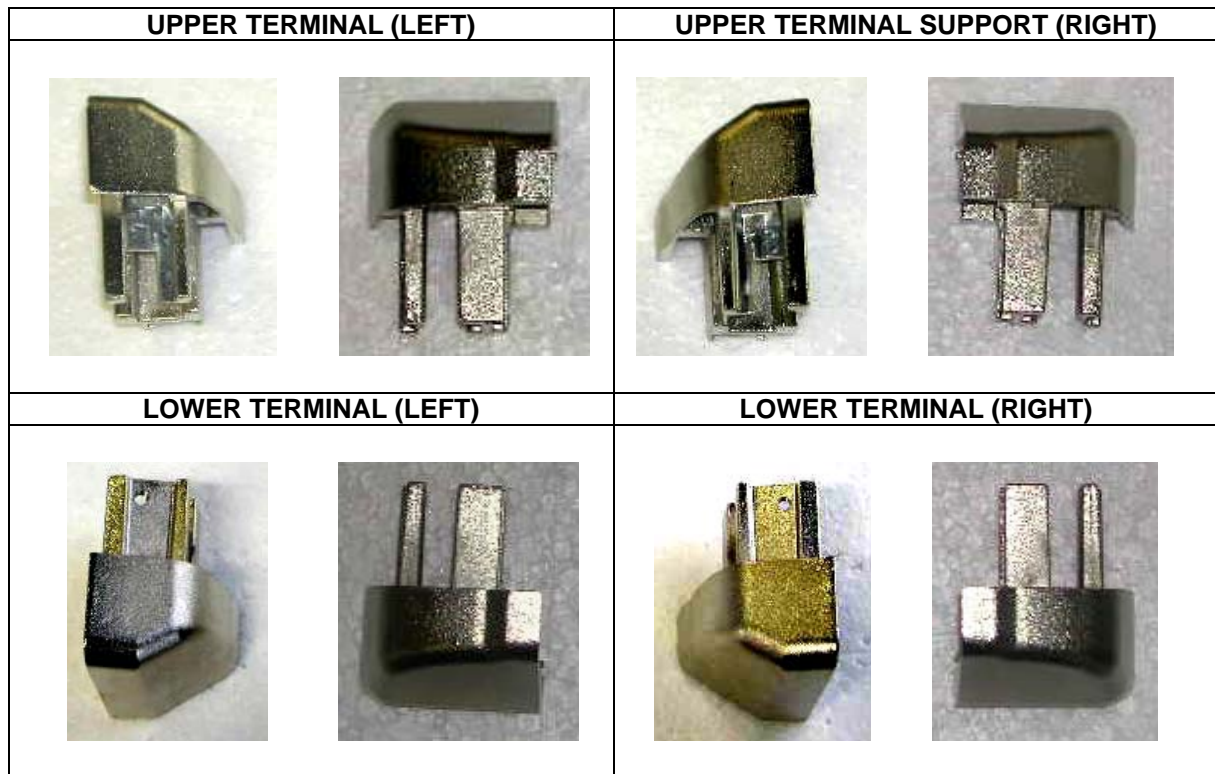

Fig. 30

## 4 REPLACING THE DOOR WITH LEFT-TO-RIGHT OPENING

### 4.1 REVERSAL OF APERTURE FROM LEFT TO RIGHT

#### 4.1.1 CLOSE-UP VIEW OF THE DOOR LATCH

Before replacing the door with aperture on the left, it is necessary to re-position the latch:

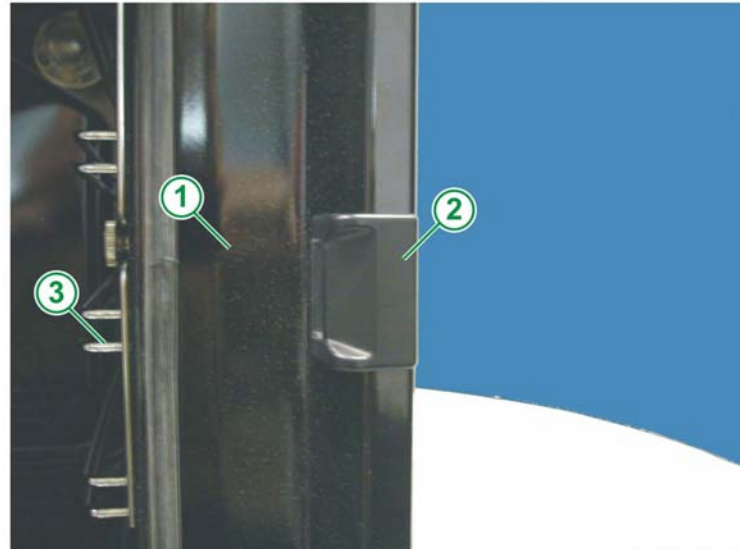

Fig. 31

- 1 - FRONT FRAME
- 2 - DOOR LATCH
- 3 - GRILL SUPPORT

HDC01984.JPG

#### 4.1.2 REMOVING THE DOOR LATCH

- Remove the door latch by removing the screws which secure it in position (see Fig. 32).



Fig. 32

- 1 - SUPPORT BRACKET FOR DOOR LATCH
- 2 - UPPER SCREW
- 3 - LOWER SCREW

HDC01985.JPG

Fig. 33

- 1 - DOOR LATCH
- 2 - SUPPORT BRACKET FOR DOOR LATCH



HDC01986.JPG

#### 4.1.3 REMOVING THE LATCH MASKING CAP

Before refitting the door latch on the opposite side, the masking cap must be removed. To do so, it is sufficient to use a flat-head (normal) screwdriver (see Fig. 34).

Fig. 34

- 1 - LATCH MASKING CAP
- 2 - STANDARD SCREWDRIVER
- 2 - FRONT FRAME

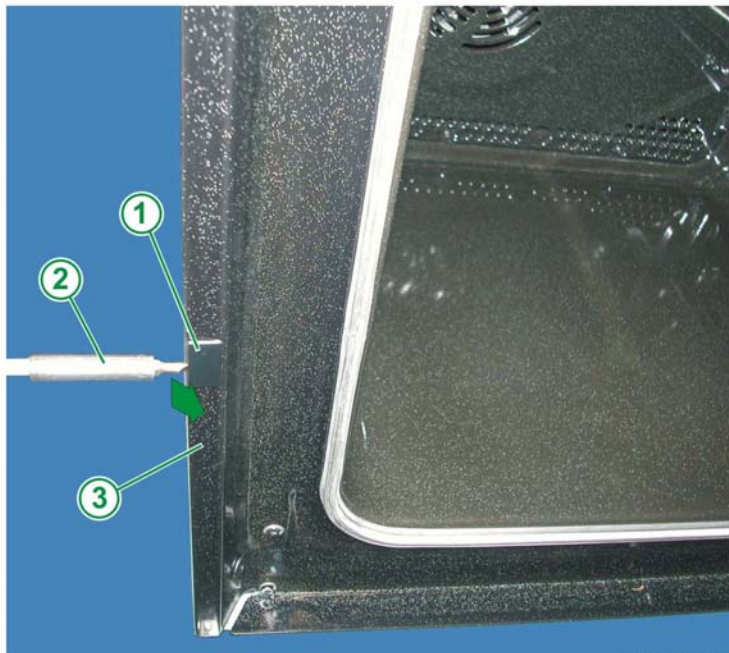

HDC02122.JPG



#### 4.1.4 REFITTING THE DOOR LATCH ON THE OPPOSITE SIDE

Position the door latch with its support bracket on the opposite side and secure using two screws (see Fig. 35 e 36).

Fig. 35

- 1 - LATCH
- 2 - SUPPORT BRACKET

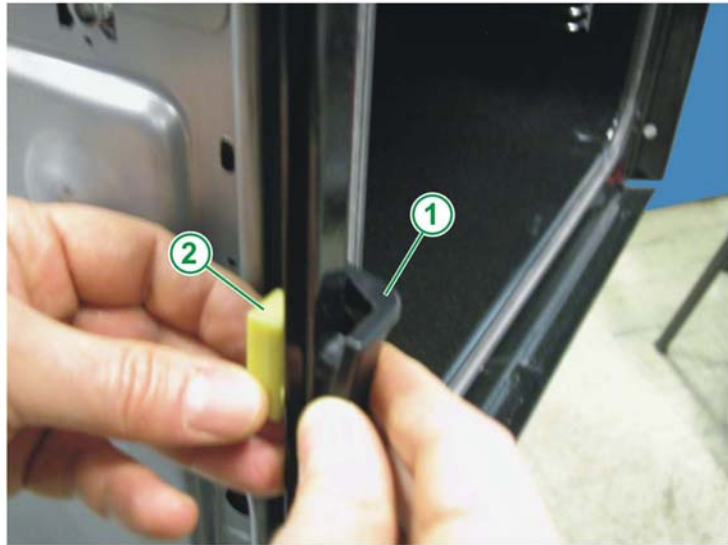

HDC01987.JPG

Fig. 36

- 1 - SUPPORT BRACKET FOR LATCH
- 2 - DOOR LATCH



HDC01988.JPG

**NOTE:** Remember to fit the masking cap on the side opposite to the door latch.

#### 4.1.5 - REMOVING THE LOWER HINGE

To remove the lower hinge simply remove the two screws which secure it in position (see Fig. 37).



Fig. 37

- 1 - UPPER HINGE SCREW
- 2 - LOWER HINGE SCREW
- 3 - LOWER HINGE

HDC01989.JPG

**NOTE :** Before removing the hinge support upright, it is necessary to remove the lower hinge.



## 4.2 REVERSING THE HINGE SUPPORT UPRIGHT

### 4.2.1 - REMOVING THE HINGE SUPPORT UPRIGHT

To remove the hinge support upright, remove the three upper screws (see Fig. 39) and the three lower screws (see Fig. 40).

Fig. 38

- 1 - HINGE SUPPORT UPRIGHT
- 2 - UPPER SCREWS
- 3 - LOWER SCREWS
- 4 - DOOR ALIGNMENT SCREW

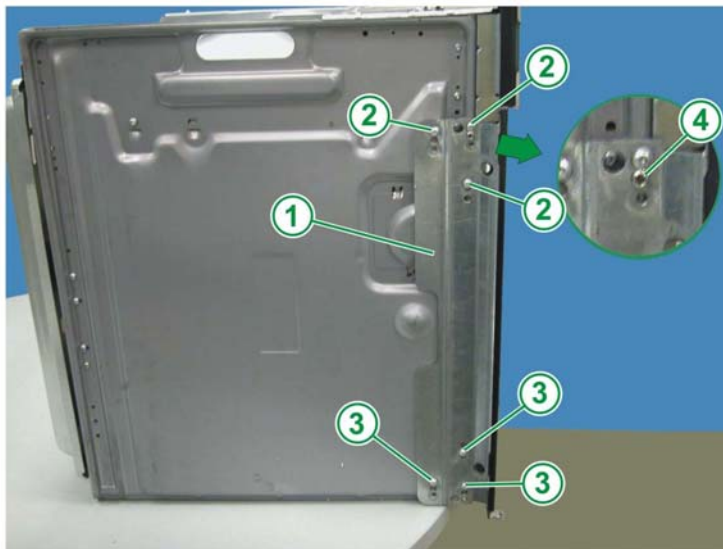

HDC01990.JPG

Fig. 39

- 1 - HINGE SUPPORT UPRIGHT
- 2 - REAR SCREW
- 3 - FRONT SCREW
- 4 - LOWER SCREW

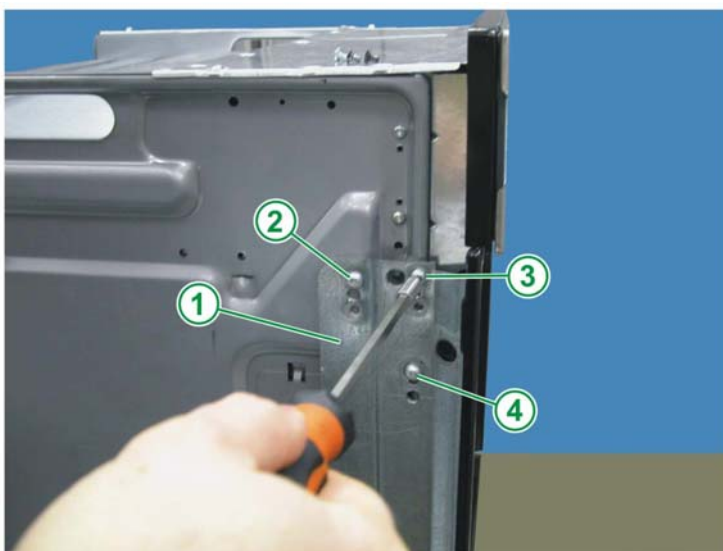

HDC01991.JPG

Fig. 40

- 1 - HINGE SUPPORT UPRIGHT
- 2 - REAR SCREW
- 3 - FRONT SCREW
- 4 - LOWER SCREW

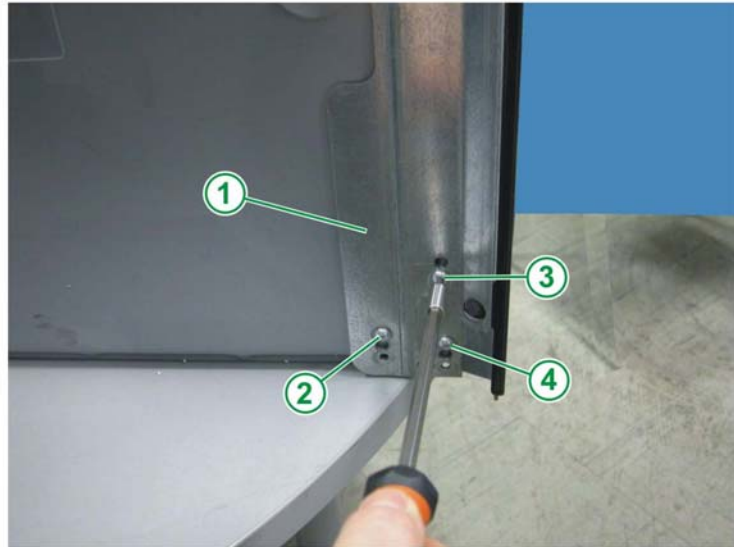

HDC01992.JPG

#### 4.2.2 - REPLACING THE HINGE SUPPORT UPRIGHT

To replace the hinge support upright, simply position it in alignment with the holes and secure using three screws in the upper section and three in the lower section.

Fig. 41

- 1 - HINGE SUPPORT UPRIGHT
- 2 - DOOR ALIGNMENT SCREW



HDC01994.JPG

**NOTE:** Before replacing the hinge support it is necessary to re-position the door alignment screw. This screw must always be positioned in the upper section of the upright (see Fig. 41 and 42).

#### 4.2.3 - REPLACING THE SCREWS IN THE UPPER SECTION OF THE HINGE SUPPORT UPRIGHT

Fig. 42

- 1 - FRONT SCREW
- 2 - POSITION OF REAR SCREW
- 3 - DOOR ALIGNMENT SCREW
- 4 - POSITION OF LOWER SCREW
- 5 - HINGE SUPPORT UPRIGHT

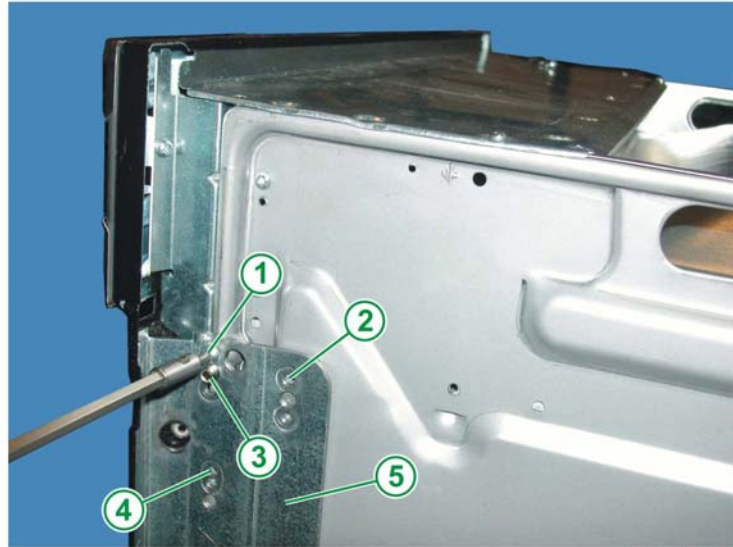

HDC03323.JPG

#### 4.2.4 - REPLACING THE SCREWS IN THE LOWER SECTION OF THE HINGE SUPPORT UPRIGHT

Fig. 43

- 1 - HINGE SUPPORT UPRIGHT
- 2 - REAR SCREW
- 3 - FRONT SCREW
- 4 - LOWER SCREW

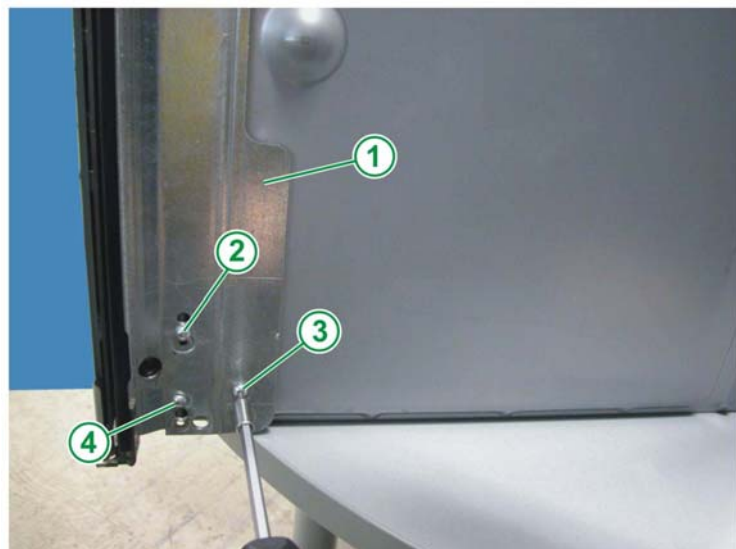

HDC01996.JPG

### 4.3 RE-POSITIONING THE HINGE

#### 4.3.1 RE-POSITIONING THE HINGE (FROM UPPER SECTION TO LOWER SECTION)

In order to secure the door to the right side, it is necessary to remove the upper hinge (which was originally in the upper section – see 2.2.1 "POSITION OF THE LATCH AND THE HINGE - page 6) and fit it in the lower right-hand position.



Fig. 44

#### 4.3.2 - REPLACING THE LOWER HINGE

To replace the lower hinge, simply position the hinge and secure using the two screws (see Fig. 45).

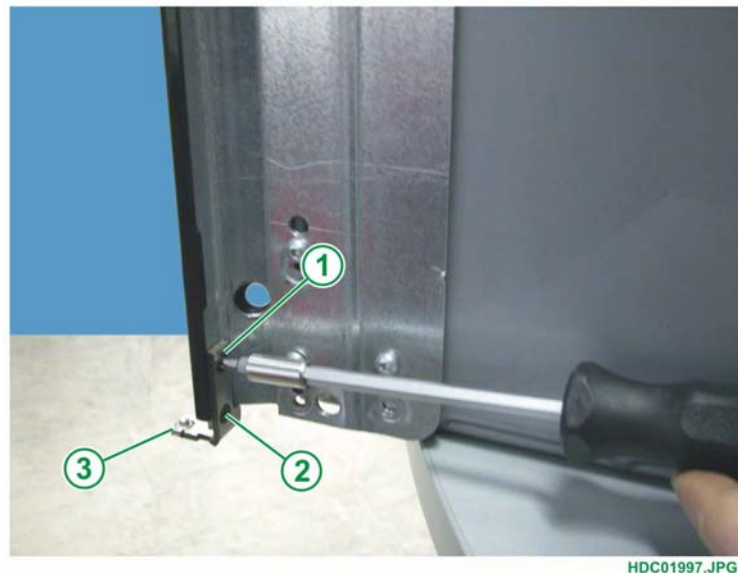

Fig. 45

- 1 - UPPER SCREW
- 2 - LOWER SCREW
- 3 - LOWER HINGE

### 4.3.3 REMOVING THE UPPER MASKING CAP

Before replacing the left-aperture door, it is necessary to re-position the upper masking cap. To do so, it is sufficient to use a flat-head (normal) screwdriver (see Fig. 46).

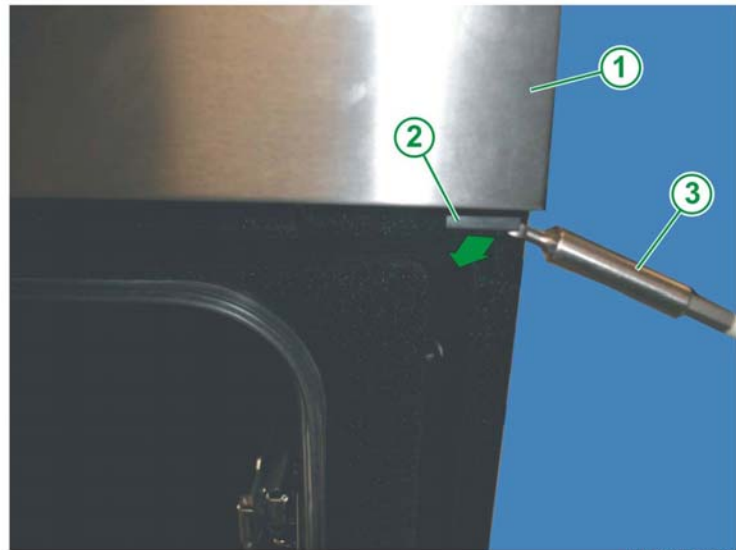

Fig. 46

- 1 - FRONT CONTROL PANEL
- 2 - MASKING CAP
- 3 - SCREWDRIVER

HDC02120.JPG

### 4.3.4 REPLACING THE UPPER MASKING CAP

To replace the upper masking cap, insert into the hole, first at the upper edge and then at the lower lip (see Fig. 47).

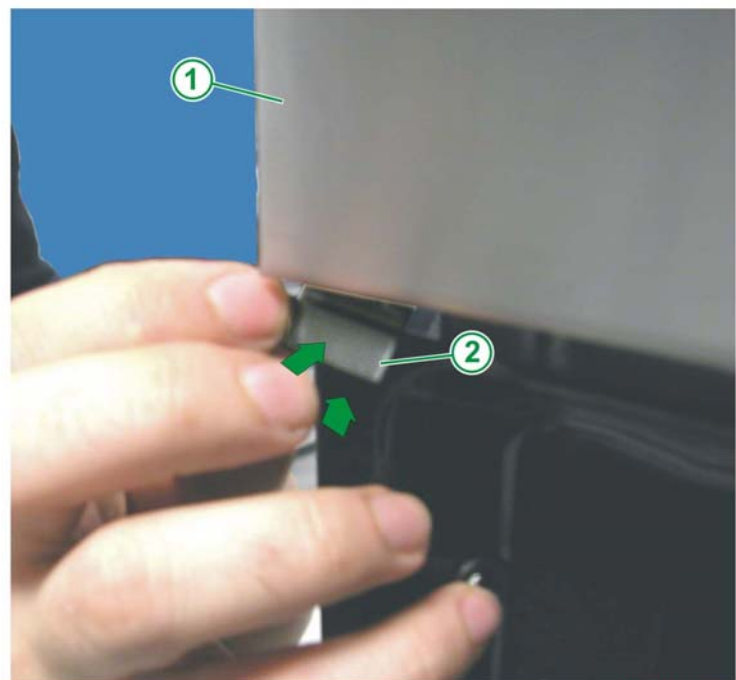

Fig. 47

- 1 - FRONT CONTROL PANEL
- 2 - MASKING CAP

HDC02121.JPG



## 4.4 REPLACING THE DOOR

### 4.4.1 RE-POSITIONING THE DOOR WITH APERTURE FROM RIGHT TO LEFT

Position the door, aligning the lower hinge pin with the hole in the hinge support (see Fig. 48).



Fig. 48

- 1 - OVEN DOOR
- 2 - LOWER HINGE

HDC01998.JPG

### 4.4.2 - RE-POSITIONING THE UPPER HINGE

Position the upper hinge while holding the door in position and align the lower hinge pin with the hole in the hinge support (see Fig. 49).

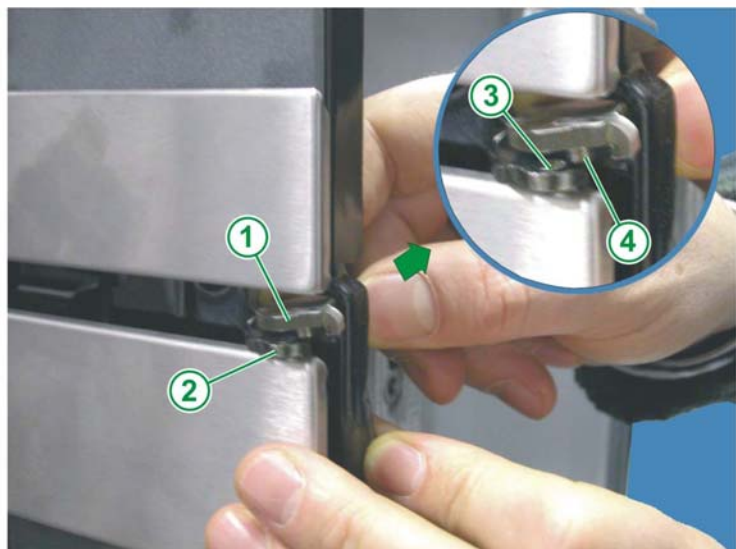

Fig. 49

- 1 - UPPER HINGE
- 2 - HINGE SUPPORT
- 3 - HOLE IN HINGE SUPPORT
- 2 - UPPER HINGE PIN

HDC01999.JPG

#### 4.4.3 SECURING THE UPPER HINGE

Secure the upper hinge using the two screws (see Fig. 50).

Fig. 50

- 1 - UPPER HINGE
- 2 - UPPER SCREW
- 3 - LOWER SCREW

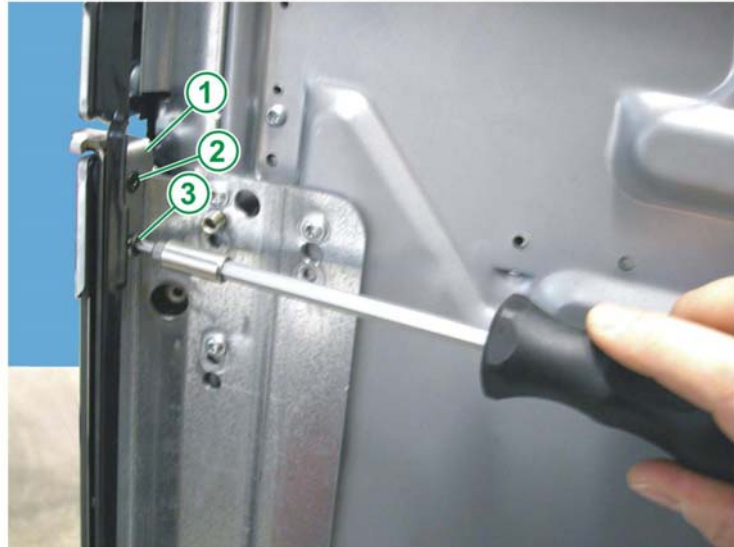

HDC02000.JPG

#### 4.4.4 FITTING THE FRONT CONTROL PANEL

Secure the control panel using the screw (see Fig. 51 and 52).

Fig. 51

- 1 - FRONT CONTROL PANEL
- 2 - SCREW

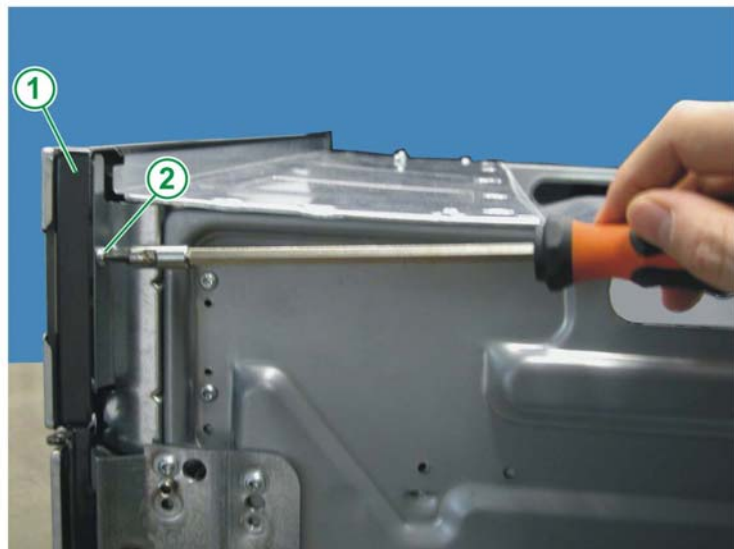

HDC02001.JPG



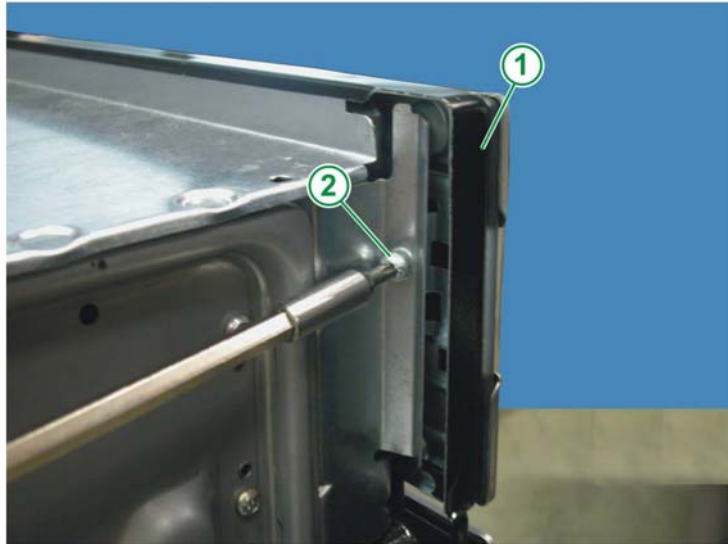

HDC02002.JPG

Fig. 52

- 1 - FRONT CONTROL PANEL
- 2 - SCREW

## 5 - ADJUSTING THE ALIGNMENT OF THE DOOR

To align the door with the control panel (see Fig. 53), once the oven has been extracted also partially, adjust the alignment screw (see Fig. 54 Pos.3) in the following sequence:

- 1 - Unscrew the two upper screws (see 5.1).
- 2 - Adjust the alignment screw (see Fig. 54 Pos. 1) so that the door is aligned with the front control panel (see 5.2) keeping the door open during the adjustment.
- 3 - Tighten the two upper screws (see Fig. 54 Pos. 1 and 2).



HDC03317.JPG

Fig. 53

## 5.1 - TIGHTENING THE SCREWS

Fig. 54

- 1 - UPPER SCREW (REAR)
- 2 - UPPER SCREW (FRONT)
- 3 - DOOR ALIGNMENT SCREW



## 5.2 - DOOR ALIGNMENT SCREW

Fig. 55

- 3 - DOOR ALIGNMENT SCREW
- 4 - DOOR OPEN

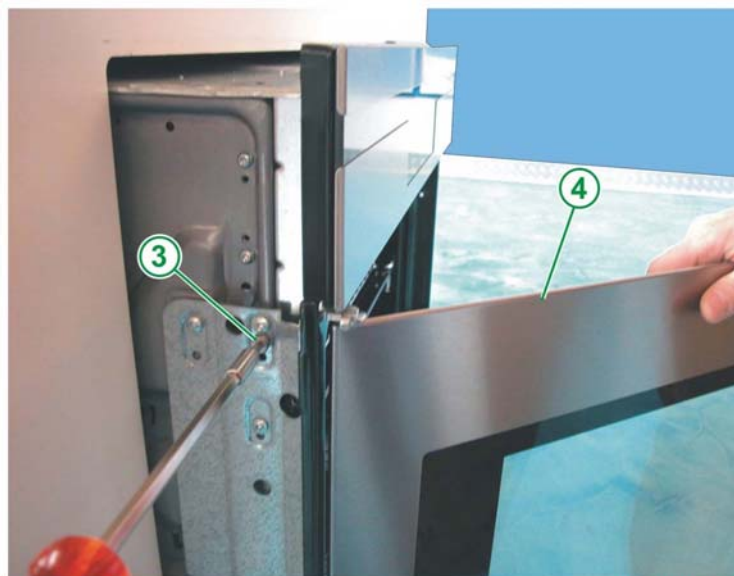



Fig. 56

Unscrewing the screw, the door lowers (see Fig.56 e 57).



Fig. 57

Tightening the screw, the door raises (see Fig. 56 e 58).



Fig. 58

**6 - REVISIONS**

<b>REVISION</b>	<b>DATE</b>	
01	02/2009	- Modified Chapter 5 – ADJUSTING THE ALIGNMENT OF THE DOOR page 30, 31 and 32.