

Items shown in this drawing must not contain substances that are banned according to Directive 2002/95/EC, the RoHS Directive (Lead, Cadmium, Mercury, Hexavalent Chromium, Polychlorinated Biphenyls (PCB), or Polybrominated Diphenyl Ethers (PBDE)), or substances classified as "banned" or "Restricted" according to the Electrolux Restricted Materials List.

This drawing contains confidential information and is the property of Electrolux, without whose permission it may not be reproduced, stored in a retrieval system or otherwise used and it is to be returned promptly upon request to the design owner, who is responsible for the drawing.

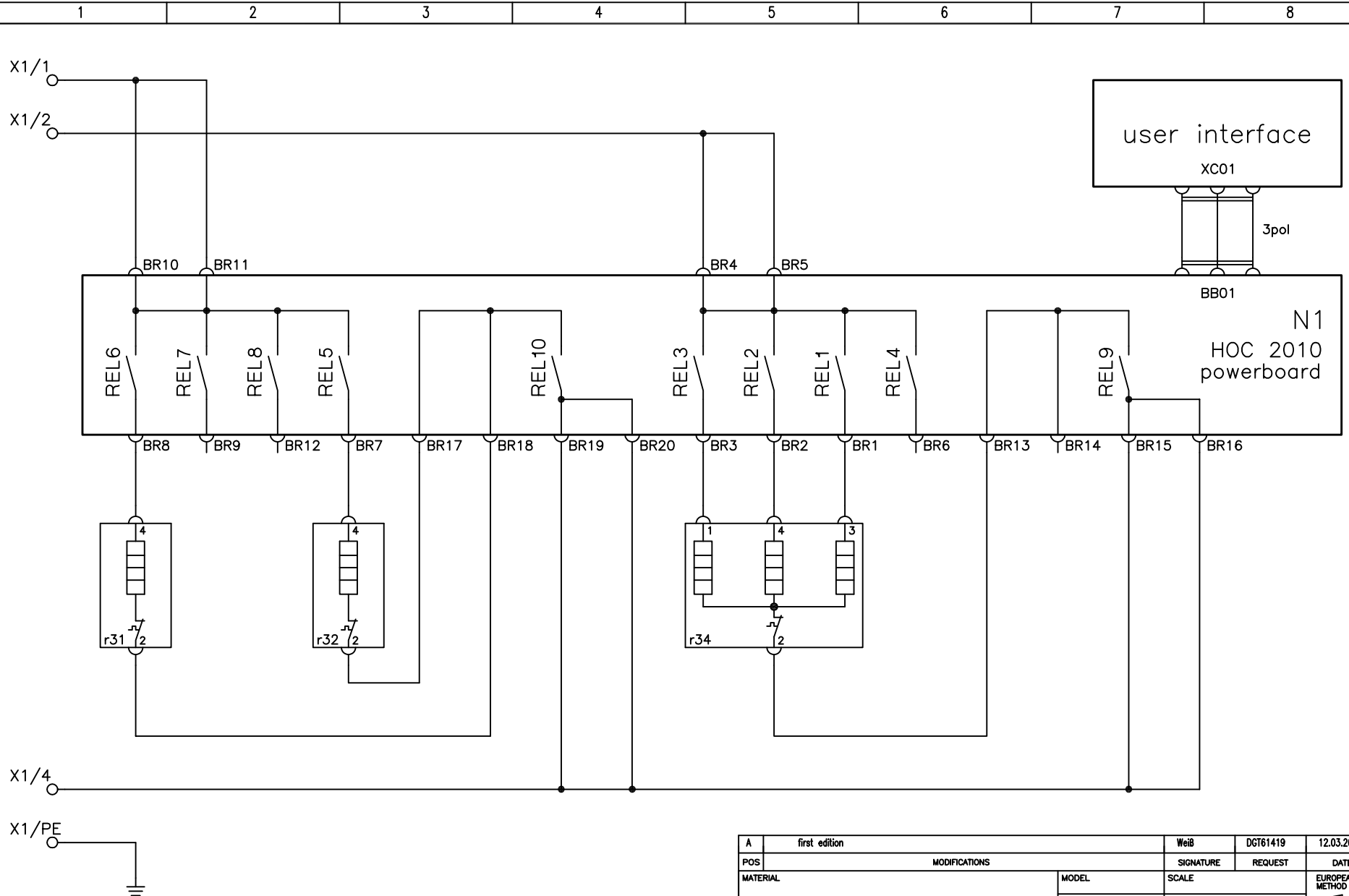

GENERAL TOLERANCES
 ANGLES
 LENGTHS AND DIAMETERS

387 6888 00						
VARIANT NUMBER.	REPLACED NUMBER	POS.	MODEL	DESIGN USERS	CHANGES FROM THE BASE NUMBER	

A		first edition		Weiß		DGT61419		12.03.2008							
POS				MODIFICATIONS				SIGNATURE		REQUEST		DATE			
MATERIAL						MODEL		SCALE		EUROPEAN METHOD					
TREATMENT						DESIGN USERS		REPLACES		No					
DESIGN OWNER						DRN		CHD		Weiß		2D ONLY			
DGT						DATE		12.02.2008		APPR		Weiß			
												CONCEPT 3D			
												EXACT 3D			
												DERIVED FROM			
												No			
												SUPPLY SPECIFICATIONS			
												No			
TITLE										circuit diagram					
										Schaltplan					
NUMBER										387 6888		REV		A	
												SHEET		1/1	

