

This drawing contains confidential information and is the property of Electrolux. Without whose permission it may not be copied, shown or handed to a third party or otherwise used and it is to be returned promptly upon request to the design owner, who is responsible for the drawing.

Items shown in this drawing must not contain substances that are banned according to Directive, 2002/95/EC, the RoHS Directive (Lead, Cadmium, Mercury, hexavalent Chromium, PBB and PBDE), or substances classified as "Banned" or "Restricted", according to the Electrolux Restricted Materials List.

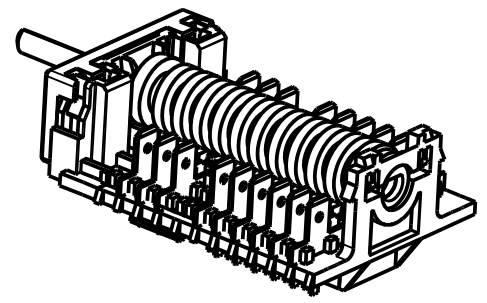

T-marked: T150
 Current/Voltage: 16(6)A/250V
 10(2)A/400V
 Operating torque: Min 20Ncm
 Max 45Ncm
 Type designation: 11HE/131

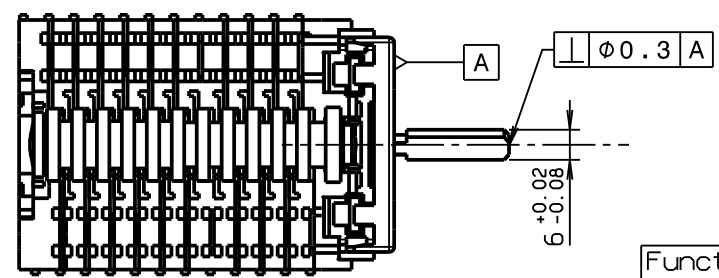
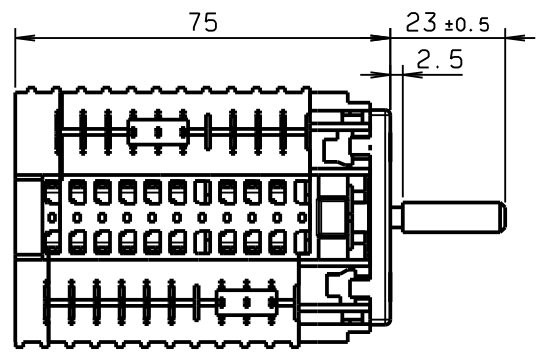
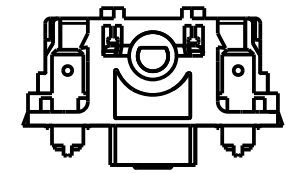

① NOTE:
 Detent spring Fe 621

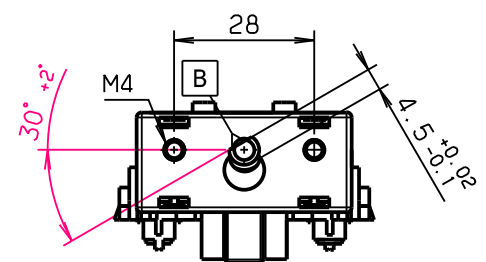

Shaft in 0-position
 Angle deviation Max ±2° for plane B
 in relation to ϕ for 2 hole M4

Function	1a	2a	3a	4a	5a	6a	7a	8a	9a	10a	11a	Angle
	Connected to each other											
0 off	0	0	0	0	0	0	0	0	0	0	0	0
1 off	0	0	0	0	0	0	0	0	X	X	X	30°
2 Top & Bottom	0	X	0	X	0	X	X	X	X	X	X	85°
3 Browning	0	0	X	X	0	X	X	X	X	X	0	140°
4 Max Grill	0	X	X	0	0	X	X	X	X	X	0	195°
5 Bottom	0	0	0	X	0	X	X	X	X	X	X	250°
6 Oven Light	0	0	0	0	0	X	X	0	X	X	X	305°
	1	2	3	4	5	6	7	8	9	10	11	

I Insert NOTE: Detent spring Fe 621				IAN	ABS 5223	2007-04-11
MODIFICATIONS				SIGNATURE	REQUEST	DATE
MATERIAL			MODEL	SCALE		EUROPEAN METHOD
TREATMENT			DESIGN USERS	1:1		
WEIGHT			REPLACES		DERIVED FROM	
DESIGN OWNER			SUPPLY SPECIFICATIONS			
DRM	IAN	CHD	2D ONLY			
DATE 2006-02-08	APPR	CONCEPT 3D	EXACT 3D	TITLE		
				Oven switch		
				6 pos		
				NUMBER		
				349 4533		
				REV	I	
				SHEET		



349 4533-01	-	-	-	-	-
VARIANT NUMBER	REPLACED NUMBER	POS.	MODEL	DESIGN USERS	CHANGES FROM THE BASE NUMBER